

HARGROVE, PESNELL & WYATT

(A PROFESSIONAL LAW CORPORATION)
AMERICAN TOWER, SUITE 600
401 MARKET STREET

SHREVEPORT, LOUISIANA 71101-3239

THOMAS J. WYATT (1942-1996)

MAILING ADDRESS
POST OFFICE BOX 59
SHREVEPORT, LOUISIANA 71161-0059
TELEPHONE (318) 429-7200
TELECOPIER (318) 429-7201

BILLY R. PESNELL
JOSEPH L. HARGROVE, JR.
DAVID L. SMELLEY
PAUL A. STRICKLAND
SCOTT C. SINCLAIR
W. BROOKS MAY
JASON C. FALUDI

OF COUNSEL
WILLIAM G. CONLY

November 12, 2002

Honorable James H. Welsh
Commissioner of Conservation
State of Louisiana
Post Office Box 44275
Baton Rouge, Louisiana 70804-4275

Re: APPLICATION FOR PUBLIC HEARING

Robulus L Zone, Reservoir B, RAMOS FIELD,
Assumption and St. Mary Parishes, Louisiana.

Dear Sir:

BURLINGTON RESOURCES OIL & GAS COMPANY, L.P. ("Applicant"), hereby respectfully applies for a public hearing to consider evidence relative to the issuance of an Order pertaining to the following matters relating to the Robulus L Zone, Reservoir B, in the Ramos Field, Assumption and St. Mary Parishes, Louisiana:

1. To establish rules and regulations governing the exploration for and production of gas and condensate from the Robulus L Zone, Reservoir B.
2. To create a single geographical drilling and production unit for the exploration for and production of gas and condensate from the Robulus L Zone, Reservoir B, such unit being shown on the attached plat and being designated ROB L RB SUA.
3. To force pool and integrate all separately owned tracts, mineral leases and other property interests within the proposed unit with each separate tract sharing in unit production on a surface acreage basis of participation.
4. To designate a unit operator of, and unit well for, the proposed unit as may be appropriate.
5. To provide that future wells drilled to the Robulus L Zone within or outside of the proposed unit be located in accordance with the well location provisions of Statewide Order No. 29-E.
6. To provide that the Commissioner of Conservation should be authorized to reclassify the Robulus L Zone, Reservoir B, by Supplemental Order and without the necessity of a public hearing should such a reclassification be warranted based on evidence furnished to the Commissioner.
7. To define the Robulus L Zone, Reservoir B, as that interval encountered between the measured depths of 14,975' and 15,580' in the Sohio Petroleum Company--C. M. Thibodeaux No. 1 Well, located in Section 26, Township 16 South, Range 13 East, Assumption Parish, Louisiana.
8. To consider such other matters as may be pertinent.

Honorable James H. Welsh
November 12, 2002
Page 2

Pertinent data concerning this application is available for inspection at the offices of Leon E. Comeaux & Associates, 305 LaRue France, Lafayette, Louisiana 70508. Any person wishing to inspect such data should call Mr. David Comeaux at (337) 233-9839 during normal business hours in order to arrange a date and time for such inspection. A copy of any of such pertinent data can be obtained at the expense of the requesting party.

By letter dated October 29, 2002, Applicant gave notice, in accordance with the Revised Rules of Procedure, of its intention to apply for a public hearing concerning these proposals and set November 18, 2002, as the tentative date for the pre-application conference. No request for the pre-application conference was received; accordingly, no pre-application conference was held.

Pursuant to the Revised Rules of Procedure, Applicant has made a reasonable effort to obtain the names and addresses of all Interested Owners, Represented Parties and Interested Parties to whom notice of this application is being sent and has attached hereto a list of the names and addresses of such parties. A copy of the unit plat (which is identical to the unit plat attached to the pre-application notice) is enclosed herewith, and a copy of this letter and of the attached plat is being sent to the District Manager of the Lafayette District of the Office of Conservation and to each of the Interested Owners, Represented Parties and Interested Parties as shown on the attached list.

Applicant will provide for posting of a copy of the Legal Notice of this hearing, and of the enclosed plat, at a prominent place in the area affected and will cause publication of the Legal Notice in a newspaper published in the general area of Ramos Field, all in accordance with the Revised Rules of Procedure. Furthermore, Applicant will mail a copy of the Legal Notice to all Interested Owners, Represented Parties and Interested Parties promptly upon receipt of the Legal Notice from the Commissioner.

Finally, enclosed herewith is our check payable to the Office of Conservation covering the application fee.

Yours very truly,

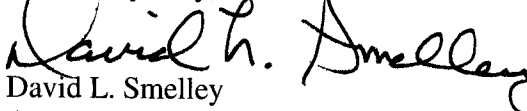

David L. Smelley

-- Attorney for Burlington Resources Oil & Gas Company, L.P.

DLS:dp

Enclosures

cc: Mr. Richard Hudson (w/encls.)
Mr. Mark Carlisle (w/encls.)
Mr. David Comeaux (w/encls.)
Mr. Michael J. Broussard (w/encls.)
Interested Owners, Represented Parties
and Interested Parties (w/plat only)

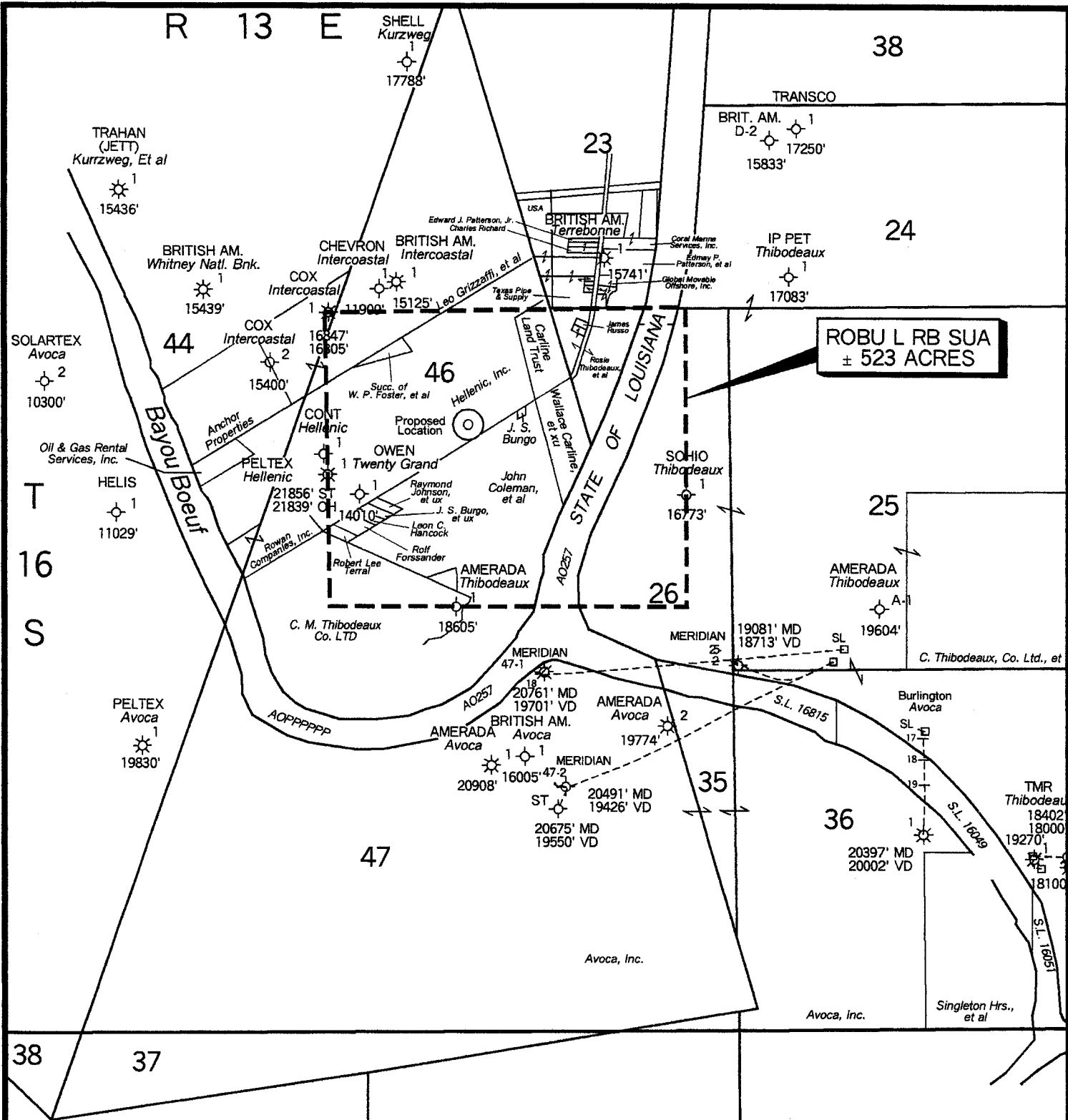

NOTE: ALL BOUNDARIES ARE GEOGRAPHIC

EXHIBIT NO.	DOCKET NO.
BURLINGTON RESOURCES GULF COAST DIVISION	
RAMOS FIELD ASSUMPTION & ST. MARY PARISHES, LOUISIANA	
PROPOSED UNIT ROBULUS L ZONE Geology by: David Comeaux	
DATE:	
LEON E. COMEAUX & ASSOC. GEOLOGISTS	