

TRACT 43072 - Cameron Parish, Louisiana

A portion of all State owned lands, including high and marsh lands and land now or formerly constituting the beds and bottoms of any water body, within the boundaries of the Rockefeller Wildlife Refuge and Game Preserve, not presently under mineral lease by the State of Louisiana on February 13, 2013, situated in Cameron Parish, Louisiana, and described as follows: Beginning at a point on the Southern boundary of State Lease No. 20576 having Coordinates of X = 1,542,093.00 and Y = 369,820.00; thence East 9,002.00 feet along the boundary of said State Lease No. 20576 to its Southeast corner also being the Southwest corner of State Lease No. 20573 having Coordinates of X = 1,551,095.00 and Y = 369,820.00; thence East 5,300.00 feet along the boundary of said State Lease No. 20573 to its Southeast corner having Coordinates of X = 1,556,395.00 and Y = 369,820.00; thence East 3,756.09 feet to a point on the boundary of State Lease No. 2340, as amended having Coordinates of X = 1,560,151.09 and Y = 369,820.00; thence along the boundary of said State Lease No. 2340 the following courses and distances: Southwesterly along an arc having a radius of 5,400.00 feet, Southwesterly along an arc having a radius of 3,700.00 feet, South 31 degrees 01 minutes 07 seconds West 899.57 feet, South 45 degrees 29 minutes 54 seconds West 597.90 feet, South 30 degrees 24 minutes 40 seconds West 800.08 feet, South 20 degrees 28 minutes 20 seconds West 800.56 feet, South 10 degrees 27 minutes 55 seconds West 798.28 feet, South 05 degrees 23 minutes 22 seconds West 798.53 feet and South 01 degrees 04 minutes 27 seconds West 308.03 feet to a point having Coordinates of X = 1,553,649.23 and Y = 362,012.00; thence West 11,556.23 feet to a point having Coordinates of X = 1,542,093.00 and Y = 362,012.00; thence North 7,808.00 feet to the point of beginning, containing approximately **2,495 acres**, all as more particularly outlined on a plat on file in the Office of Mineral Resources, Department of Natural Resources. All bearings, distances and coordinates are based on Louisiana Coordinate System of 1927, (South Zone).

NOTE: The above description of the Tract nominated for lease has been provided and corrected, where required, exclusively by the nomination party. Any mineral lease selected from this Tract and awarded by the Louisiana State Mineral and Energy Board shall be without warranty of any kind, either express, implied, or statutory, including, but not limited to, the implied warranties of merchantability and fitness for a particular purpose. Should the mineral lease awarded by the Louisiana State Mineral and Energy Board be subsequently modified, cancelled or abrogated due to the existence of conflicting leases, operating agreements, private claims or other future obligations or conditions which may affect all or any portion of the leased Tract, it shall not relieve the Lessee of the obligation to pay any bonus due thereon to the Louisiana State Mineral and Energy Board, nor shall the Louisiana State Mineral and Energy Board be obligated to refund any consideration paid by the Lessor prior to such modification, cancellation, or abrogation, including, but not limited to, bonuses, rentals and royalties.

NOTE: This tract is located in the Rockefeller Wildlife Refuge and Game Preserve Area under the jurisdiction of the Louisiana Department of Wildlife and Fisheries which has promulgated rules and regulations for the protection of game and wildlife on the aforesaid Tract and, therefore, shall be subject to said rules and regulations, a copy of which shall be attached to the mineral leases. In addition to the specific rules and regulations applicable, the following shall apply regarding operations under this mineral lease:

- Compliance with the Rockefeller mineral regulations shall be required.
- No surface activities will be allowed in the vicinity of the Headquarters and associated facilities without written authorization from the Department.
- Board road access will be required when feasible as determined by the Department.
- In the event that board road access is not feasible, existing canals and waterways will be utilized to access proposed well locations. A maximum of 350 feet of new canal dredging will be allowed for individual well locations.
- Compensatory mitigation will be required for unavoidable wetland losses.
- No charges will be allowed, including produced waters and drilling fluids. A containerized closed loop system will be required.
- Seasonal restrictions may be imposed within specific management units dependent upon wildlife population levels.
- A minimum bonus of \$350.00 per acre and a minimum royalty of 25% will be required.
- All spoil materials generated during dredging operations shall be placed at sites determined by the Department, additionally, the Department shall have discretion to require the user of a hydraulic dredge or spray dredge.
- Prior to submitting application for wetland permits to Federal and State permitting agencies the leaseholder shall coordinate project details with the Department of Wildlife and Fisheries. Contact person for the Department will be Mike Windham at (504)284-5268.

NOTE: The State of Louisiana does hereby reserve, and this lease shall be subject to, the imprescriptible right of surface use in the nature of a servitude in favor of the Department of Natural Resources, including its Offices and Commissions, for the sole purpose of implementing, constructing, servicing and maintaining approved coastal zone management and/or restoration projects. Utilization of any and all rights derived under this lease by the mineral lessee, its agents, successors or assigns, shall not interfere with nor hinder the reasonable surface use by the

Department of Natural Resources, its Offices or Commissions, as herein above reserved.

Applicant: PATRICK L. DONOHUE PETROLEUM PROPERTIES, INC.

Bidder	Cash Payment	Price/Acre	Rental	Oil	Gas	Other

13020038

Wildlife

Active Lease

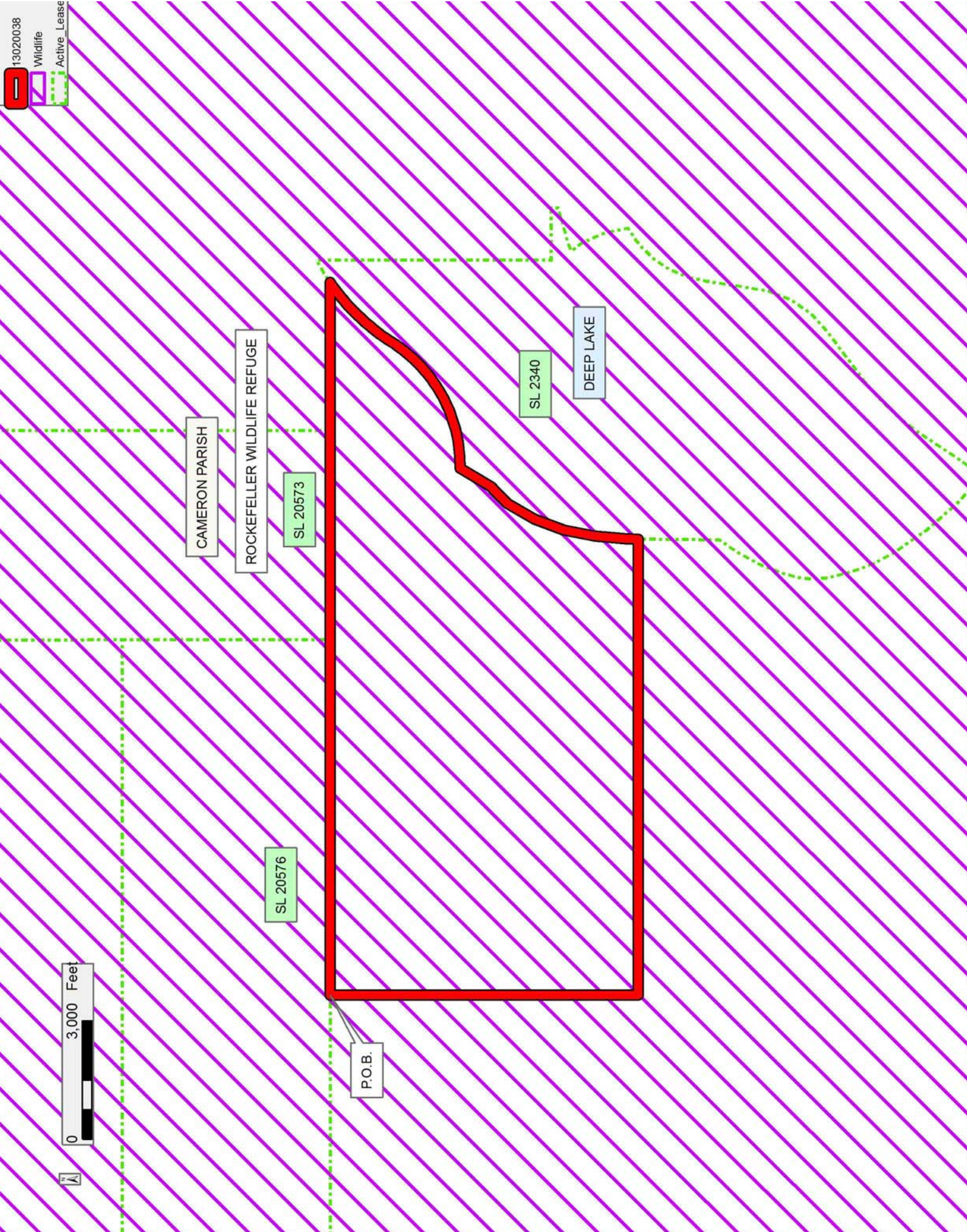

TRACT 43073 - Cameron Parish, Louisiana

A portion of all State owned lands, including high and marsh lands and land now or formerly constituting the beds and bottoms of any water body, within the boundaries of the Rockefeller Wildlife Refuge and Game Preserve, not presently under mineral lease by the State of Louisiana on February 13, 2013, situated in Cameron Parish, Louisiana, and described as follows: Beginning at a point having Coordinates of X = 1,567,904.12 and Y = 354,851.25; thence Northerly approximately 4,019 feet to the Southwest corner of Section 16, Township 16 South, Range 3 West; thence along the boundary of said Section 16 the following courses and distances: Easterly approximately 5,904 feet and Northerly approximately 5,280 feet to its Northeast corner and a point on the Southern boundary of State Lease No. 2038, as amended; thence South 89 degrees 16 minutes 36 seconds East approximately 674 feet along the boundary of said State Lease No. 2038 to its Southernmost Southeast corner; thence Easterly approximately 5,243 feet to a point having Coordinates of X = 1,579,849.35 and Y = 364,000.14; thence South 01 degrees 27 minutes 06 seconds West 3,572.28 feet to the Northwest corner of State Lease No. 20955 having Coordinates of X = 1,579,758.84 and Y = 360,429.00; thence South 1,897.81 feet along the boundary of said State Lease No. 20955 to its Southwest corner, also being a point on the North boundary of State Lease No. 20956 having Coordinates of X = 1,579,758.84 and Y = 358,531.19; thence along the boundary of said State Lease No. 20956 the following courses and distances: South 89 degrees 59 minutes 58 seconds West 4.25 feet to a point having Coordinates of X = 1,579,754.59 and Y = 358,531.19 and South 00 degrees 51 minutes 28 seconds West 3,680.56 feet to a point having Coordinates of X = 1,579,699.49 and Y = 354,851.04; thence North 89 degrees 59 minutes 57 seconds West 11,795.38 feet to the point of beginning, **LESS AND EXCEPT** any right, title, and interest in lands owned by and not under lease from the State of Louisiana, on behalf of the Cameron Parish School Board, situated in Section 16, Township 16 South, Range 03 West, Cameron Parish, Louisiana, contained within the above described tract, containing approximately **1,783 acres**, all as more particularly outlined on a plat on file in the Office of Mineral Resources, Department of Natural Resources. All bearings, distances and coordinates are based on Louisiana Coordinate System of 1927, (South Zone).

NOTE: The above description of the Tract nominated for lease has been provided and corrected, where required, exclusively by the nomination party. Any mineral lease selected from this Tract and awarded by the Louisiana State Mineral and Energy Board shall be without warranty of any kind, either express, implied, or statutory, including, but not limited to, the implied warranties of merchantability and fitness for a particular purpose. Should the mineral lease awarded by the Louisiana State Mineral and Energy Board be subsequently modified, cancelled or abrogated due to the existence of conflicting leases, operating agreements, private claims or other future obligations or conditions which may affect all or any portion of the leased Tract, it shall not relieve the Lessee of the obligation to pay any bonus due thereon to the Louisiana State Mineral and

Energy Board, nor shall the Louisiana State Mineral and Energy Board be obligated to refund any consideration paid by the Lessor prior to such modification, cancellation, or abrogation, including, but not limited to, bonuses, rentals and royalties.

NOTE: This tract is located in the Rockefeller Wildlife Refuge and Game Preserve Area under the jurisdiction of the Louisiana Department of Wildlife and Fisheries which has promulgated rules and regulations for the protection of game and wildlife on the aforesaid Tract and, therefore, shall be subject to said rules and regulations, a copy of which shall be attached to the mineral leases. In addition to the specific rules and regulations applicable, the following shall apply regarding operations under this mineral lease:

- Compliance with the Rockefeller mineral regulations shall be required.
- No surface activities will be allowed in the vicinity of the Headquarters and associated facilities without written authorization from the Department.
- Board road access will be required when feasible as determined by the Department.
- In the event that board road access is not feasible, existing canals and waterways will be utilized to access proposed well locations. A maximum of 350 feet of new canal dredging will be allowed for individual well locations.
- Compensatory mitigation will be required for unavoidable wetland losses.
- No charges will be allowed, including produced waters and drilling fluids. A containerized closed loop system will be required.
- Seasonal restrictions may be imposed within specific management units dependent upon wildlife population levels.
- A minimum bonus of \$350.00 per acre and a minimum royalty of 25% will be required.
- All spoil materials generated during dredging operations shall be placed at sites determined by the Department, additionally, the Department shall have discretion to require the user of a hydraulic dredge or spray dredge.
- Prior to submitting application for wetland permits to Federal and State permitting agencies the leaseholder shall coordinate project details with the Department of Wildlife and Fisheries. Contact person for the Department will be Mike Windham at (504)284-5268.

NOTE: The State of Louisiana does hereby reserve, and this lease shall be subject to, the imprescriptible right of surface use in the nature of a servitude in favor of the Department of Natural Resources, including its Offices and Commissions, for the sole purpose of implementing,

constructing, servicing and maintaining approved coastal zone management and/or restoration projects. Utilization of any and all rights derived under this lease by the mineral lessee, its agents, successors or assigns, shall not interfere with nor hinder the reasonable surface use by the Department of Natural Resources, its Offices or Commissions, as herein above reserved.

Applicant: PATRICK L. DONOHUE PETROLEUM PROPERTIES, INC.

Bidder	Cash Payment	Price/Acre	Rental	Oil	Gas	Other

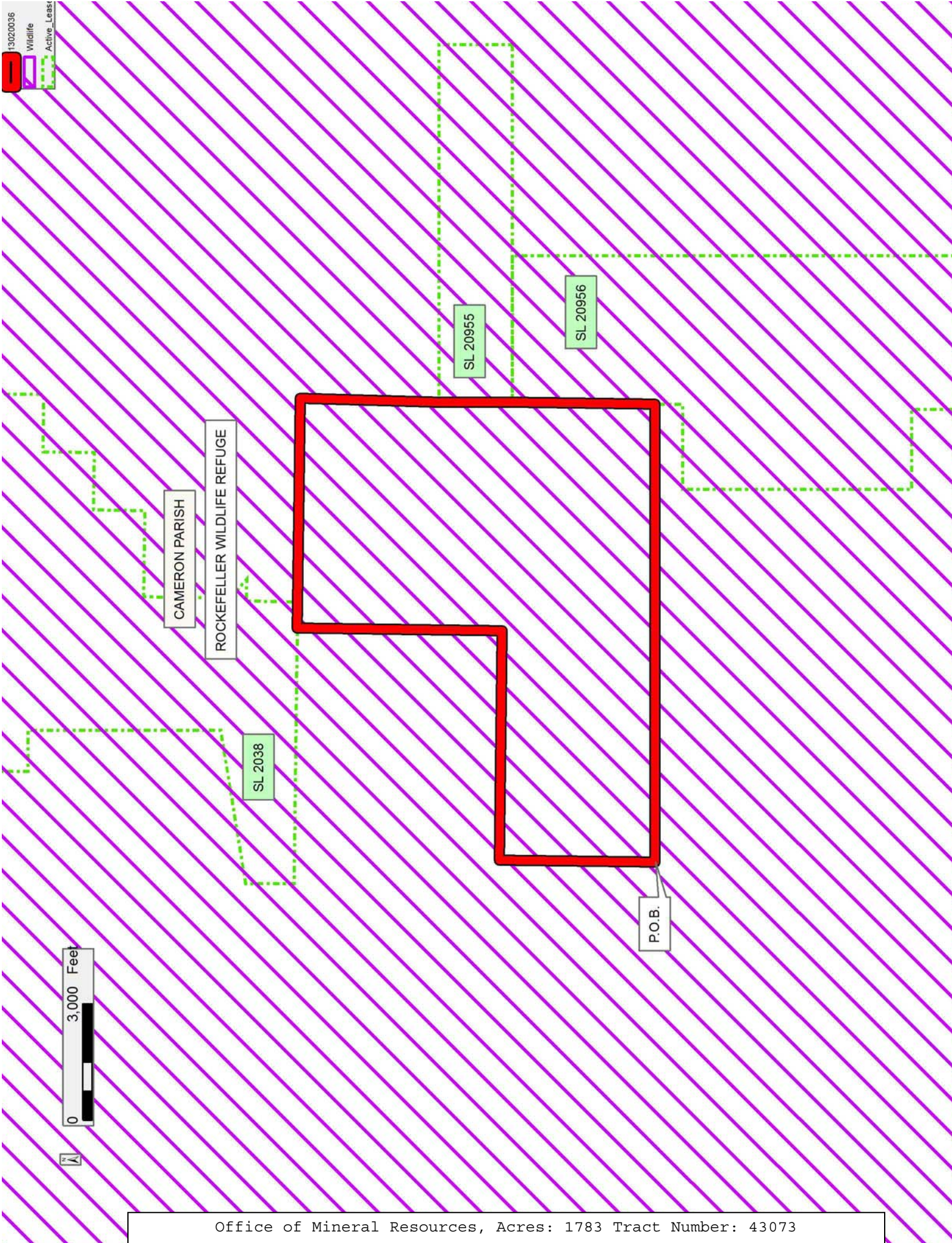

CAMERON PARISH
ROCKEFELLER WILDLIFE REFUGE

SL 2038

SL 20955

SL 20956

P.O.B.

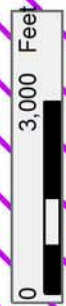

TRACT 43074 - Cameron Parish, Louisiana

A portion of all State owned lands, including high and marsh lands and land now or formerly constituting the beds and bottoms of any water body, within the boundaries of the Rockefeller Wildlife Refuge and Game Preserve, not presently under mineral lease by the State of Louisiana on February 13, 2013, situated in Cameron Parish, Louisiana, and described as follows: Beginning at a point having Coordinates of X = 1,567,857.46 and Y = 351,250.48; thence North 89 degrees 16 minutes 37 seconds West 11,794.85 feet to a point having Coordinates of X = 1,556,063.55 and Y = 351,399.31; thence North 00 degrees 38 minutes 35 seconds East 3,139.13 feet to a point on the boundary of State Lease No. 2340, as amended having Coordinates of X = 1,556,098.78 and Y = 354,538.24; thence along the boundary of said State Lease No. 2340 the following courses and distances: North 33 degrees 15 minutes 09 seconds East 540.22 feet, North 38 degrees 35 minutes 07 seconds East 601.26 feet, North 43 degrees 39 minutes 08 seconds East 601.21 feet, North 49 degrees 23 minutes 55 seconds East 599.27 feet, North 53 degrees 47 minutes 51 seconds East 601.04 feet, North 52 degrees 43 minutes 43 seconds East 999.02 feet, North 48 degrees 02 minutes 54 seconds East 598.35 feet, North 34 degrees 29 minutes 02 seconds East 600.52 feet, North 21 degrees 26 minutes 52 seconds East 601.66 feet, North 10 degrees 05 minutes 28 seconds East 599.27 feet, North 08 degrees 36 minutes 56 seconds East 1,001.30 feet, North 12 degrees 46 minutes 43 seconds East 497.32 feet, North 22 degrees 26 minutes 34 seconds East 497.69 feet and North 34 degrees 00 minutes 27 seconds East 453.82 feet to the Southwest corner of State Lease No. 20579 having Coordinates of X = 1,560,733.82 and Y = 361,601.20; thence South 89 degrees 16 minutes 35 seconds East 1,306.28 feet along the boundary of said State Lease No. 20579 to its Southeast corner and the Southwest corner of State Lease No. 20580 having Coordinates of X = 1,562,040.00 and Y = 361,584.71; thence along the boundary of said State Lease No. 20580 the following courses and distances: South 89 degrees 16 minutes 36 seconds East 3,013.87 feet to a point having Coordinates of X = 1,565,053.63 and Y = 361,546.67 and North approximately 2,640 feet to a point on the Southern boundary of State Lease No. 20139 having a Coordinate of X = 1,565,083.26; thence Easterly approximately 2,215 feet along the boundary of said State Lease No. 20139 to its Southeast corner; thence Easterly approximately 59 feet to the Southernmost Southwest corner of State Lease No. 2038, as amended; thence South 89 degrees 16 minutes 36 seconds East approximately 668 feet along the boundary of said State Lease No. 2038 to the point of intersection with a line having a bearing of North 00 degrees 44 minutes 33 seconds East, commencing at a point having Coordinates of X = 1,567,857.46 and Y = 351,250.48; thence South 00 degrees 44 minutes 33 seconds West approximately 12,900 feet to the point of beginning, **LESS AND EXCEPT** any right, title, and interest in lands owned by and not under lease from the State of Louisiana, on behalf of the Cameron Parish School Board, situated in Section 16, Township 16 South, Range 03 West, Cameron Parish, Louisiana, contained within the above described tract, containing approximately **2,498 acres**, all as more particularly outlined on a plat on file in the Office of Mineral

Resources, Department of Natural Resources. All bearings, distances and coordinates are based on Louisiana Coordinate System of 1927, (South Zone).

NOTE: The above description of the Tract nominated for lease has been provided and corrected, where required, exclusively by the nomination party. Any mineral lease selected from this Tract and awarded by the Louisiana State Mineral and Energy Board shall be without warranty of any kind, either express, implied, or statutory, including, but not limited to, the implied warranties of merchantability and fitness for a particular purpose. Should the mineral lease awarded by the Louisiana State Mineral and Energy Board be subsequently modified, cancelled or abrogated due to the existence of conflicting leases, operating agreements, private claims or other future obligations or conditions which may affect all or any portion of the leased Tract, it shall not relieve the Lessee of the obligation to pay any bonus due thereon to the Louisiana State Mineral and Energy Board, nor shall the Louisiana State Mineral and Energy Board be obligated to refund any consideration paid by the Lessor prior to such modification, cancellation, or abrogation, including, but not limited to, bonuses, rentals and royalties.

NOTE: This tract is located in the Rockefeller Wildlife Refuge and Game Preserve Area under the jurisdiction of the Louisiana Department of Wildlife and Fisheries which has promulgated rules and regulations for the protection of game and wildlife on the aforesaid Tract and, therefore, shall be subject to said rules and regulations, a copy of which shall be attached to the mineral leases. In addition to the specific rules and regulations applicable, the following shall apply regarding operations under this mineral lease:

- Compliance with the Rockefeller mineral regulations shall be required.
- No surface activities will be allowed in the vicinity of the Headquarters and associated facilities without written authorization from the Department.
- Board road access will be required when feasible as determined by the Department.
- In the event that board road access is not feasible, existing canals and waterways will be utilized to access proposed well locations. A maximum of 350 feet of new canal dredging will be allowed for individual well locations.
- Compensatory mitigation will be required for unavoidable wetland losses.
- No charges will be allowed, including produced waters and drilling fluids. A containerized closed loop system will be required.
- Seasonal restrictions may be imposed within specific management units dependent upon wildlife population levels.

- A minimum bonus of \$350.00 per acre and a minimum royalty of 25% will be required.
- All spoil materials generated during dredging operations shall be placed at sites determined by the Department, additionally, the Department shall have discretion to require the user of a hydraulic dredge or spray dredge.
- Prior to submitting application for wetland permits to Federal and State permitting agencies the leaseholder shall coordinate project details with the Department of Wildlife and Fisheries. Contact person for the Department will be Mike Windham at (504)284-5268.

NOTE: The State of Louisiana does hereby reserve, and this lease shall be subject to, the imprescriptible right of surface use in the nature of a servitude in favor of the Department of Natural Resources, including its Offices and Commissions, for the sole purpose of implementing, constructing, servicing and maintaining approved coastal zone management and/or restoration projects. Utilization of any and all rights derived under this lease by the mineral lessee, its agents, successors or assigns, shall not interfere with nor hinder the reasonable surface use by the Department of Natural Resources, its Offices or Commissions, as herein above reserved.

Applicant: PATRICK L. DONOHUE PETROLEUM PROPERTIES, INC.

Bidder	Cash Payment	Price/Acre	Rental	Oil	Gas	Other

13020037

Wildlife

Active Lease

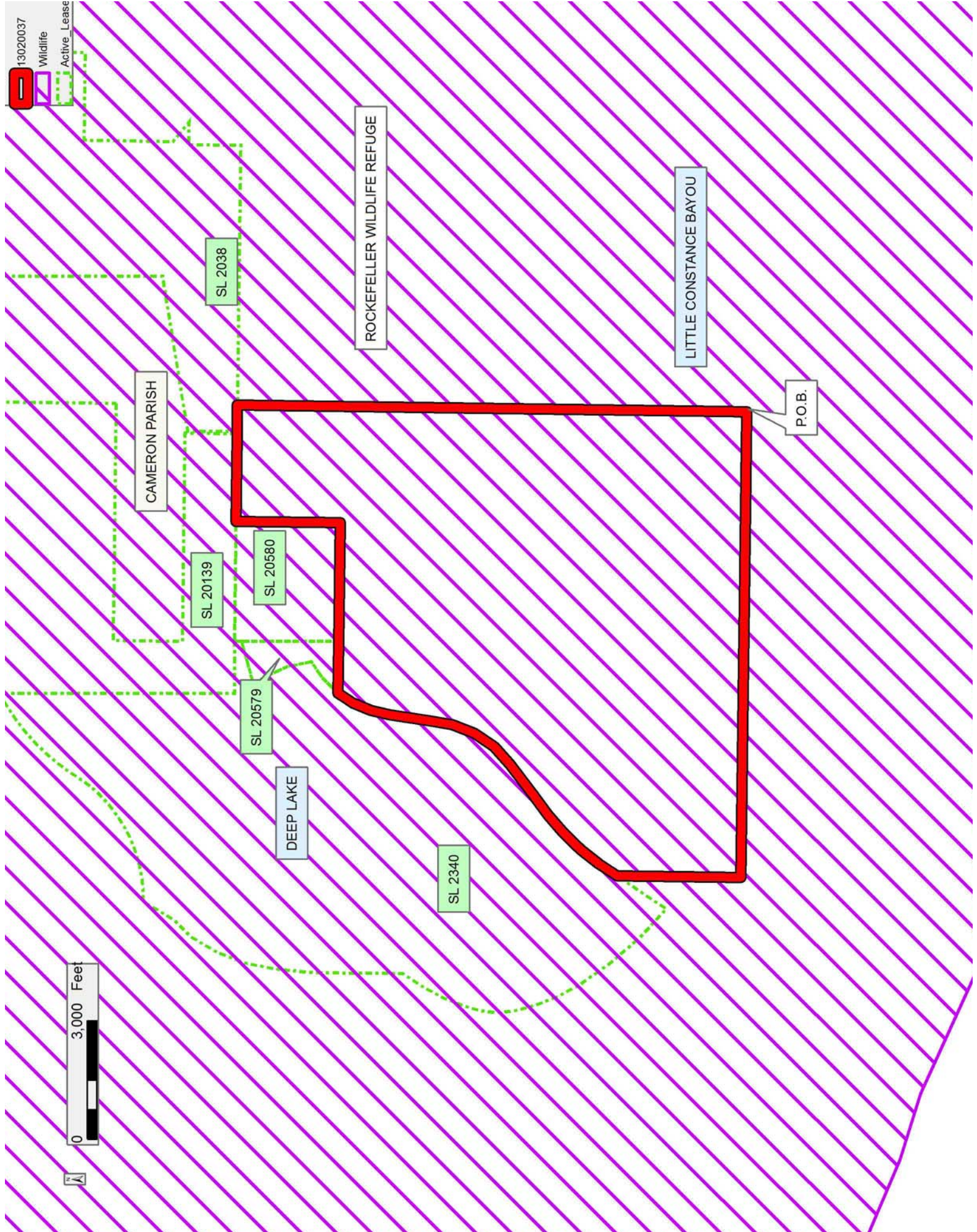

CAMERON PARISH

ROCKEFELLER WILDLIFE REFUGE

LITTLE CONSTANCE BAYOU

P.O.B.

DEEP LAKE

SL 2038

SL 20139

SL 20580

SL 20579

SL 2340



TRACT 43075 - Cameron Parish, Louisiana

A portion of all State owned lands, including high and marsh lands and land now or formerly constituting the beds and bottoms of any water body, within the boundaries of the Rockefeller Wildlife Refuge and Game Preserve, not presently under mineral lease by the State of Louisiana on February 13, 2013, situated in Cameron Parish, Louisiana, and described as follows: Beginning at a point having Coordinates of X = 1,542,093.00 and Y = 362,012.00; thence East 11,556.23 feet to a point on the boundary of State Lease No. 2340, as amended having Coordinates of X = 1,553,649.23 and Y = 362,012.00; thence along the boundary of said State Lease No. 2340 the following courses and distances: South 01 degrees 04 minutes 27 seconds West 492.11 feet to a point having Coordinates of X = 1,553,640.00 and Y = 361,519.98; thence South 00 degrees 17 minutes 11 seconds West 1,000.01 feet, South 01 degrees 25 minutes 56 seconds West 564.10 feet, South 33 degrees 25 minutes 29 seconds West 564.44 feet, South 29 degrees 19 minutes 55 seconds West 602.20 feet, South 21 degrees 26 minutes 52 seconds West 601.66 feet, South 15 degrees 56 minutes 43 seconds West 400.41 feet, South 07 degrees 12 minutes 51 seconds West 398.15 feet, South 04 degrees 17 minutes 21 seconds East 401.12 feet, South 14 degrees 02 minutes 10 seconds East 597.85 feet and South 20 degrees 33 minutes 28 seconds East 234.93 feet to a point having Coordinates of X = 1,552,892.48 and Y = 356,420.01; thence North 89 degrees 16 minutes 19 seconds West 2,164.74 feet to a point having Coordinates of X = 1,550,727.92 and Y = 356,447.52; thence South 00 degrees 49 minutes 35 seconds West 7,059.64 feet to a point having Coordinates of X = 1,550,626.10 and Y = 349,388.62; thence North 69 degrees 45 minutes 55 seconds West 9,094.38 feet to a point having Coordinates of X = 1,542,093.00 and Y = 352,534.08; thence North 9,477.92 feet to the point of beginning, containing approximately **2,500 acres**, all as more particularly outlined on a plat on file in the Office of Mineral Resources, Department of Natural Resources. All bearings, distances and coordinates are based on Louisiana Coordinate System of 1927, (South Zone).

NOTE: The above description of the Tract nominated for lease has been provided and corrected, where required, exclusively by the nomination party. Any mineral lease selected from this Tract and awarded by the Louisiana State Mineral and Energy Board shall be without warranty of any kind, either express, implied, or statutory, including, but not limited to, the implied warranties of merchantability and fitness for a particular purpose. Should the mineral lease awarded by the Louisiana State Mineral and Energy Board be subsequently modified, cancelled or abrogated due to the existence of conflicting leases, operating agreements, private claims or other future obligations or conditions which may affect all or any portion of the leased Tract, it shall not relieve the Lessee of the obligation to pay any bonus due thereon to the Louisiana State Mineral and Energy Board, nor shall the Louisiana State Mineral and Energy Board be obligated to refund any consideration paid by the Lessor prior to such modification, cancellation, or abrogation, including, but not limited to, bonuses, rentals and royalties.

NOTE: This tract is located in the Rockefeller Wildlife Refuge and Game Preserve Area under the jurisdiction of the Louisiana Department of Wildlife and Fisheries which has promulgated rules and regulations for the protection of game and wildlife on the aforesaid Tract and, therefore, shall be subject to said rules and regulations, a copy of which shall be attached to the mineral leases. In addition to the specific rules and regulations applicable, the following shall apply regarding operations under this mineral lease:

- Compliance with the Rockefeller mineral regulations shall be required.
- No surface activities will be allowed in the vicinity of the Headquarters and associated facilities without written authorization from the Department.
- Board road access will be required when feasible as determined by the Department.
- In the event that board road access is not feasible, existing canals and waterways will be utilized to access proposed well locations. A maximum of 350 feet of new canal dredging will be allowed for individual well locations.
- Compensatory mitigation will be required for unavoidable wetland losses.
- No charges will be allowed, including produced waters and drilling fluids. A containerized closed loop system will be required.
- Seasonal restrictions may be imposed within specific management units dependent upon wildlife population levels.
- A minimum bonus of \$350.00 per acre and a minimum royalty of 25% will be required.
- All spoil materials generated during dredging operations shall be placed at sites determined by the Department, additionally, the Department shall have discretion to require the user of a hydraulic dredge or spray dredge.
- Prior to submitting application for wetland permits to Federal and State permitting agencies the leaseholder shall coordinate project details with the Department of Wildlife and Fisheries. Contact person for the Department will be Mike Windham at (504)284-5268.

NOTE: The State of Louisiana does hereby reserve, and this lease shall be subject to, the imprescriptible right of surface use in the nature of a servitude in favor of the Department of Natural Resources, including its Offices and Commissions, for the sole purpose of implementing, constructing, servicing and maintaining approved coastal zone management and/or restoration projects. Utilization of any and all rights derived under this lease by the mineral lessee, its agents, successors or assigns, shall not interfere with nor hinder the reasonable surface use by the

Department of Natural Resources, its Offices or Commissions, as herein above reserved.

Applicant: PATRICK L. DONOHUE PETROLEUM PROPERTIES, INC.

Bidder	Cash Payment	Price/Acre	Rental	Oil	Gas	Other

13020035

- Wildlife
- Blocks
- Active Lease

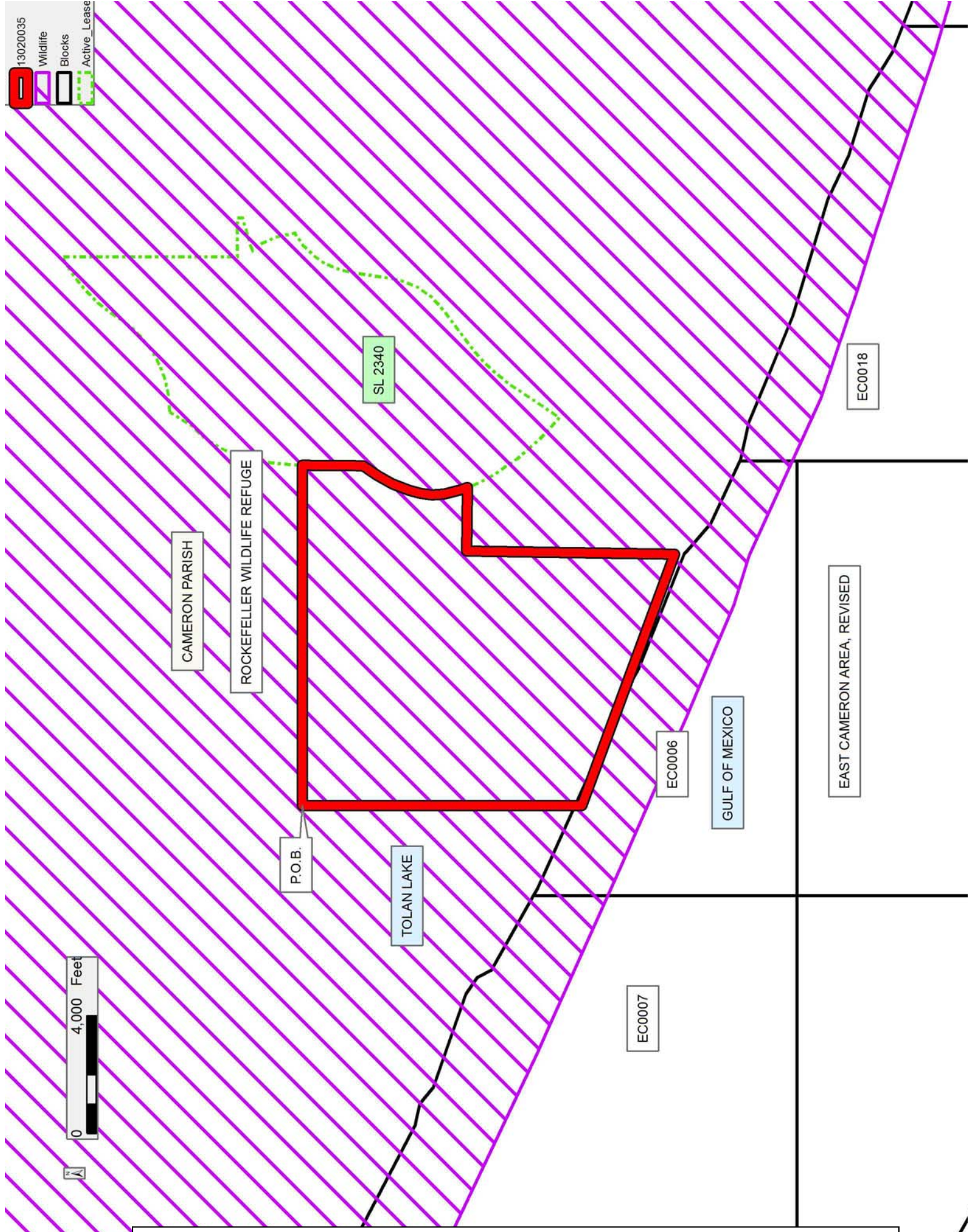

TRACT 43076 - Cameron Parish, Louisiana

A portion of all State owned lands, including high and marsh lands and land now or formerly constituting the beds and bottoms of any water body, within the boundaries of the Rockefeller Wildlife Refuge and Game Preserve, not presently under mineral lease by the State of Louisiana on February 13, 2013, situated in Cameron Parish, Louisiana, and described as follows: Beginning at a point having Coordinates of X = 1,567,857.46 and Y = 351,250.48; thence South 00 degrees 44 minutes 33 seconds West 8,175.29 feet to a point having Coordinates of X = 1,567,751.53 and Y = 343,075.87; thence North 69 degrees 45 minutes 55 seconds West 18,251.88 feet to a point having Coordinates of X = 1,550,626.10 and Y = 349,388.62; thence North 00 degrees 49 minutes 35 seconds East 7,059.64 feet to a point having Coordinates of X = 1,550,727.92 and Y = 356,447.52; thence South 89 degrees 16 minutes 20 seconds East 2,164.74 feet to a point on the boundary of State Lease No. 2340, as amended having Coordinates of X = 1,552,892.48 and Y = 356,420.01; thence along the boundary of said State Lease No. 2340 the following courses and distances: South 20 degrees 33 minutes 28 seconds East 363.15 feet, South 27 degrees 50 minutes 51 seconds East 599.42 feet, South 34 degrees 48 minutes 14 seconds East 998.65 feet, South 40 degrees 56 minutes 36 seconds East 999.52 feet, South 47 degrees 13 minutes 33 seconds East 1,001.31 feet, North 34 degrees 02 minutes 04 seconds East 1,446.57 feet and North 33 degrees 15 minutes 09 seconds East 53.16 feet to a point having Coordinates of X = 1,556,098.78 and Y = 354,538.24; thence South 00 degrees 38 minutes 35 seconds West 3,139.13 feet to a point having Coordinates of X = 1,556,063.55 and Y = 351,399.31; thence South 89 degrees 16 minutes 37 seconds East 11,794.85 feet to the point of beginning, containing approximately **2,496 acres**, all as more particularly outlined on a plat on file in the Office of Mineral Resources, Department of Natural Resources. All bearings, distances and coordinates are based on Louisiana Coordinate System of 1927, (South Zone).

NOTE: The above description of the Tract nominated for lease has been provided and corrected, where required, exclusively by the nomination party. Any mineral lease selected from this Tract and awarded by the Louisiana State Mineral and Energy Board shall be without warranty of any kind, either express, implied, or statutory, including, but not limited to, the implied warranties of merchantability and fitness for a particular purpose. Should the mineral lease awarded by the Louisiana State Mineral and Energy Board be subsequently modified, cancelled or abrogated due to the existence of conflicting leases, operating agreements, private claims or other future obligations or conditions which may affect all or any portion of the leased Tract, it shall not relieve the Lessee of the obligation to pay any bonus due thereon to the Louisiana State Mineral and Energy Board, nor shall the Louisiana State Mineral and Energy Board be obligated to refund any consideration paid by the Lessor prior to such modification, cancellation, or abrogation, including, but not limited to, bonuses, rentals and royalties.

NOTE: This tract is located in the Rockefeller Wildlife Refuge and Game Preserve Area under the jurisdiction of the Louisiana Department of Wildlife and Fisheries which has promulgated rules and regulations for the protection of game and wildlife on the aforesaid Tract and, therefore, shall be subject to said rules and regulations, a copy of which shall be attached to the mineral leases. In addition to the specific rules and regulations applicable, the following shall apply regarding operations under this mineral lease:

- Compliance with the Rockefeller mineral regulations shall be required.
- No surface activities will be allowed in the vicinity of the Headquarters and associated facilities without written authorization from the Department.
- Board road access will be required when feasible as determined by the Department.
- In the event that board road access is not feasible, existing canals and waterways will be utilized to access proposed well locations. A maximum of 350 feet of new canal dredging will be allowed for individual well locations.
- Compensatory mitigation will be required for unavoidable wetland losses.
- No charges will be allowed, including produced waters and drilling fluids. A containerized closed loop system will be required.
- Seasonal restrictions may be imposed within specific management units dependent upon wildlife population levels.
- A minimum bonus of \$350.00 per acre and a minimum royalty of 25% will be required.
- All spoil materials generated during dredging operations shall be placed at sites determined by the Department, additionally, the Department shall have discretion to require the user of a hydraulic dredge or spray dredge.
- Prior to submitting application for wetland permits to Federal and State permitting agencies the leaseholder shall coordinate project details with the Department of Wildlife and Fisheries. Contact person for the Department will be Mike Windham at (504)284-5268.

NOTE: The State of Louisiana does hereby reserve, and this lease shall be subject to, the imprescriptible right of surface use in the nature of a servitude in favor of the Department of Natural Resources, including its Offices and Commissions, for the sole purpose of implementing, constructing, servicing and maintaining approved coastal zone management and/or restoration projects. Utilization of any and all rights derived under this lease by the mineral lessee, its agents, successors or assigns, shall not interfere with nor hinder the reasonable surface use by the

Department of Natural Resources, its Offices or Commissions, as herein above reserved.

Applicant: PATRICK L. DONOHUE PETROLEUM PROPERTIES, INC.

Bidder	Cash Payment	Price/Acre	Rental	Oil	Gas	Other

13020039

- Wildlife
- Blocks
- Active Lease

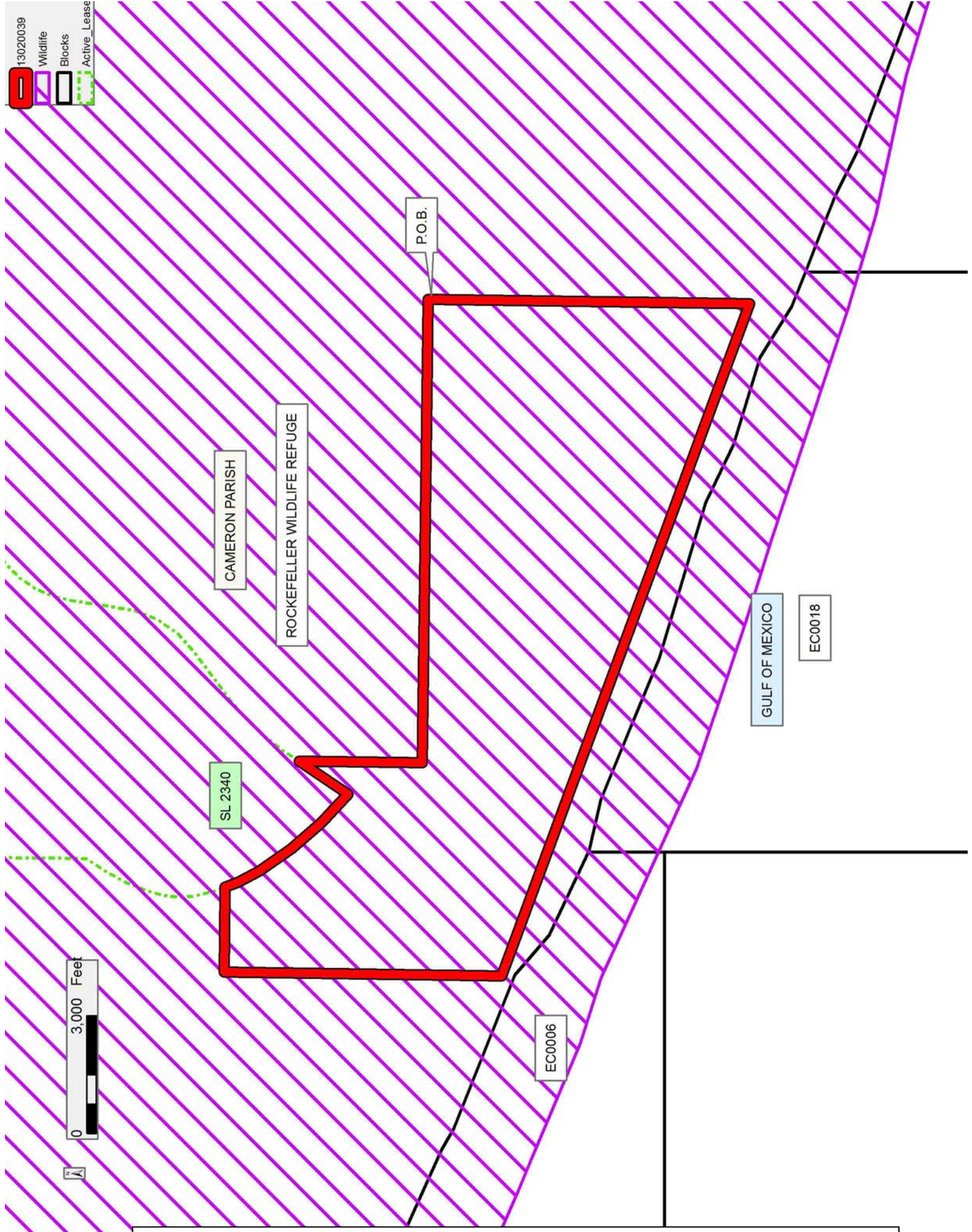

TRACT 43077 - Cameron Parish, Louisiana

A portion of all State owned lands, including high and marsh lands and land now or formerly constituting the beds and bottoms of any water body, within the boundaries of the Rockefeller Wildlife Refuge and Game Preserve, not presently under mineral lease by the State of Louisiana on February 13, 2013, situated in Cameron Parish, Louisiana, and described as follows: Beginning at a point having Coordinates of X = 1,567,904.12 and Y = 354,851.25; thence South 89 degrees 59 minutes 57 seconds East 11,795.38 feet to a point on the boundary of State Lease No. 20956 having Coordinates of X = 1,579,699.49 and Y = 354,851.04; thence along the boundary of said State Lease No. 20956 the following courses and distances: South 00 degrees 51 minutes 28 seconds West 701.12 feet to a point having Coordinates of X = 1,579,689.00 and Y = 354,150.00, West 2,189.00 feet to a point having Coordinates of X = 1,577,500.00 and Y = 354,150.00, South 5,907.00 feet to a point having Coordinates of X = 1,577,500.00 and Y = 348,243.00, East 2,064.00 feet to a point having Coordinates of X = 1,579,564.00 and Y = 348,243.00 and South 1,678.00 feet to its Southwest corner having Coordinates of X = 1,579,564.00 and Y = 346,565.00; thence South 1,859.09 feet to a point having Coordinates of X = 1,579,564.00 and Y = 344,705.91; thence West 11,791.30 feet to a point having Coordinates of X = 1,567,772.70 and Y = 344,705.91; thence North 00 degrees 44 minutes 32 seconds East 10,146.19 feet to the point of beginning, containing approximately **2,453.13 acres**, all as more particularly outlined on a plat on file in the Office of Mineral Resources, Department of Natural Resources. All bearings, distances and coordinates are based on Louisiana Coordinate System of 1927, (South Zone).

NOTE: The above description of the Tract nominated for lease has been provided and corrected, where required, exclusively by the nomination party. Any mineral lease selected from this Tract and awarded by the Louisiana State Mineral and Energy Board shall be without warranty of any kind, either express, implied, or statutory, including, but not limited to, the implied warranties of merchantability and fitness for a particular purpose. Should the mineral lease awarded by the Louisiana State Mineral and Energy Board be subsequently modified, cancelled or abrogated due to the existence of conflicting leases, operating agreements, private claims or other future obligations or conditions which may affect all or any portion of the leased Tract, it shall not relieve the Lessee of the obligation to pay any bonus due thereon to the Louisiana State Mineral and Energy Board, nor shall the Louisiana State Mineral and Energy Board be obligated to refund any consideration paid by the Lessor prior to such modification, cancellation, or abrogation, including, but not limited to, bonuses, rentals and royalties.

NOTE: This tract is located in the Rockefeller Wildlife Refuge and Game Preserve Area under the jurisdiction of the Louisiana Department of Wildlife and Fisheries which has promulgated rules and regulations for the protection of game and wildlife on the aforesaid Tract and, therefore,

shall be subject to said rules and regulations, a copy of which shall be attached to the mineral leases. In addition to the specific rules and regulations applicable, the following shall apply regarding operations under this mineral lease:

- Compliance with the Rockefeller mineral regulations shall be required.
- No surface activities will be allowed in the vicinity of the Headquarters and associated facilities without written authorization from the Department.
- Board road access will be required when feasible as determined by the Department.
- In the event that board road access is not feasible, existing canals and waterways will be utilized to access proposed well locations. A maximum of 350 feet of new canal dredging will be allowed for individual well locations.
- Compensatory mitigation will be required for unavoidable wetland losses.
- No charges will be allowed, including produced waters and drilling fluids. A containerized closed loop system will be required.
- Seasonal restrictions may be imposed within specific management units dependent upon wildlife population levels.
- A minimum bonus of \$350.00 per acre and a minimum royalty of 25% will be required.
- All spoil materials generated during dredging operations shall be placed at sites determined by the Department, additionally, the Department shall have discretion to require the user of a hydraulic dredge or spray dredge.
- Prior to submitting application for wetland permits to Federal and State permitting agencies the leaseholder shall coordinate project details with the Department of Wildlife and Fisheries. Contact person for the Department will be Mike Windham at (504)284-5268.

NOTE: The State of Louisiana does hereby reserve, and this lease shall be subject to, the imprescriptible right of surface use in the nature of a servitude in favor of the Department of Natural Resources, including its Offices and Commissions, for the sole purpose of implementing, constructing, servicing and maintaining approved coastal zone management and/or restoration projects. Utilization of any and all rights derived under this lease by the mineral lessee, its agents, successors or assigns, shall not interfere with nor hinder the reasonable surface use by the Department of Natural Resources, its Offices or Commissions, as herein above reserved.

Applicant: PATRICK L. DONOHUE PETROLEUM PROPERTIES, INC.

Bidder	Cash Payment	Price/Acre	Rental	Oil	Gas	Other

13020040
Wildlife
Blocks
Active_Lease

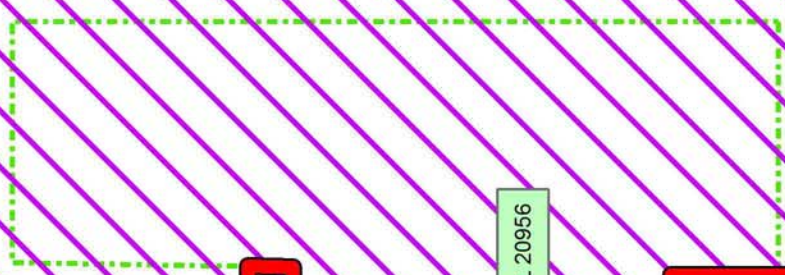

SL 20956

CAMERON PARISH

ROCKEFELLER WILDLIFE REFUGE

LITTLE CONSTANCE LAKE

P.O.B.

EC0019

EC0018

