

TRACT 42065 - Caddo Parish, Louisiana

A certain Tract of land, excluding the beds and bottoms of all navigable waters, belonging to and not presently under mineral lease from Board Of Supervisors Of Southern University And A&M College on May 11, 2011, being more fully described as follows:

That certain tract of land, located and described as follows: From the Southeast corner Section 18, Township 18 North, Range 14 West, Caddo Parish, Louisiana, said corner being the centerline intersection of the Cooper Rd. and Juvenile Rd.; run North 89° 55' West, along the centerline of the Cooper Rd. a distance of 800 feet; run thence North 0° 08' East, a distance of 50 Feet to a point on the North right-of-way line of the Cooper Rd., said point being the point of beginning of the tract herein described; run thence North 89° 55' West, along said North right-of-way line, a distance of 1,674.27 Feet; run thence North 61° 41' West, a distance of 135.15 Feet to a point on the East right-of-way line of United Gas Pipeline Company's 60 Foot right-of-way; run thence North 0° 14' East, along said East right-of-way line a distance of 1,217.79 Feet; run thence South 89° 53' East, a distance of 2,591.58 Feet to a point on the East line of said Section 18; run thence South 0° 08' West, along said East line of Section 18, a distance of 600 Feet; run thence North 89° 55' West, a distance of 800.10 Feet; run thence South 0° 08' West a distance of 680.56 Feet to the point of beginning, containing 63.67 acres, more or less, all as more fully shown by Map of Survey made by Demopulos & Ferguson, consulting engineers.

Also that certain tract of land, located and described as follows: Northwest Quarter (NW ¼) of the Southeast Quarter (SE ¼) less the west fifty (50') feet thereof of Section Eighteen (18) Township Eighteen (18) North. Range Fourteen (14) West, situated in Caddo Parish, Louisiana, and Lot 90, Lot 91, Lot 96 and Lot 97, all in Cooper Heights Subdivision Unit No. 4, lying next to and adjoining on the east said Northwest Quarter (NW ¼) of Southeast Quarter (SE ¼) of said Section 18, Township 18 North, Range 14 West, situated in Caddo Parish, Louisiana, LESS AND EXCEPT those portions of Lots 84 and 85 of Cooper Heights Subdivision Unit No. 4 lying within the said Northwest Quarter (NW ¼) of Southeast Quarter (SE ¼) of Section 18, Township 18 North, Range 14 West, Caddo Parish, Louisiana, containing 38.48 acres, more or less.

The two above described tracts total approximately **102.15 acres**, all as more particularly outlined on a plat on file in the Office of Mineral Resources, Department of Natural Resources. The description is based on information provided by the State Agency regarding location and ownership of surface and mineral rights. All bearings, distances and coordinates, if

applicable, are based on Louisiana Coordinate System of 1927, (North or South Zone).

NOTE: The above description of the Tract nominated for lease has been provided and corrected, where required, exclusively by the nomination party. Any mineral lease selected from this Tract and awarded by the Louisiana State Mineral and Energy Board shall be without warranty of any kind, either express, implied, or statutory, including, but not limited to, the implied warranties of merchantability and fitness for a particular purpose. Should the mineral lease awarded by the Louisiana State Mineral and Energy Board be subsequently modified, cancelled or abrogated due to the existence of conflicting leases, operating agreements, private claims or other future obligations or conditions which may affect all or any portion of the leased Tract, it shall not relieve the Lessee of the obligation to pay any bonus due thereon to the Louisiana State Mineral and Energy Board, nor shall the Louisiana State Mineral and Energy Board be obligated to refund any consideration paid by the Lessor prior to such modification, cancellation, or abrogation, including, but not limited to, bonuses, rentals and royalties.

NOTE: There shall be a minimum bonus of not less than \$5,000 per acre and royalty payments of not less than 25%.

NOTE: There shall be no drilling or surface rights without the written permission of the Board of Supervisors of Southern University and A&M College.

NOTE: The University shall be reimbursed for all damaged marketable timber at current market value.

NOTE: This lease shall contain a Horizontal Pugh Clause.

Applicant: BOARD OF SUPERVISORS, SOUTHERN UNIVERSITY AND A&M COLLEGE to Agency and by Resolution from the Board Of Supervisors Of Southern University And A&M College authorizing the Mineral Board to act in its behalf

Bidder	Cash Payment	Price/Acre	Rental	Oil	Gas	Other

11050001

IMAGERY.DRG2400

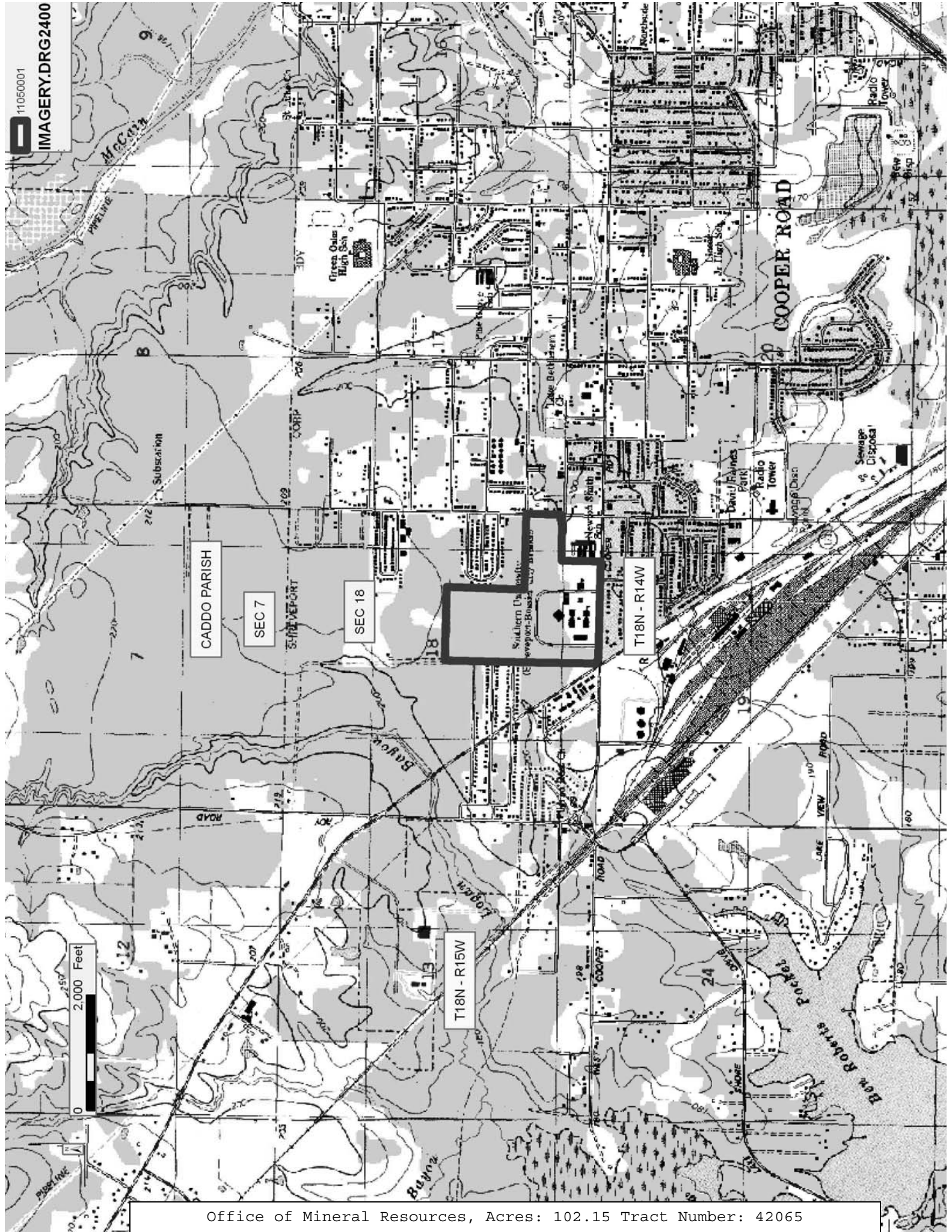

TRACT 42066 - Vernon Parish, Louisiana

A certain Tract of land, excluding the beds and bottoms of all navigable waters, belonging to and not presently under mineral lease from Lsu Board Of Supervisors on May 11, 2011, being more fully described as follows: The West Half of the Southeast Quarter (W/2 of SE/4), the Southwest Quarter of the Northeast Quarter (SW/4 of NE/4), the West Half of the Northwest Quarter of the Northeast Quarter (W/2 of NW/4 of NE/4) and the West Half (W/2) of Section 26; and the East Half of the Southwest Quarter (E/2 of SW/4), the Southeast Quarter of the Northeast Quarter (SE/4 of NE/4) and the Southeast Quarter (SE/4) of Section 27, all in Township 1 South, Range 9 West, Vernon Parish, Louisiana, containing approximately **740 acres**, all as more particularly outlined on a plat on file in the Office of Mineral Resources, Department of Natural Resources. The description is based on information provided by the State Agency regarding location and ownership of surface and mineral rights. All bearings, distances and coordinates, if applicable, are based on Louisiana Coordinate System of 1927, (North or South Zone).

NOTE: The above description of the Tract nominated for lease has been provided and corrected, where required, exclusively by the nomination party. Any mineral lease selected from this Tract and awarded by the Louisiana State Mineral and Energy Board shall be without warranty of any kind, either express, implied, or statutory, including, but not limited to, the implied warranties of merchantability and fitness for a particular purpose. Should the mineral lease awarded by the Louisiana State Mineral and Energy Board be subsequently modified, cancelled or abrogated due to the existence of conflicting leases, operating agreements, private claims or other future obligations or conditions which may affect all or any portion of the leased Tract, it shall not relieve the Lessee of the obligation to pay any bonus due thereon to the Louisiana State Mineral and Energy Board, nor shall the Louisiana State Mineral and Energy Board be obligated to refund any consideration paid by the Lessor prior to such modification, cancellation, or abrogation, including, but not limited to, bonuses, rentals and royalties.

NOTE: There shall be a minimum bonus payment of \$250 per acre and a minimum royalty of 22.5%

Bidder	Cash Payment	Price/Acre	Rental	Oil	Gas	Other

Applicant: PETRO-LAND RESOURCES, INC. to Agency and by Resolution from the
Lsu Board Of Supervisors authorizing the Mineral Board to act in its
behalf

Legend

11050006

IMAGERY.DRG24000

VERNON PARISH

T1S - R9W

SEC 23

SEC 22

SEC 26

SEC 27

2,000 Feet

TRACT 42067 - Pointe Coupee Parish School Board - Pointe Coupee Parish, Louisiana

The State Mineral and Energy Board acting on behalf of the Pointe Coupee Parish School Board, pursuant to Resolution(s) adopted by that (those) body(ies) and in accordance with Louisiana Revised Statutes 30:121-136 and 151-156, as amended, and Article XIV, Section 16(A)(9) and (B) of the Louisiana Constitution of 1974, as same may be continued and promulgated in proper statutory form and, further, amended from time to time, advertises the lands not under mineral lease on May 11, 2011, excluding the beds and bottoms of all navigable water bodies located within the following: All or a portion of Section 16, Township 03 South, Range 09 East in Pointe Coupee Parish, Louisiana, containing approximately **794.382 acres**, all as more particularly outlined on a plat on file in the Office of Mineral Resources, Department of Natural Resources. All bearings, distances and coordinates are based on Louisiana Coordinate System of 1927, (North or South Zone).

NOTE: The above description of the Tract nominated for lease has been provided and corrected, where required, exclusively by the nomination party. Any mineral lease selected from this Tract and awarded by the Louisiana State Mineral and Energy Board shall be without warranty of any kind, either express, implied, or statutory, including, but not limited to, the implied warranties of merchantability and fitness for a particular purpose. Should the mineral lease awarded by the Louisiana State Mineral and Energy Board be subsequently modified, cancelled or abrogated due to the existence of conflicting leases, operating agreements, private claims or other future obligations or conditions which may affect all or any portion of the leased Tract, it shall not relieve the Lessee of the obligation to pay any bonus due thereon to the Louisiana State Mineral and Energy Board, nor shall the Louisiana State Mineral and Energy Board be obligated to refund any consideration paid by the Lessor prior to such modification, cancellation, or abrogation, including, but not limited to, bonuses, rentals and royalties.

Applicant: SJP OG, INC. to Agency and by Resolution from the Pointe Coupee Parish School Board authorizing the Mineral Board to act in its behalf

Bidder	Cash Payment	Price/Acre	Rental	Oil	Gas	Other

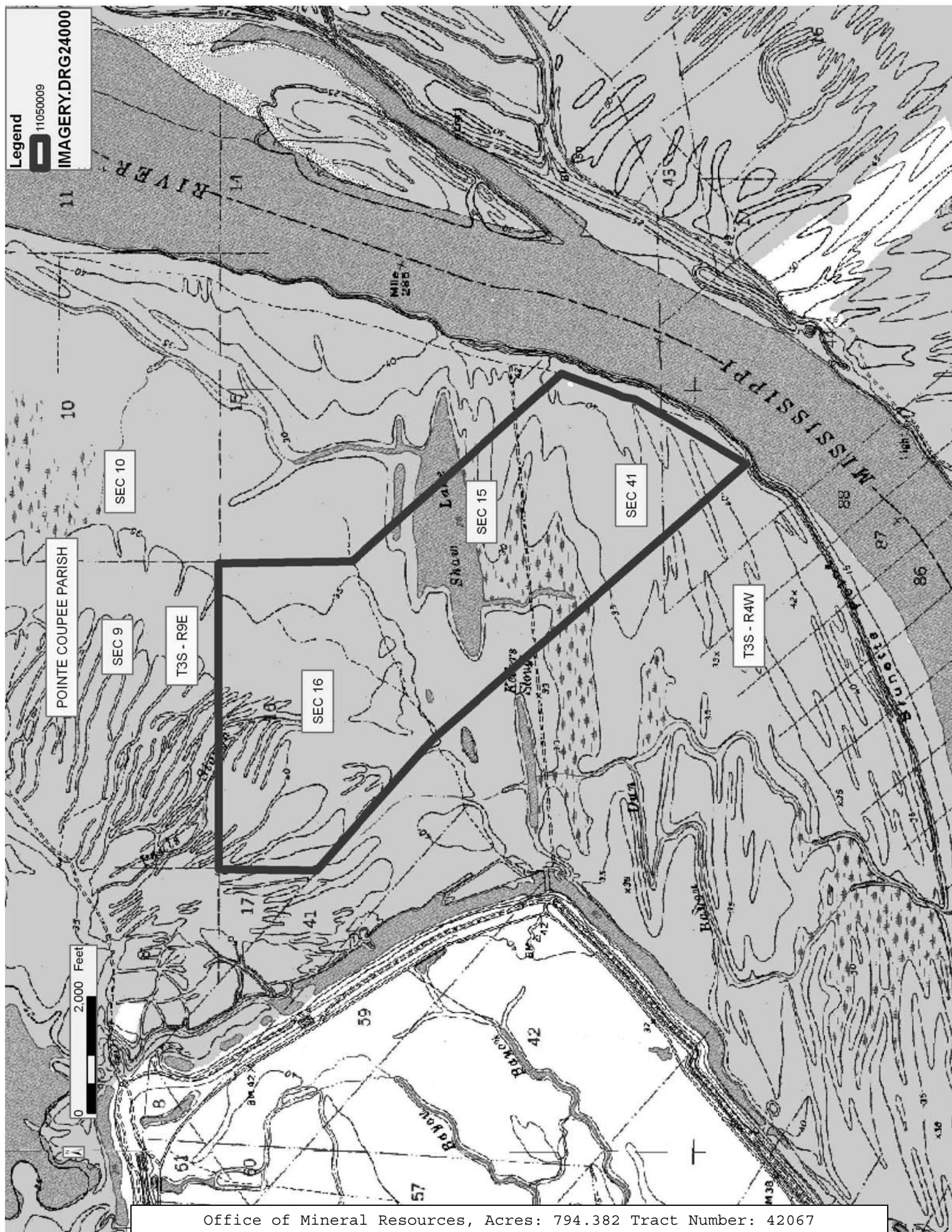

TRACT 42068 - West Feliciana Parish, Louisiana

A certain Tract of land, excluding the beds and bottoms of all navigable waters, belonging to and not presently under mineral lease from Office Of State Parks on May 11, 2011, being more fully described as follows: A certain piece or parcel of land situated in the Parish of West Feliciana, State of Louisiana, in Section 98, Township Three South Range Two West, St. Helena Meridian, containing One Hundred acres, being a portion of the Oakley Plantation, and being that portion of said Plantation on which the residence is located; said parcel of land herein conveyed having a front of Twenty Five (25.00) chains on the Lower St. Francisville-Jackson Highway, and running back between parallel lines a distance of Forty Chains, and is bounded on the North by the aforesaid Lower St. Francisville-Jackson Highway, on the East by a Public Road running along the East Section Line of Section 98, Township Three South Range Two West, and on the South and West by other portions of said Oakley Plantation, containing approximately **100 acres**, all as more particularly outlined on a plat on file in the Office of Mineral Resources, Department of Natural Resources. The description is based on information provided by the State Agency regarding location and ownership of surface and mineral rights. All bearings, distances and coordinates, if applicable, are based on Louisiana Coordinate System of 1927, (North or South Zone).

NOTE: The above description of the Tract nominated for lease has been provided and corrected, where required, exclusively by the nomination party. Any mineral lease selected from this Tract and awarded by the Louisiana State Mineral and Energy Board shall be without warranty of any kind, either express, implied, or statutory, including, but not limited to, the implied warranties of merchantability and fitness for a particular purpose. Should the mineral lease awarded by the Louisiana State Mineral and Energy Board be subsequently modified, cancelled or abrogated due to the existence of conflicting leases, operating agreements, private claims or other future obligations or conditions which may affect all or any portion of the leased Tract, it shall not relieve the Lessee of the obligation to pay any bonus due thereon to the Louisiana State Mineral and Energy Board, nor shall the Louisiana State Mineral and Energy Board be obligated to refund any consideration paid by the Lessor prior to such modification, cancellation, or abrogation, including, but not limited to, bonuses, rentals and royalties.

NOTE: No surface activity on this tract undertaken in conjunction with any operations under any mineral lease given on this tract will be allowed without prior approval of the surface owner and further, no such right of surface use shall be deemed to have been given as part of any mineral lease by the State of Louisiana on this tract.

Applicant: HEMPCO ENERGY RESOURCES to Agency and by Resolution from the Office Of State Parks authorizing the Mineral Board to act in its behalf

Bidder	Cash Payment	Price/ Acre	Rental	Oil	Gas	Other

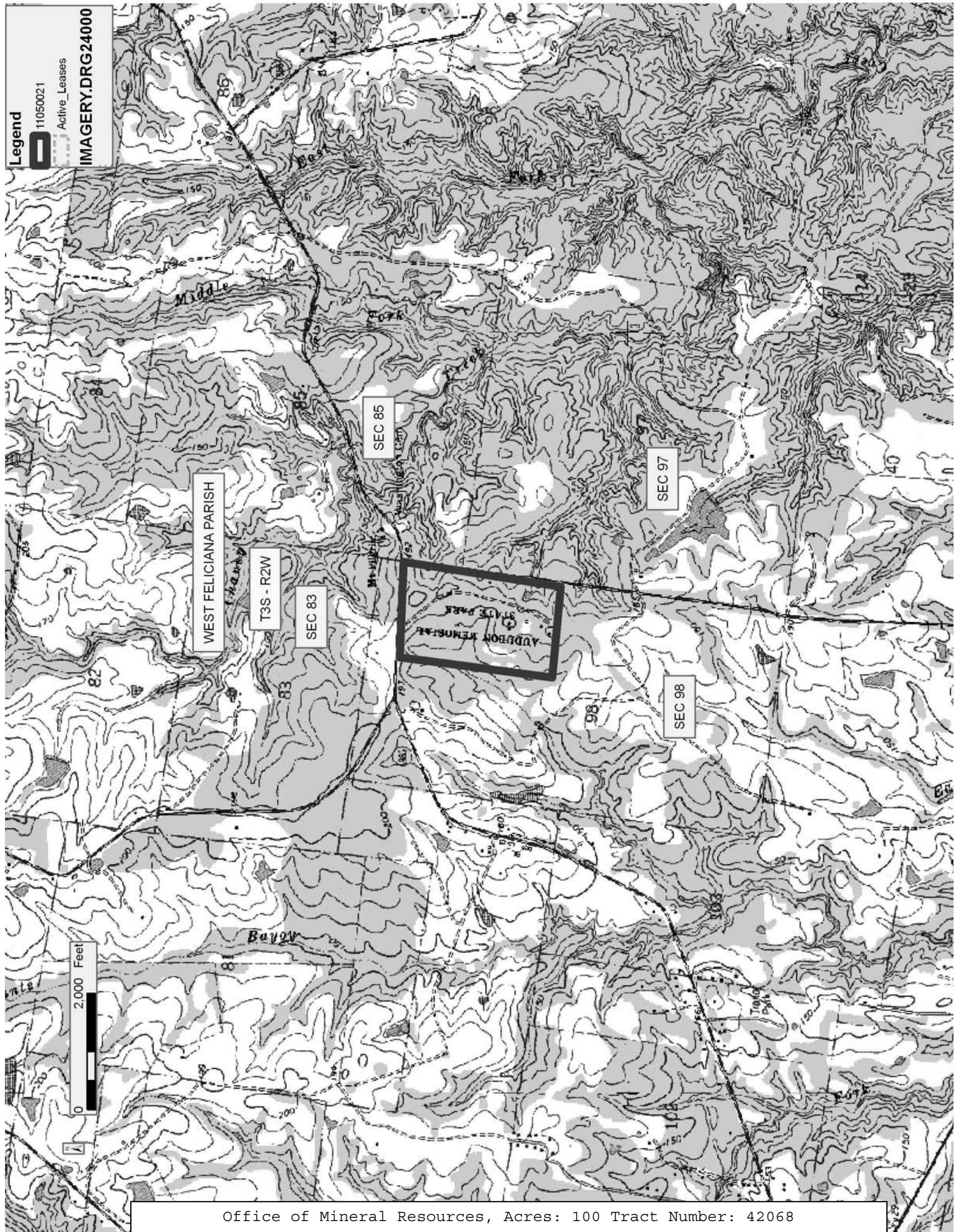

TRACT 42069 - Acadia Parish, Louisiana

A certain Tract of land, excluding the beds and bottoms of all navigable waters, belonging to and not presently under mineral lease from Lsu Board Of Supervisors on May 11, 2011, being more fully described as follows: An undivided one half (1/2) interest in and to: The Northeast Quarter of the Northeast Quarter (NE/4 of NE/4) of Section 28 and the North Half of the Northwest Quarter (N/2 of NW/4) of Section 27, Township 9 South, Range 1 East, excluding beds and bottoms of all navigable waters, containing approximately 120.00 gross acres and **60 net mineral acres**, all as more particularly outlined on a plat on file in the Office of Mineral Resources, Department of Natural Resources. The description is based on information provided by the State Agency regarding location and ownership of surface and mineral rights. All bearings, distances and coordinates, if applicable, are based on Louisiana Coordinate System of 1927, (North or South Zone).

NOTE: The above description of the Tract nominated for lease has been provided and corrected, where required, exclusively by the nomination party. Any mineral lease selected from this Tract and awarded by the Louisiana State Mineral and Energy Board shall be without warranty of any kind, either express, implied, or statutory, including, but not limited to, the implied warranties of merchantability and fitness for a particular purpose. Should the mineral lease awarded by the Louisiana State Mineral and Energy Board be subsequently modified, cancelled or abrogated due to the existence of conflicting leases, operating agreements, private claims or other future obligations or conditions which may affect all or any portion of the leased Tract, it shall not relieve the Lessee of the obligation to pay any bonus due thereon to the Louisiana State Mineral and Energy Board, nor shall the Louisiana State Mineral and Energy Board be obligated to refund any consideration paid by the Lessor prior to such modification, cancellation, or abrogation, including, but not limited to, bonuses, rentals and royalties.

NOTE: There shall be a minimum bonus of \$250 per acre and a minimum royalty of 22.5%.

Applicant: CINCO LAND & EXPLORATION, INC. to Agency and by Resolution from

Bidder	Cash Payment	Price/ Acre	Rental	Oil	Gas	Other

the Lsu Board Of Supervisors authorizing the Mineral Board to act in its
behalf

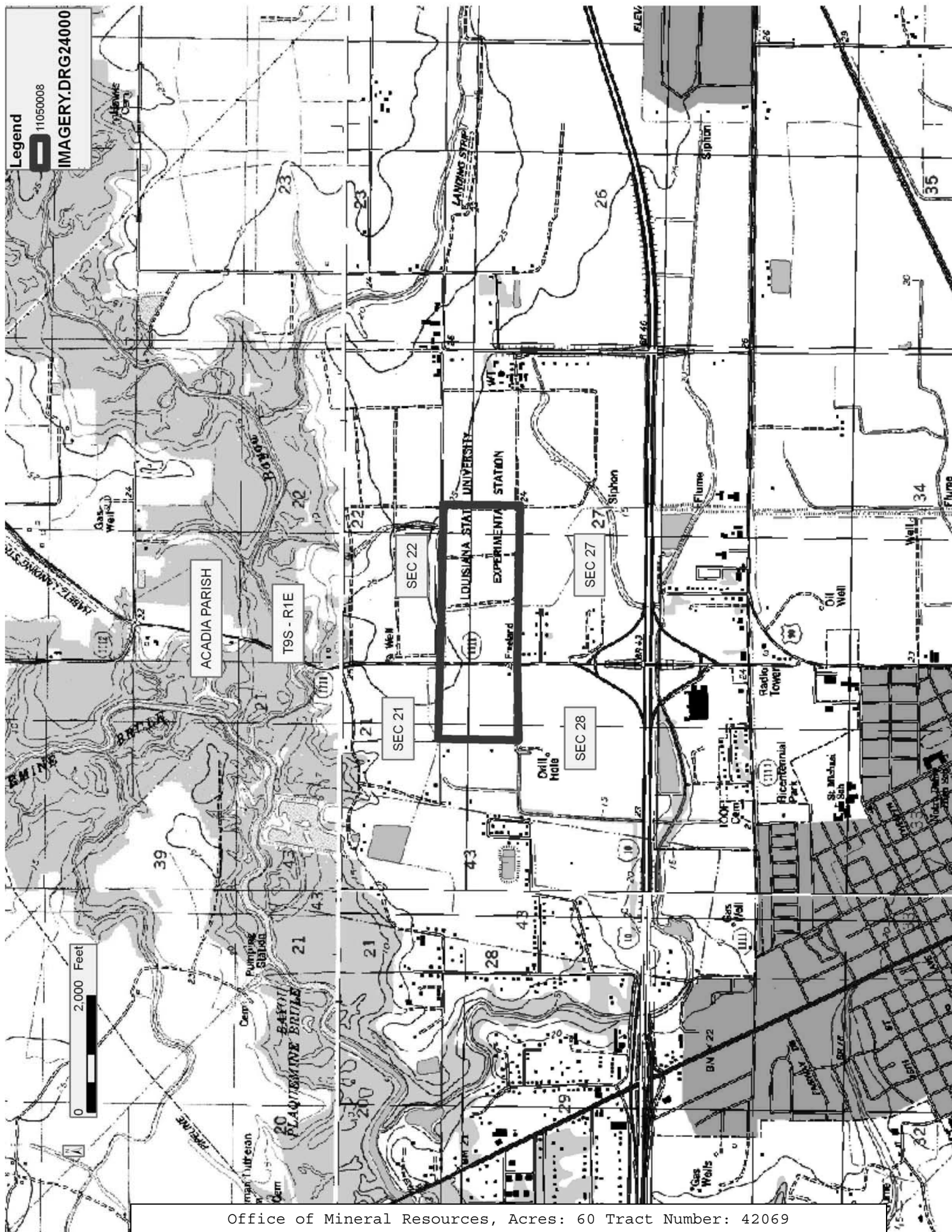

TRACT 42070 - Acadia Parish, Louisiana

A certain Tract of land, excluding the beds and bottoms of all navigable waters, belonging to and not presently under mineral lease from Lsu Board Of Supervisors on May 11, 2011, being more fully described as follows: A 100% interest in and to: The Northeast Quarter (NE/4) of Section 27, Township 9 South, Range 1 East, excluding beds and bottoms of all navigable waters, containing approximately **160.00 acres**, all as more particularly outlined on a plat on file in the Office of Mineral Resources, Department of Natural Resources. The description is based on information provided by the State Agency regarding location and ownership of surface and mineral rights. All bearings, distances and coordinates, if applicable, are based on Louisiana Coordinate System of 1927, (North or South Zone).

NOTE: The above description of the Tract nominated for lease has been provided and corrected, where required, exclusively by the nomination party. Any mineral lease selected from this Tract and awarded by the Louisiana State Mineral and Energy Board shall be without warranty of any kind, either express, implied, or statutory, including, but not limited to, the implied warranties of merchantability and fitness for a particular purpose. Should the mineral lease awarded by the Louisiana State Mineral and Energy Board be subsequently modified, cancelled or abrogated due to the existence of conflicting leases, operating agreements, private claims or other future obligations or conditions which may affect all or any portion of the leased Tract, it shall not relieve the Lessee of the obligation to pay any bonus due thereon to the Louisiana State Mineral and Energy Board, nor shall the Louisiana State Mineral and Energy Board be obligated to refund any consideration paid by the Lessor prior to such modification, cancellation, or abrogation, including, but not limited to, bonuses, rentals and royalties.

NOTE: There shall be a minimum bonus payment of \$250 per acre and a minimum royalty of 22.5%

Applicant: CINCO LAND & EXPLORATION, INC. to Agency and by Resolution from the Lsu Board Of Supervisors authorizing the Mineral Board to act in its behalf

Bidder	Cash Payment	Price/Acre	Rental	Oil	Gas	Other

