

TRACT 42230 - Pointe Coupee Parish School Board - Pointe Coupee Parish, Louisiana

The State Mineral and Energy Board acting on behalf of the Pointe Coupee Parish School Board, pursuant to Resolution(s) adopted by that (those) body(ies) and in accordance with Louisiana Revised Statutes 30:121-136 and 151-156, as amended, and Article XIV, Section 16(A)(9) and (B) of the Louisiana Constitution of 1974, as same may be continued and promulgated in proper statutory form and, further, amended from time to time, advertises the lands not under mineral lease on August 10, 2011, excluding the beds and bottoms of all navigable water bodies located within the following: All or a portion of Section 16, Township 03 South, Range 09 East in Pointe Coupee Parish, Louisiana, containing **343.56 acres**, more or less, , all as more particularly outlined on a plat on file in the Office of Mineral Resources, Department of Natural Resources. All bearings, distances and coordinates are based on Louisiana Coordinate System of 1927, (North or South Zone).

NOTE: The above description of the Tract nominated for lease has been provided and corrected, where required, exclusively by the nomination party. Any mineral lease selected from this Tract and awarded by the Louisiana State Mineral and Energy Board shall be without warranty of any kind, either express, implied, or statutory, including, but not limited to, the implied warranties of merchantability and fitness for a particular purpose. Should the mineral lease awarded by the Louisiana State Mineral and Energy Board be subsequently modified, cancelled or abrogated due to the existence of conflicting leases, operating agreements, private claims or other future obligations or conditions which may affect all or any portion of the leased Tract, it shall not relieve the Lessee of the obligation to pay any bonus due thereon to the Louisiana State Mineral and Energy Board, nor shall the Louisiana State Mineral and Energy Board be obligated to refund any consideration paid by the Lessor prior to such modification, cancellation, or abrogation, including, but not limited to, bonuses, rentals and royalties.

Applicant: SJP OG to Agency and by Resolution from the Pointe Coupee Parish School Board authorizing the Mineral Board to act in its behalf

Bidder	Cash Payment	Price/Acre	Rental	Oil	Gas	Other

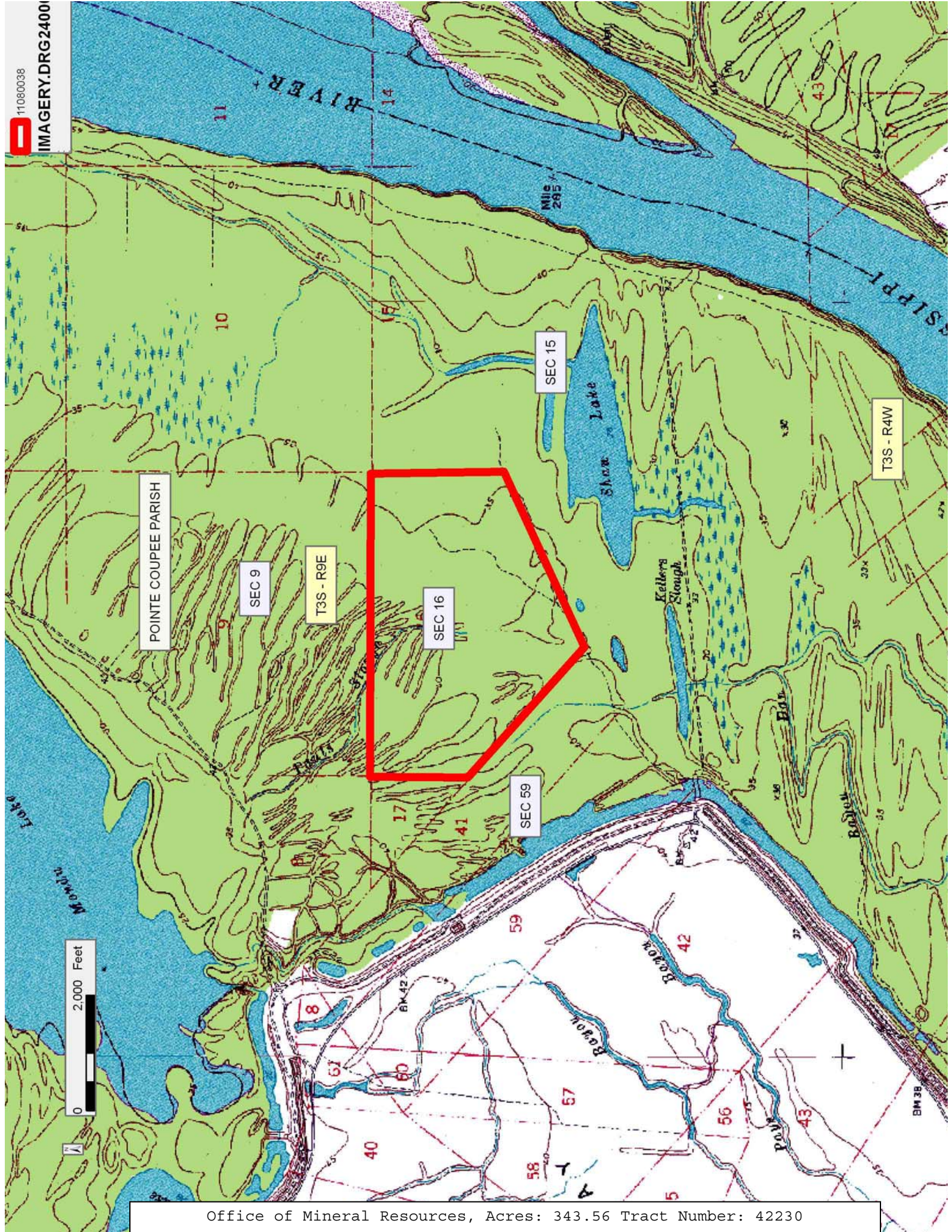

TRACT 42231 - Iberville Parish, Louisiana

A certain Tract of land, excluding the beds and bottoms of all navigable waters, belonging to and not presently under mineral lease from Louisiana Department Of Public Safety And Corrections on August 10, 2011, being more fully described as follows: A certain 2000 acre tract of land located in Sections 1, 42, 45, 46, 47, 48, 49, 50, 51, 53, 54, 55, 56, 58, 60, 61, 62 and 65, T9S R1E, S.E.D. of Louisiana, East of the Mississippi River, Iberville Parish, Louisiana, and more particularly described as follows: From the point of beginning, which is the point at which the line common to Sections 55 and 56 intersects the left bank of the Mississippi River, proceed North 05 degrees 30 feet West a distance of 1760± feet; thence South 67 degrees 35 feet West a distance of 195 feet; thence South 05 degrees 30 feet East a distance of 1946.2 feet to the left bank of the Mississippi River; thence along said bank of the Mississippi River in the upstream direction a distance of 1200± feet to the eastern line of the Joe and Mary Martin tract; thence along the eastern line of said tract North 05 degrees 45 feet West a distance of 1368± feet; thence South 85 degrees 40 feet West a distance of 192 feet; thence South 05 degrees 45 feet East a distance of 1285± feet; thence North 67 degrees 40 feet West a distance of 505.5 feet; thence North 39 degrees West a distance of 129 feet; thence North 68 degrees 45 feet West a distance of 199.5 feet; thence North 44 degrees 10 feet West a distance of 1908.5 feet; thence North 69 degrees 20 feet West a distance of 25 feet; thence North 76 degrees West a distance of 300 feet; thence North 83 degrees 10 feet West a distance of 1325± feet to the left bank of the Mississippi River; thence along said bank in the upstream direction North 25 degrees West a distance of 400 feet; thence North 02 degrees 30 feet West a distance of 840 feet; thence North 01 degrees 15 feet West a distance of 1020 feet; thence North 15 degrees East a distance of 1750 feet; thence North 20 degrees 30 feet East a distance of 1000 feet; thence North 26 degrees East a distance of 1230 feet; thence along said left bank of the Mississippi River a distance of 1900 feet to set the limit of the 2000 acre tract herein described; thence South 68 degrees 30 feet East along said line of 2000 acres a distance of 4276± feet to a point which is 500 feet from and parallel to the Eastern line of the National Leprosarium; thence North 38 degrees 45 feet East along said line a distance of 3160± feet; thence South 51 degrees 15 feet East a distance of 500 feet; thence North 53 degrees 08 feet East a distance of 2875 feet; thence North 47 degrees 35 feet East a distance of 885 feet; thence North 61 degrees 10 feet East a distance of 608 feet; thence North 60 degrees East a distance of 412 feet; thence North 52 degrees 55 feet East a distance of 618 feet; thence North 50 degrees 50 feet East a distance of 630± feet to the Northernmost line of the 2000 acre herein described; thence South 29 degrees 06 feet East a distance of 5500± feet to the left bank of the Mississippi River; thence along said left bank in the upstream direction a distance of 6400± feet to the Northernmost line of the National Leprosarium; thence along said line North 31 degrees West a distance of 5350± feet to the Southern line of the National Leprosarium property; thence along said line South 29 degrees 30 feet East a distance of 4305± feet the left bank of the Mississippi River; thence along said

left bank in an upstream direction South 50 degrees West a distance of 1200 feet; thence South 39 degrees West a distance of 2565 feet; thence South 42 degrees West a distance of 500 feet; thence South 70 degrees West a distance of 184 feet to the point of beginning and to contain 2000 acres; containing approximately approximately 2000 acres, all more fully shown on the plat entitled seconds Compiled Map of A Certain 2000 Acre Tract of Land Located in Sections 1, 42, 45, 46, 47, 48, 49, 50, 51, 53, 54, 55, 56, 58, 60, 61, 62 AND 65, Township 9 South, Range 1 East S.E.D. of La. East of Mississippi River, Iberville Parish, La. seconds prepared by Consulting Engineers Landscape Architects, dated December 3, 1978, **LESS AND EXCEPT** those portions of State Lease No. 14720, as amended and State Agency Lease No. 20389 that may lie within the above described tract, containing approximately 1,948.982 gross acres, **974.491 net acres**, all as more particularly outlined on a plat on file in the Office of Mineral Resources, Department of Natural Resources. The description is based on information provided by the State Agency regarding location and ownership of surface and mineral rights. All bearings, distances and coordinates, if applicable, are based on Louisiana Coordinate System of 1927, (North or South Zone).

NOTE: The above description of the Tract nominated for lease has been provided and corrected, where required, exclusively by the nomination party. Any mineral lease selected from this Tract and awarded by the Louisiana State Mineral and Energy Board shall be without warranty of any kind, either express, implied, or statutory, including, but not limited to, the implied warranties of merchantability and fitness for a particular purpose. Should the mineral lease awarded by the Louisiana State Mineral and Energy Board be subsequently modified, cancelled or abrogated due to the existence of conflicting leases, operating agreements, private claims or other future obligations or conditions which may affect all or any portion of the leased Tract, it shall not relieve the Lessee of the obligation to pay any bonus due thereon to the Louisiana State Mineral and Energy Board, nor shall the Louisiana State Mineral and Energy Board be obligated to refund any consideration paid by the Lessor prior to such modification, cancellation, or abrogation, including, but not limited to, bonuses, rentals and royalties.

Bidder	Cash Payment	Price/Acre	Rental	Oil	Gas	Other

Applicant: HARPER PETROLEUM COMPANY, INC. to Agency and by Resolution from the Louisiana Department Of Public Safety And Corrections authorizing the Mineral Board to act in its behalf

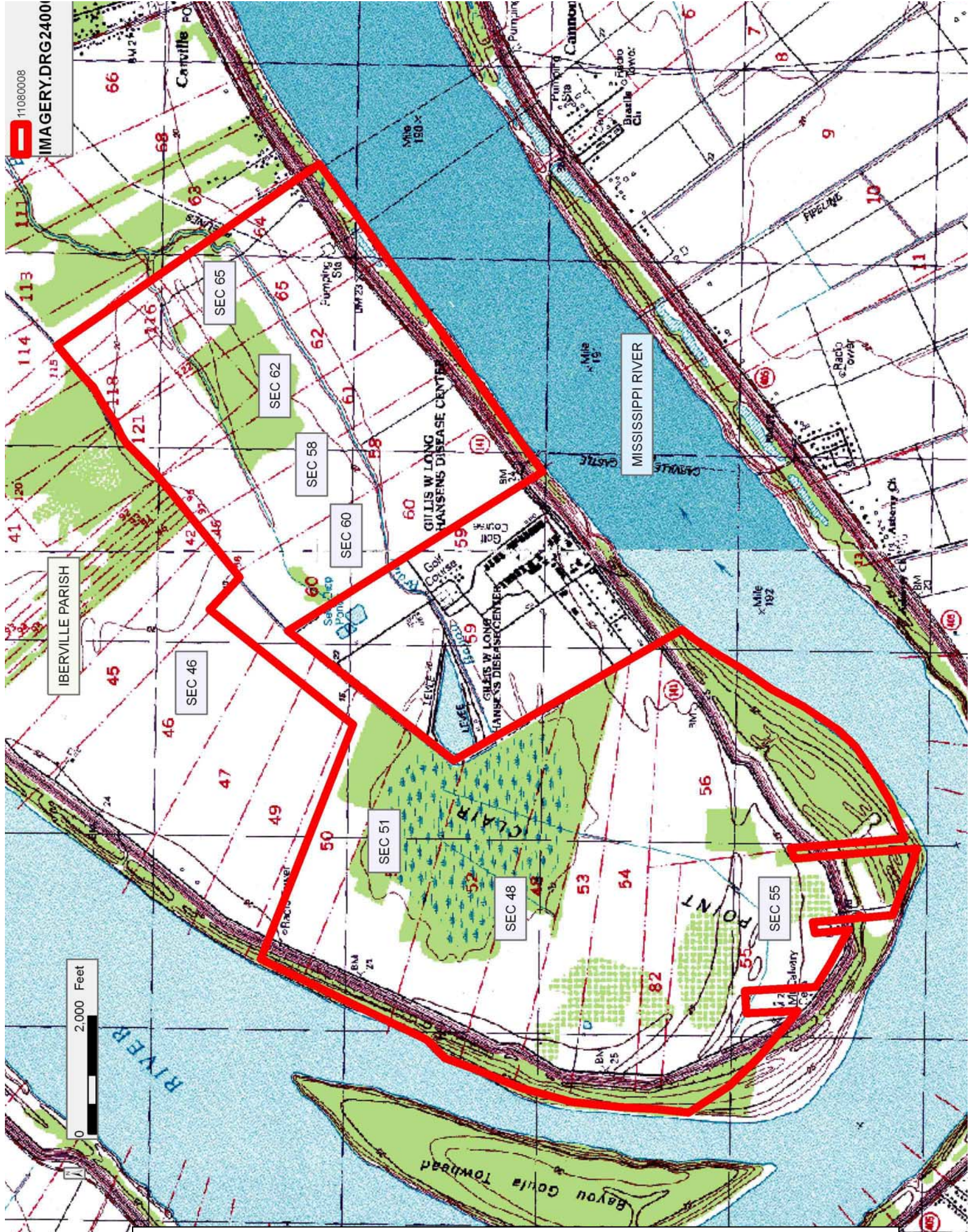

TRACT 42232 - Calcasieu Parish, Louisiana

All of the mineral rights only in a certain Tract of land, excluding the beds and bottoms of all navigable waters, belonging to and not presently under mineral lease from Calcasieu Parish School Board on August 10, 2011, being more fully described as follows: Five acres in the form of a square situated in the Northeast (NE) corner of Section Eighteen (18), Township Eleven (11) South, Range Eight (8) West, Calcasieu Parish, Louisiana, containing approximately **5 acres**, all as more particularly outlined on a plat on file in the Office of Mineral Resources, Department of Natural Resources. The description is based on information provided by the State Agency regarding location and ownership of surface and mineral rights. All bearings, distances and coordinates, if applicable, are based on Louisiana Coordinate System of 1927, (North or South Zone).

NOTE: The above description of the Tract nominated for lease has been provided and corrected, where required, exclusively by the nomination party. Any mineral lease selected from this Tract and awarded by the Louisiana State Mineral and Energy Board shall be without warranty of any kind, either express, implied, or statutory, including, but not limited to, the implied warranties of merchantability and fitness for a particular purpose. Should the mineral lease awarded by the Louisiana State Mineral and Energy Board be subsequently modified, cancelled or abrogated due to the existence of conflicting leases, operating agreements, private claims or other future obligations or conditions which may affect all or any portion of the leased Tract, it shall not relieve the Lessee of the obligation to pay any bonus due thereon to the Louisiana State Mineral and Energy Board, nor shall the Louisiana State Mineral and Energy Board be obligated to refund any consideration paid by the Lessor prior to such modification, cancellation, or abrogation, including, but not limited to, bonuses, rentals and royalties.

NOTE: No surface activity on this tract undertaken in conjunction with any operations under any mineral lease given on this tract will be allowed without prior approval of the surface owner and further, no such right of surface use shall be deemed to have been given as part of any mineral lease by the State of Louisiana on this tract.

Bidder	Cash Payment	Price/Acre	Rental	Oil	Gas	Other

Applicant: JORDAN OIL COMPANY, INC. to Agency and by Resolution from the Calcasieu Parish School Board authorizing the Mineral Board to act in its behalf

