

TRACT 42371 - Portion of Block 19, West Delta Area, Plaquemines Parish, Louisiana

The beds and bottoms of all water bodies belonging to the State of Louisiana located in Block 19, West Delta Area, together with any present lands formed by accretion to the shoreline or islands formed therein, located in Plaquemines Parish, Louisiana, owned by and not presently under mineral lease as of December 14, 2011, from the State of Louisiana, the geographical area of which is more fully described as follows: Beginning at a point on the West line of Block 19, West Delta Area, said point also being a point on the Three Mile Line, as decreed by the Supreme Court of the United States, as determined by a Special Master appointed therein, in litigation styled *United States v. State of Louisiana et al No. 9 Original*, in 1975, having Coordinates of X = 2,517,972.00 and Y = 191,639.61; thence North 9,924.20 feet along said West line of said Block 19, West Delta Area, to a point having Coordinates of X = 2,517,972.00 and Y = 201,563.81; thence East 10,450.00 feet to a point having Coordinates of X = 2,528,422.00 and Y = 201,563.81, said point being on the East line of said Block 19, West Delta Area; thence South 8,000.01 feet along said East line of said Block 19, West Delta Area, to a point on said Three Mile Line having Coordinates of X = 2,528,422.00 and Y = 193,563.80; thence Southwesterly along a straight line to the point of beginning, containing approximately **2,150 acres, LESS AND EXCEPT** that portion thereof, if any, lying seaward of the line three nautical miles from the coast line of Louisiana, as said three mile line has been decreed by the Supreme Court of the United States, as determined by a Special Master appointed therein, in litigation styled **United States v. State of Louisiana et al No. 9 Original**, in 1975, all as more particularly outlined on a plat in the Office of Mineral Resources, Department of Natural Resources. All bearings, distances and coordinates are based on the Louisiana Coordinate System of 1927, (South Zone).

NOTE: The above description of the Tract nominated for lease has been provided and corrected, where required, exclusively by the nomination party. Any mineral lease selected from this Tract and awarded by the Louisiana State Mineral and Energy Board shall be without warranty of any kind, either express, implied, or statutory, including, but not limited to, the implied warranties of merchantability and fitness for a particular purpose. Should the mineral lease awarded by the Louisiana State Mineral and Energy Board be subsequently modified, cancelled or abrogated due to the existence of conflicting leases, operating agreements, private claims or other future obligations or conditions which may affect all or any portion of the leased Tract, it shall not relieve the Lessee of the obligation to pay any bonus due thereon to the Louisiana State Mineral and Energy Board, nor shall the Louisiana State Mineral and Energy Board be obligated to refund any consideration paid by the Lessor prior to such modification, cancellation, or abrogation, including, but not limited to, bonuses, rentals and royalties.

NOTE: The State of Louisiana does hereby reserve, and this lease shall be subject to, the imprescriptible right of surface use in the nature of a

servitude in favor of the Department of Natural Resources, including its Offices and Commissions, for the sole purpose of implementing, constructing, servicing and maintaining approved coastal zone management and/or restoration projects. Utilization of any and all rights derived under this lease by the mineral lessee, its agents, successors or assigns, shall not interfere with nor hinder the reasonable surface use by the Department of Natural Resources, its Offices or Commissions, as herein above reserved.

Applicant: ROBERT A. SCHROEDER, INC.

Bidder	Cash Payment	Price/ Acre	Rental	Oil	Gas	Other

Legend

11120051

Blocks

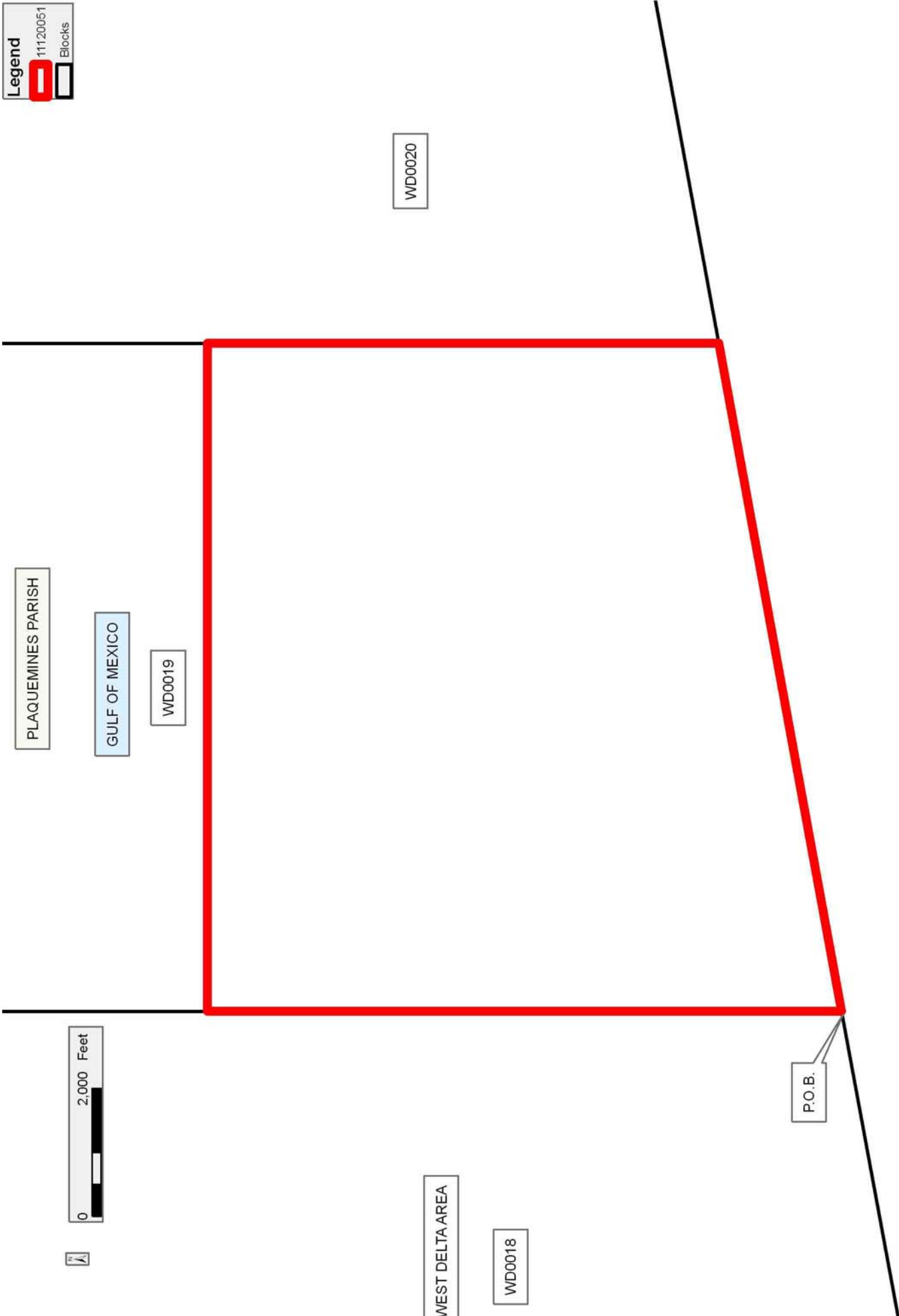

TRACT 42372 - Portion of Blocks 8, and 9, Grand Isle Area, Plaquemines Parish, Louisiana

The beds and bottoms of all water bodies belonging to the State of Louisiana located in Blocks 8, and 9, Grand Isle Area, together with any present lands formed by accretion to the shoreline or islands formed therein, located in Plaquemines Parish, Louisiana, owned by and not presently under mineral lease as of December 14, 2011, from the State of Louisiana, the geographical area of which is more fully described as follows: Beginning at the Southeast corner of Block 9, Grand Isle Area, having Coordinates of X = 2,472,417.93 and Y = 185,535.39; thence West 6,592.93 feet along the South line of said of Block 9, Grand Isle Area, to a point being the Southeast corner of State Lease No. 797, as amended, having Coordinates of X = 2,465,825.00 and Y = 185,535.39; thence along the Eastern and Northern boundaries of said State Lease No. 797, as amended, the following courses: North 22 degrees 25 minutes 16 seconds East 7,826.23 feet to a point having Coordinates of X = 2,468,810.00 and Y = 192,770.00; North 3,575.00 feet to a point having Coordinates of X = 2,468,810.00 and Y = 196,345.00; North 35 degrees 11 minutes 49 seconds West 4,831.80 feet to a point having Coordinates of X = 2,466,025.00 and Y = 200,293.43; and West 1,782.17 feet to a point on the Louisiana Coastline, as decreed by the Supreme Court of the United States, as determined by a Special Master appointed therein, in litigation styled *United States v. State of Louisiana et al No. 9 Original*, in 1975, having Coordinates of X = 2,464,242.83 and Y = 200,293.43; thence Northeasterly along a straight line along said Louisiana Coastline to a point on the East line of said Block 8, Grand Isle Area having Coordinates of X = 2,472,417.93 and Y = 201,798.72; thence South 1,505.29 feet along said East line of said Block 8, Grand Isle Area, to its Southeast corner having Coordinates of X = 2,472,417.93 and Y = 200,293.43, said point also being the Northeast corner of said Block 9, Grand Isle Area; thence South 13,932.93 feet along said East line of said of Block 9, Grand Isle Area, to a point having Coordinates of X = 2,472,417.93 and Y = 186,360.50, said point being the Southwest corner of Block 14, West Delta Area; thence South 825.11 feet along said East line of said of Block 9, Grand Isle Area, to the point of beginning, containing approximately **1,737.71 acres**, all as more particularly outlined on a plat on file in the Office of Mineral Resources, Department of Natural Resources. All bearings, distances and coordinates are based on Louisiana Coordinate System of 1927, (North or South Zone).

NOTE: The above description of the Tract nominated for lease has been provided and corrected, where required, exclusively by the nomination party. Any mineral lease selected from this Tract and awarded by the Louisiana State Mineral and Energy Board shall be without warranty of any kind, either express, implied, or statutory, including, but not limited to, the implied warranties of merchantability and fitness for a particular purpose. Should the mineral lease awarded by the Louisiana State Mineral and Energy Board be subsequently modified, cancelled or abrogated due to the existence of conflicting leases, operating agreements, private claims

or other future obligations or conditions which may affect all or any portion of the leased Tract, it shall not relieve the Lessee of the obligation to pay any bonus due thereon to the Louisiana State Mineral and Energy Board, nor shall the Louisiana State Mineral and Energy Board be obligated to refund any consideration paid by the Lessor prior to such modification, cancellation, or abrogation, including, but not limited to, bonuses, rentals and royalties.

NOTE: The State of Louisiana does hereby reserve, and this lease shall be subject to, the imprescriptible right of surface use in the nature of a servitude in favor of the Department of Natural Resources, including its Offices and Commissions, for the sole purpose of implementing, constructing, servicing and maintaining approved coastal zone management and/or restoration projects. Utilization of any and all rights derived under this lease by the mineral lessee, its agents, successors or assigns, shall not interfere with nor hinder the reasonable surface use by the Department of Natural Resources, its Offices or Commissions, as herein above reserved.

Applicant: ROBERT A. SCHROEDER, INC.

Bidder	Cash Payment	Price/ Acre	Rental	Oil	Gas	Other

Legend

- 11120056
- Blocks
- Active_Leases



TRACT 42373 - Portion of Block 18, West Delta Area, Plaquemines Parish, Louisiana

The beds and bottoms of all water bodies belonging to the State of Louisiana located in Block 18, West Delta Area, together with any present lands formed by accretion to the shoreline or islands formed therein, located in Plaquemines Parish, Louisiana, owned by and not presently under mineral lease as of December 14, 2011, from the State of Louisiana, the geographical area of which is more fully described as follows: Beginning at a point on the West line of Block 18, West Delta Area, a point on the Three Mile Line, as decreed by the Supreme Court of the United States, as determined by a Special Master appointed therein, in litigation styled *United States v. State of Louisiana et al No. 9 Original*, in 1975, having Coordinates X = 2,507,522.00 and Y = 189,715.42; thence North 9,924.20 feet along said West line of said Block 18, West Delta Area, to a point having Coordinates of X = 2,507,522.00 and Y = 199,639.62; thence East 10,450.00 feet to a point having Coordinates of X = 2,517,972.00 and Y = 199,639.62, said point being on the East line of said Block 18, West Delta Area; thence South 8,000.01 feet along said East line of said Block 18, West Delta Area, to a point on said Three Mile Line having Coordinates of X = 2,517,972.00 and Y = 191,639.61; thence Southwesterly along a straight line to the point of beginning, containing approximately **2,150 acres, LESS AND EXCEPT** that portion thereof, if any, lying seaward of the line three nautical miles from the coast line of Louisiana, as said three mile line has been decreed by the Supreme Court of the United States, as determined by a Special Master appointed therein, in litigation styled **United States v. State of Louisiana et al No. 9 Original**, in 1975, all as more particularly outlined on a plat in the Office of Mineral Resources, Department of Natural Resources. All bearings, distances and coordinates are based on the Louisiana Coordinate System of 1927, (South Zone).

NOTE: The above description of the Tract nominated for lease has been provided and corrected, where required, exclusively by the nomination party. Any mineral lease selected from this Tract and awarded by the Louisiana State Mineral and Energy Board shall be without warranty of any kind, either express, implied, or statutory, including, but not limited to, the implied warranties of merchantability and fitness for a particular purpose. Should the mineral lease awarded by the Louisiana State Mineral and Energy Board be subsequently modified, cancelled or abrogated due to the existence of conflicting leases, operating agreements, private claims or other future obligations or conditions which may affect all or any portion of the leased Tract, it shall not relieve the Lessee of the obligation to pay any bonus due thereon to the Louisiana State Mineral and Energy Board, nor shall the Louisiana State Mineral and Energy Board be obligated to refund any consideration paid by the Lessor prior to such modification, cancellation, or abrogation, including, but not limited to, bonuses, rentals and royalties.

NOTE: The State of Louisiana does hereby reserve, and this lease shall be subject to, the imprescriptible right of surface use in the nature of a

servitude in favor of the Department of Natural Resources, including its Offices and Commissions, for the sole purpose of implementing, constructing, servicing and maintaining approved coastal zone management and/or restoration projects. Utilization of any and all rights derived under this lease by the mineral lessee, its agents, successors or assigns, shall not interfere with nor hinder the reasonable surface use by the Department of Natural Resources, its Offices or Commissions, as herein above reserved.

Applicant: ROBERT A. SCHROEDER, INC.

Bidder	Cash Payment	Price/ Acre	Rental	Oil	Gas	Other

PLAQUEMINES PARISH

WD0018

WD0019

WD00017

GULF OF MEXICO

WEST DELTA AREA

P.O.B.



TRACT 42374 - Portion of Block 9, Grand Isle Area, Plaquemines Parish, Louisiana

The beds and bottoms of all water bodies belonging to the State of Louisiana located in Block 9, Grand Isle Area, together with any present lands formed by accretion to the shoreline or islands formed therein, located in Plaquemines Parish, Louisiana, owned by and not presently under mineral lease as of December 14, 2011, from the State of Louisiana, the geographical area of which is more fully described as follows: Beginning at the Southwest corner of Block 9, Grand Isle Area, having Coordinates of X = 2,457,659.89 and Y = 185,535.39; thence North 13,545.91 feet along the West line of said of Block 9, Grand Isle Area to a point on the Louisiana Coastline, as decreed by the Supreme Court of the United States, as determined by a Special Master appointed therein, in litigation styled *United States v. State of Louisiana et al No. 9 Original*, in 1975, having Coordinates of X = 2,457,659.89 and Y = 199,081.30; thence Northeasterly along a straight along said Louisiana Coastline to a point having Coordinates of X = 2,463,412.23 and Y = 200,140.49, said point being on the Western boundary of State Lease No. 797, as amended; thence along the Western boundary of said State Lease No. 797, as amended, the following courses: South 2,977.49 feet to a point having Coordinates of X = 2,463,412.23 and Y = 197,163.00; East 1,331.69 feet to a point having Coordinates of X = 2,464,743.92 and Y = 197,163.00; South 6,125.19 feet to a point having Coordinates of X = 2,464,743.92 and Y = 191,037.81; and South 25 degrees 26 minutes 42 seconds West 6,093.51 feet to a point being its Southwest corner having Coordinates of X = 2,462,125.87 and Y = 185,535.39, said point also being on the South line of said Block 9, Grand Isle Area; thence West 4,465.98 feet along said South line of said of Block 9, Grand Isle Area, to the point of beginning, containing approximately **2,048.87 acres**, all as more particularly outlined on a plat on file in the Office of Mineral Resources, Department of Natural Resources. All bearings, distances and coordinates are based on Louisiana Coordinate System of 1927, (North or South Zone).

NOTE: The above description of the Tract nominated for lease has been provided and corrected, where required, exclusively by the nomination party. Any mineral lease selected from this Tract and awarded by the Louisiana State Mineral and Energy Board shall be without warranty of any kind, either express, implied, or statutory, including, but not limited to, the implied warranties of merchantability and fitness for a particular purpose. Should the mineral lease awarded by the Louisiana State Mineral and Energy Board be subsequently modified, cancelled or abrogated due to the existence of conflicting leases, operating agreements, private claims or other future obligations or conditions which may affect all or any portion of the leased Tract, it shall not relieve the Lessee of the obligation to pay any bonus due thereon to the Louisiana State Mineral and Energy Board, nor shall the Louisiana State Mineral and Energy Board be obligated to refund any consideration paid by the Lessor prior to such modification, cancellation, or abrogation, including, but not limited to, bonuses, rentals and royalties.

NOTE: The State of Louisiana does hereby reserve, and this lease shall be subject to, the imprescriptible right of surface use in the nature of a servitude in favor of the Department of Natural Resources, including its Offices and Commissions, for the sole purpose of implementing, constructing, servicing and maintaining approved coastal zone management and/or restoration projects. Utilization of any and all rights derived under this lease by the mineral lessee, its agents, successors or assigns, shall not interfere with nor hinder the reasonable surface use by the Department of Natural Resources, its Offices or Commissions, as herein above reserved.

Applicant: ROBERT A. SCHROEDER, INC.

Bidder	Cash Payment	Price/ Acre	Rental	Oil	Gas	Other

Legend

11120054

Blocks

Active_Leases

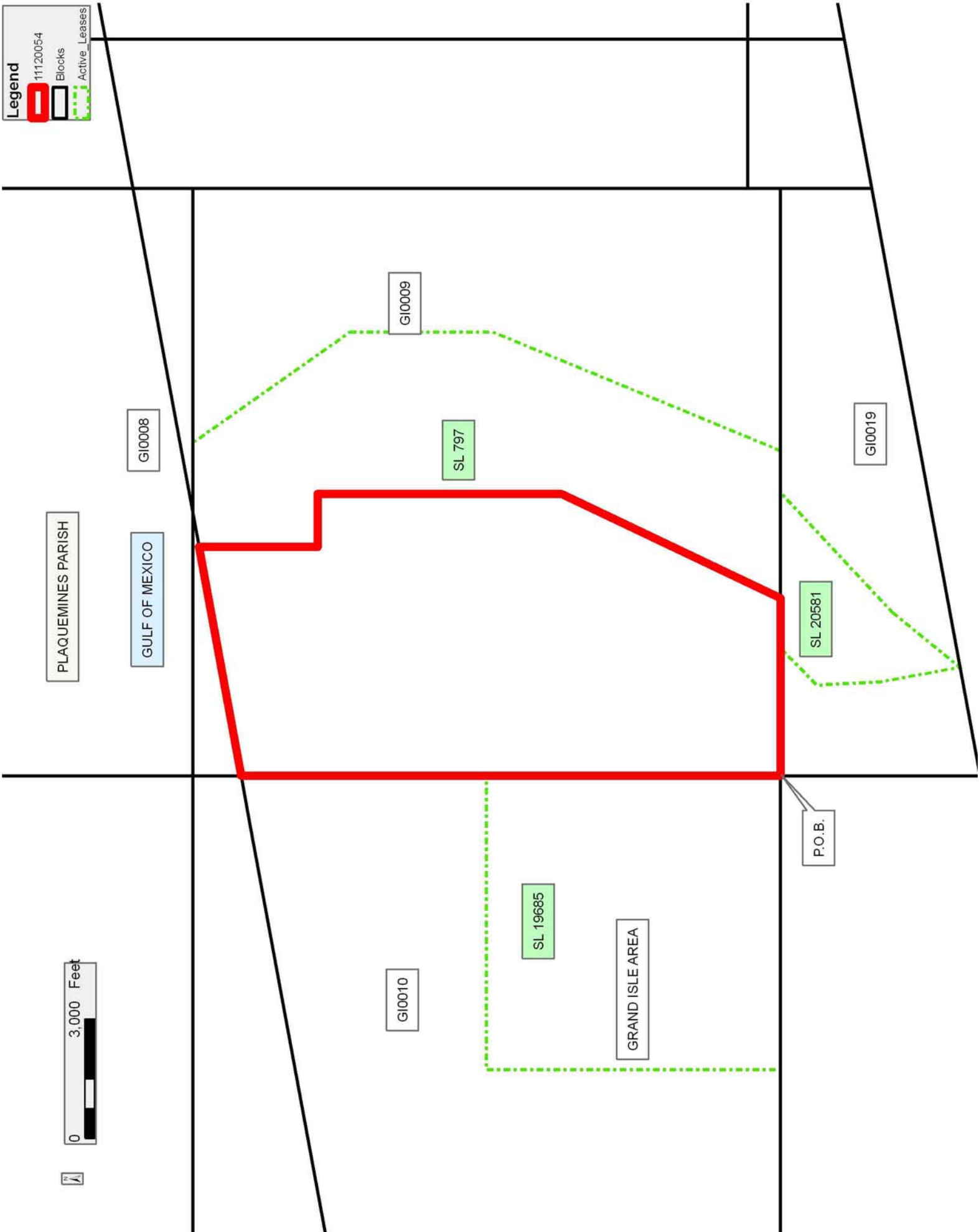

TRACT 42375 - Portion of Block 10, Grand Isle Area, Jefferson and Plaquemines Parishes, Louisiana

The beds and bottoms of all water bodies belonging to the State of Louisiana located in Block 10, Grand Isle Area, together with any present lands formed by accretion to the shoreline or islands formed therein, located in Jefferson and Plaquemines Parishes, Louisiana, owned by and not presently under mineral lease as of December 14, 2011, from the State of Louisiana, the geographical area of which is more fully described as follows: Beginning at a point on the East line of Block 10, Grand Isle Area, having Coordinates of X = 2,457,659.89 and Y = 199,081.30, said point being on the Louisiana Coastline, as decreed by the Supreme Court of the United States, as determined by a Special Master appointed therein, in litigation styled *United States v. State of Louisiana et al No. 9 Original*, in 1975; thence South 6,166.89 feet along said East line of said Block 10, Grand Isle Area, to a point being the Northeast corner of State Lease No. 19685 having Coordinates of X = 2,457,659.89 and Y = 192,914.41; thence West 7,379.02 feet along the Northern boundary of said State Lease No. 19685 to its Northwest corner having Coordinates of X = 2,450,280.87 and Y = 192,914.41, said point also being the Northeast corner of State of Louisiana State Lease No. 19428; thence West 4,770.87 feet along the Northern boundary of said State Lease No. 19428 to a point being the Southeast corner of State Lease No. 19681 having Coordinates of X = 2,445,510.00 and Y = 192,914.41; thence North 3,929.72 feet along the Eastern boundary of said State Lease No. 19681 to its Northeast corner having Coordinates of X = 2,445,510.00 and Y = 196,844.13, said point also being on said Louisiana Coastline; thence Northeasterly along a straight line along said Louisiana Coastline to the point of beginning, containing approximately **1,408.09 acres**, all as more particularly outlined on a plat on file in the Office of Mineral Resources, Department of Natural Resources. All bearings, distances and coordinates are based on Louisiana Coordinate System of 1927, (North or South Zone).

NOTE: The above description of the Tract nominated for lease has been provided and corrected, where required, exclusively by the nomination party. Any mineral lease selected from this Tract and awarded by the Louisiana State Mineral and Energy Board shall be without warranty of any kind, either express, implied, or statutory, including, but not limited to, the implied warranties of merchantability and fitness for a particular purpose. Should the mineral lease awarded by the Louisiana State Mineral and Energy Board be subsequently modified, cancelled or abrogated due to the existence of conflicting leases, operating agreements, private claims or other future obligations or conditions which may affect all or any portion of the leased Tract, it shall not relieve the Lessee of the obligation to pay any bonus due thereon to the Louisiana State Mineral and Energy Board, nor shall the Louisiana State Mineral and Energy Board be obligated to refund any consideration paid by the Lessor prior to such modification, cancellation, or abrogation, including, but not limited to, bonuses, rentals and royalties.

NOTE: The State of Louisiana does hereby reserve, and this lease shall be subject to, the imprescriptible right of surface use in the nature of a servitude in favor of the Department of Natural Resources, including its Offices and Commissions, for the sole purpose of implementing, constructing, servicing and maintaining approved coastal zone management and/or restoration projects. Utilization of any and all rights derived under this lease by the mineral lessee, its agents, successors or assigns, shall not interfere with nor hinder the reasonable surface use by the Department of Natural Resources, its Offices or Commissions, as herein above reserved.

Applicant: ROBERT A. SCHROEDER, INC.

Bidder	Cash Payment	Price/ Acre	Rental	Oil	Gas	Other

Legend

- 11120053
- Blocks
- Active_Leases
- Counties

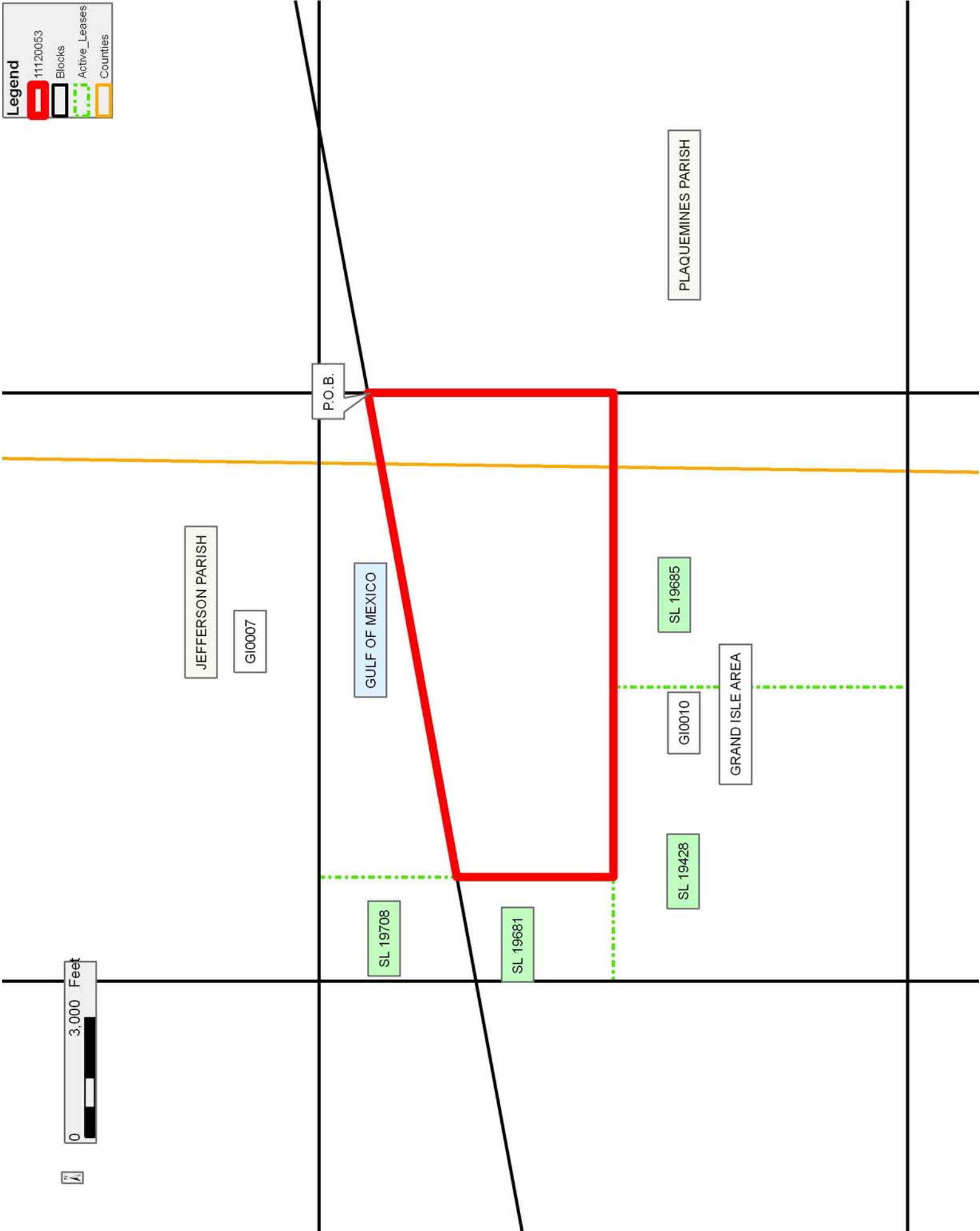

TRACT 42376 - Portion of Block 17, West Delta Area, Plaquemines Parish, Louisiana

The beds and bottoms of all water bodies belonging to the State of Louisiana located in Block 17, West Delta Area, together with any present lands formed by accretion to the shoreline or islands formed therein, located in Plaquemines Parish, Louisiana, owned by and not presently under mineral lease as of December 14, 2011, from the State of Louisiana, the geographical area of which is more fully described as follows: Beginning at a point on the West line of Block 17, West Delta Area, said point also being a point on the Three Mile Line, as decreed by the Supreme Court of the United States, as determined by a Special Master appointed therein, in litigation styled *United States v. State of Louisiana et al No. 9 Original*, in 1975, having Coordinates of X = 2,497,072.00 and Y = 187,791.23; thence North 9,924.20 feet along said West line of said Block 17, West Delta Area, to a point having Coordinates of X = 2,497,072.00 and Y = 197,715.43; thence East 10,450.00 feet to a point having Coordinates of X = 2,507,522.00 and Y = 197,715.43, said point being on the East line of said Block 17, West Delta Area; thence South 8,000.01 feet along said East line of said Block 17, West Delta Area, to a point having Coordinates of X = 2,507,522.00 and Y = 189,715.42, said point being on said Three Mile Line; thence Southwesterly along a straight line to the point of beginning, containing approximately **2,150 acres, LESS AND EXCEPT** that portion thereof, if any, lying seaward of the line three nautical miles from the coast line of Louisiana, as said three mile line has been decreed by the Supreme Court of the United States, as determined by a Special Master appointed therein, in litigation styled **United States v. State of Louisiana et al No. 9 Original**, in 1975, all as more particularly outlined on a plat in the Office of Mineral Resources, Department of Natural Resources. All bearings, distances and coordinates are based on the Louisiana Coordinate System of 1927, (South Zone).

NOTE: The above description of the Tract nominated for lease has been provided and corrected, where required, exclusively by the nomination party. Any mineral lease selected from this Tract and awarded by the Louisiana State Mineral and Energy Board shall be without warranty of any kind, either express, implied, or statutory, including, but not limited to, the implied warranties of merchantability and fitness for a particular purpose. Should the mineral lease awarded by the Louisiana State Mineral and Energy Board be subsequently modified, cancelled or abrogated due to the existence of conflicting leases, operating agreements, private claims or other future obligations or conditions which may affect all or any portion of the leased Tract, it shall not relieve the Lessee of the obligation to pay any bonus due thereon to the Louisiana State Mineral and Energy Board, nor shall the Louisiana State Mineral and Energy Board be obligated to refund any consideration paid by the Lessor prior to such modification, cancellation, or abrogation, including, but not limited to, bonuses, rentals and royalties.

NOTE: The State of Louisiana does hereby reserve, and this lease shall be subject to, the imprescriptible right of surface use in the nature of a servitude in favor of the Department of Natural Resources, including its Offices and Commissions, for the sole purpose of implementing, constructing, servicing and maintaining approved coastal zone management and/or restoration projects. Utilization of any and all rights derived under this lease by the mineral lessee, its agents, successors or assigns, shall not interfere with nor hinder the reasonable surface use by the Department of Natural Resources, its Offices or Commissions, as herein above reserved.

Applicant: ROBERT A. SCHROEDER, INC.

Bidder	Cash Payment	Price/ Acre	Rental	Oil	Gas	Other

Legend

11120061

Blocks

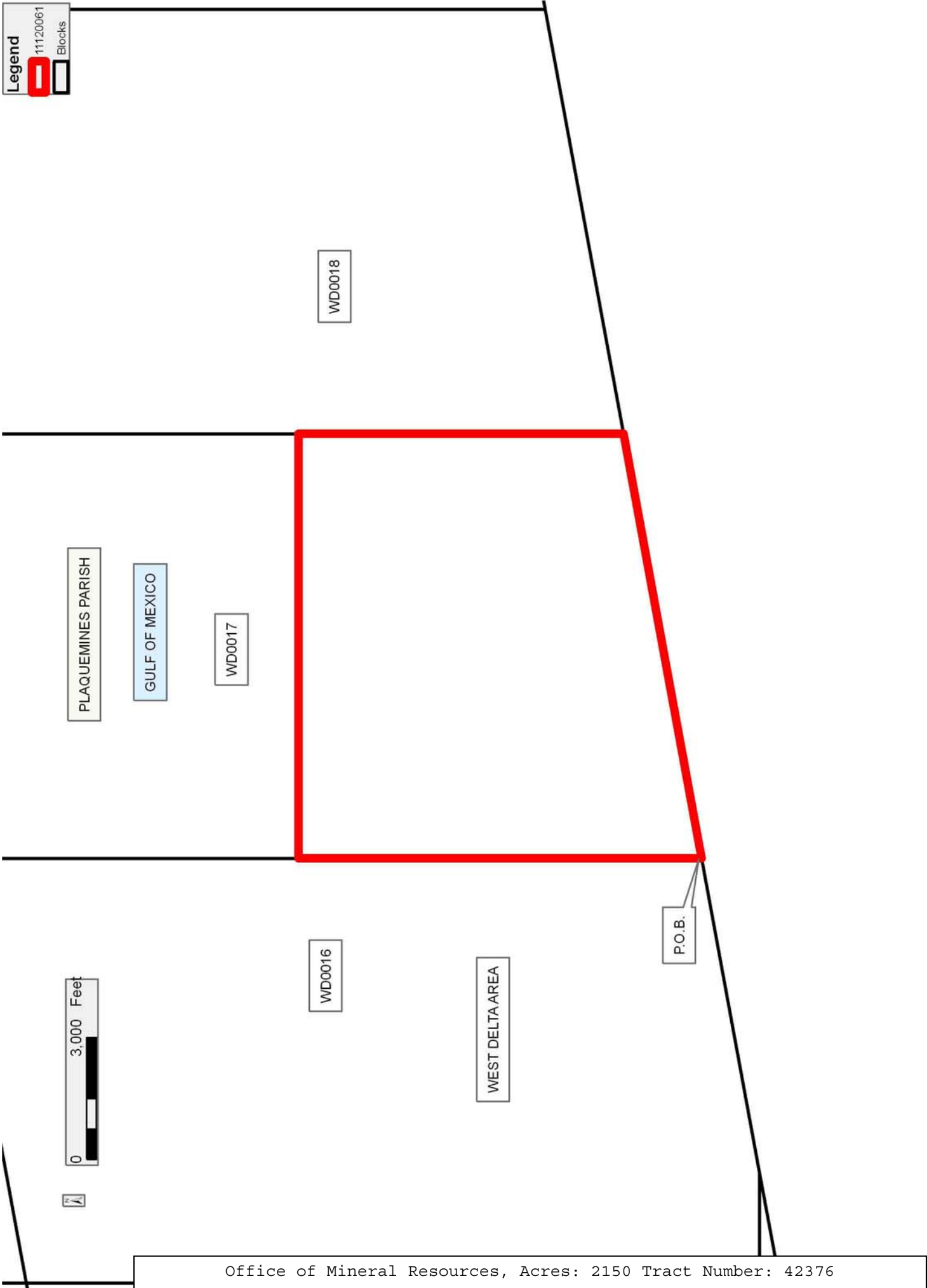

TRACT 42377 - Portion of Blocks 16, and 35, West Delta Area, Plaquemines Parish, Louisiana

The beds and bottoms of all water bodies belonging to the State of Louisiana located in Blocks 16, and 35, West Delta Area, together with any present lands formed by accretion to the shoreline or islands formed therein, located in Plaquemines Parish, Louisiana, owned by and not presently under mineral lease as of December 14, 2011, from the State of Louisiana, the geographical area of which is more fully described as follows: Beginning at the Southwest corner of Block 16, West Delta Area, having Coordinates of X = 2,486,622.00 and Y = 186,360.50; thence North 9,430.73 feet along the West line of said Block 16, West Delta Area, to a point having Coordinates of X = 2,486,622.00 and Y = 195,791.23; thence East 10,450.00 feet to a point having Coordinates of X = 2,497,072.00 and Y = 195,791.23, said point being on the East line of said Block 16, West Delta Area; thence South 8,000.00 feet along said East line of said Block 16, West Delta Area, to a point on the Three Mile Line, as decreed by the Supreme Court of the United States, as determined by a Special Master appointed therein, in litigation styled *United States v. State of Louisiana et al No. 9 Original*, in 1975, having Coordinates of X = 2,497,072.00 and Y = 187,791.23; thence along said Three Mile Line the following courses: Southwesterly along a straight line to a point having Coordinates of X = 2,489,301.88 and Y = 186,360.50, and Southwesterly along a straight line to a point having Coordinates of X = 2,486,622.00 and Y = 185,867.05, said point being on the West line of said Block 35, West Delta Area; thence North 493.45 feet on and along said West line of said Block 35, West Delta Area, to the point of beginning, containing approximately **2,150 acres, LESS AND EXCEPT** that portion thereof, if any, lying seaward of the line three nautical miles from the coast line of Louisiana, as said three mile line has been decreed by the Supreme Court of the United States, as determined by a Special Master appointed therein, in litigation styled **United States v. State of Louisiana et al No. 9 Original**, in 1975, all as more particularly outlined on a plat in the Office of Mineral Resources, Department of Natural Resources. All bearings, distances and coordinates are based on the Louisiana Coordinate System of 1927, (South Zone).

NOTE: The above description of the Tract nominated for lease has been provided and corrected, where required, exclusively by the nomination party. Any mineral lease selected from this Tract and awarded by the Louisiana State Mineral and Energy Board shall be without warranty of any kind, either express, implied, or statutory, including, but not limited to, the implied warranties of merchantability and fitness for a particular purpose. Should the mineral lease awarded by the Louisiana State Mineral and Energy Board be subsequently modified, cancelled or abrogated due to the existence of conflicting leases, operating agreements, private claims or other future obligations or conditions which may affect all or any portion of the leased Tract, it shall not relieve the Lessee of the obligation to pay any bonus due thereon to the Louisiana State Mineral and Energy Board, nor shall the Louisiana State Mineral and Energy Board be

obligated to refund any consideration paid by the Lessor prior to such modification, cancellation, or abrogation, including, but not limited to, bonuses, rentals and royalties.

NOTE: The State of Louisiana does hereby reserve, and this lease shall be subject to, the imprescriptible right of surface use in the nature of a servitude in favor of the Department of Natural Resources, including its Offices and Commissions, for the sole purpose of implementing, constructing, servicing and maintaining approved coastal zone management and/or restoration projects. Utilization of any and all rights derived under this lease by the mineral lessee, its agents, successors or assigns, shall not interfere with nor hinder the reasonable surface use by the Department of Natural Resources, its Offices or Commissions, as herein above reserved.

Applicant: ROBERT A. SCHROEDER, INC.

Bidder	Cash Payment	Price/ Acre	Rental	Oil	Gas	Other

Legend

11120060

Blocks

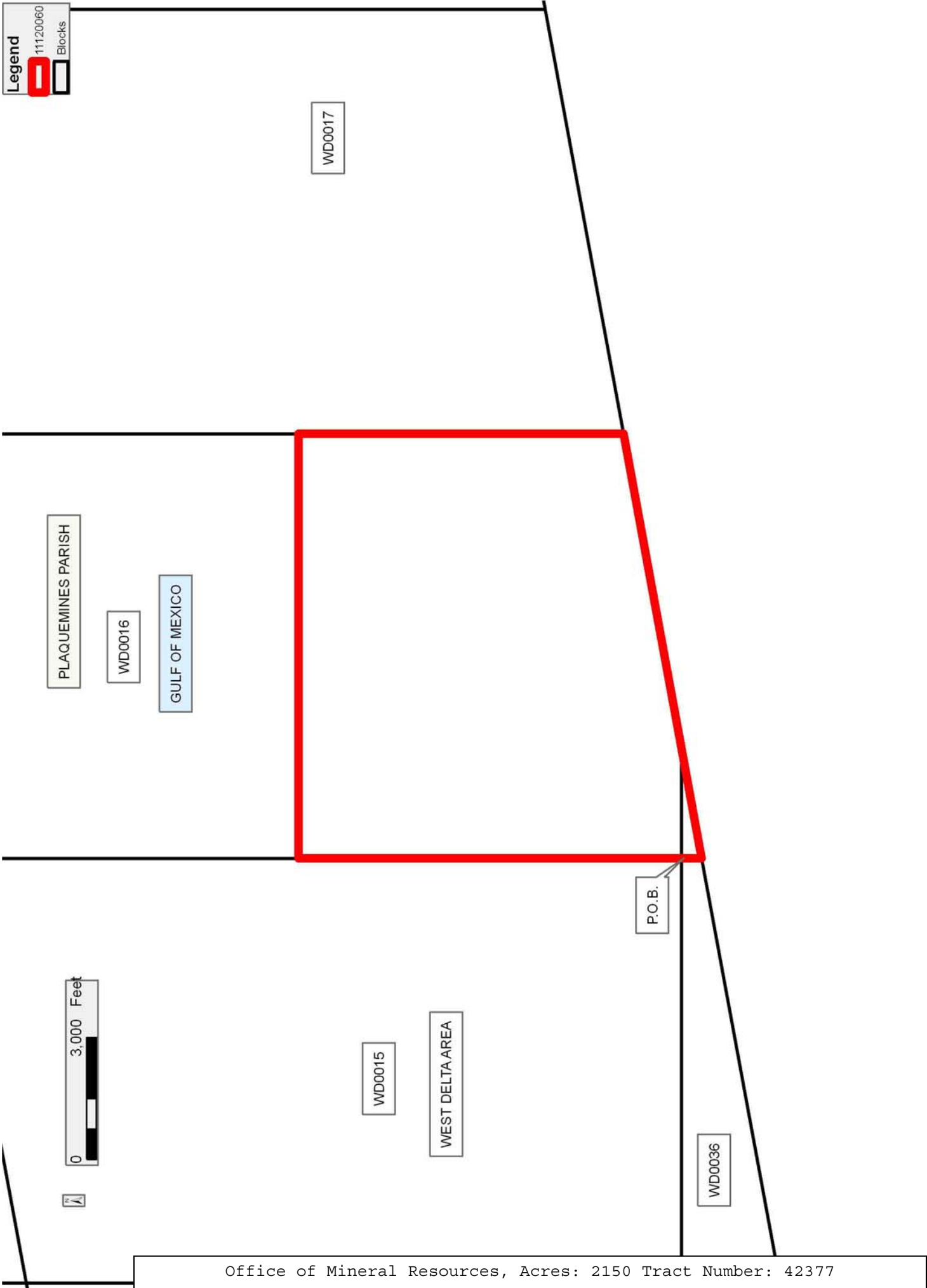

TRACT 42378 - Portion of Block 11, Grand Isle Area, Jefferson Parish, Louisiana

The beds and bottoms of all water bodies belonging to the State of Louisiana located in Block 11, Grand Isle Area, together with any present lands formed by accretion to the shoreline or islands formed therein, located in Jefferson Parish, Louisiana, owned by and not presently under mineral lease as of December 14, 2011, from the State of Louisiana, the geographical area of which is more fully described as follows: Beginning at a the Southeast corner of Block 11, Grand Isle Area, having Coordinates of X = 2,442,901.85 and Y = 185,535.39; thence West 7,379.02 feet along the South line of said Block 11, Grand Isle Area, to a point having Coordinates of X = 2,435,522.83 and Y = 185,535.39; thence North 9,469.80 feet to a point on the Louisiana Coastline, as decreed by the Supreme Court of the United States, as determined by a Special Master appointed therein, in litigation styled *United States v. State of Louisiana et al No. 9 Original*, in 1975, having Coordinates of X = 2,435,522.83 and Y = 195,005.19, said point also being the Southwest corner of State Lease No. 19707; thence Northeasterly along a straight line along said Louisiana Coastline to a point having Coordinates of X = 2,438,922.83 and Y = 195,631.23, said point being the Northwest corner of State Lease No. 19682; thence along the Western and Southern boundaries of said State Lease No. 19682 the following courses: South 4,375.27 feet to a point having Coordinates of X = 2,438,922.83 and Y = 191,255.96, and East 3,979.02 feet to a point being its Southeast corner having Coordinates of X = 2,442,901.85 and Y = 191,255.96, said point being on the East line of said Block 11, Grand Isle Area; thence South 5,720.57 feet along said East line of said Block 11, Grand Isle Area, to the point of beginning, containing approximately **1,286.13 acres**, all as more particularly outlined on a plat on file in the Office of Mineral Resources, Department of Natural Resources. All bearings, distances and coordinates are based on Louisiana Coordinate System of 1927, (North or South Zone).

NOTE: The above description of the Tract nominated for lease has been provided and corrected, where required, exclusively by the nomination party. Any mineral lease selected from this Tract and awarded by the Louisiana State Mineral and Energy Board shall be without warranty of any kind, either express, implied, or statutory, including, but not limited to, the implied warranties of merchantability and fitness for a particular purpose. Should the mineral lease awarded by the Louisiana State Mineral and Energy Board be subsequently modified, cancelled or abrogated due to the existence of conflicting leases, operating agreements, private claims or other future obligations or conditions which may affect all or any portion of the leased Tract, it shall not relieve the Lessee of the obligation to pay any bonus due thereon to the Louisiana State Mineral and Energy Board, nor shall the Louisiana State Mineral and Energy Board be obligated to refund any consideration paid by the Lessor prior to such modification, cancellation, or abrogation, including, but not limited to, bonuses, rentals and royalties.

NOTE: The State of Louisiana does hereby reserve, and this lease shall be subject to, the imprescriptible right of surface use in the nature of a servitude in favor of the Department of Natural Resources, including its Offices and Commissions, for the sole purpose of implementing, constructing, servicing and maintaining approved coastal zone management and/or restoration projects. Utilization of any and all rights derived under this lease by the mineral lessee, its agents, successors or assigns, shall not interfere with nor hinder the reasonable surface use by the Department of Natural Resources, its Offices or Commissions, as herein above reserved.

Applicant: ROBERT A. SCHROEDER, INC.

Bidder	Cash Payment	Price/ Acre	Rental	Oil	Gas	Other

Legend

11120050

Blocks

Active_Leases

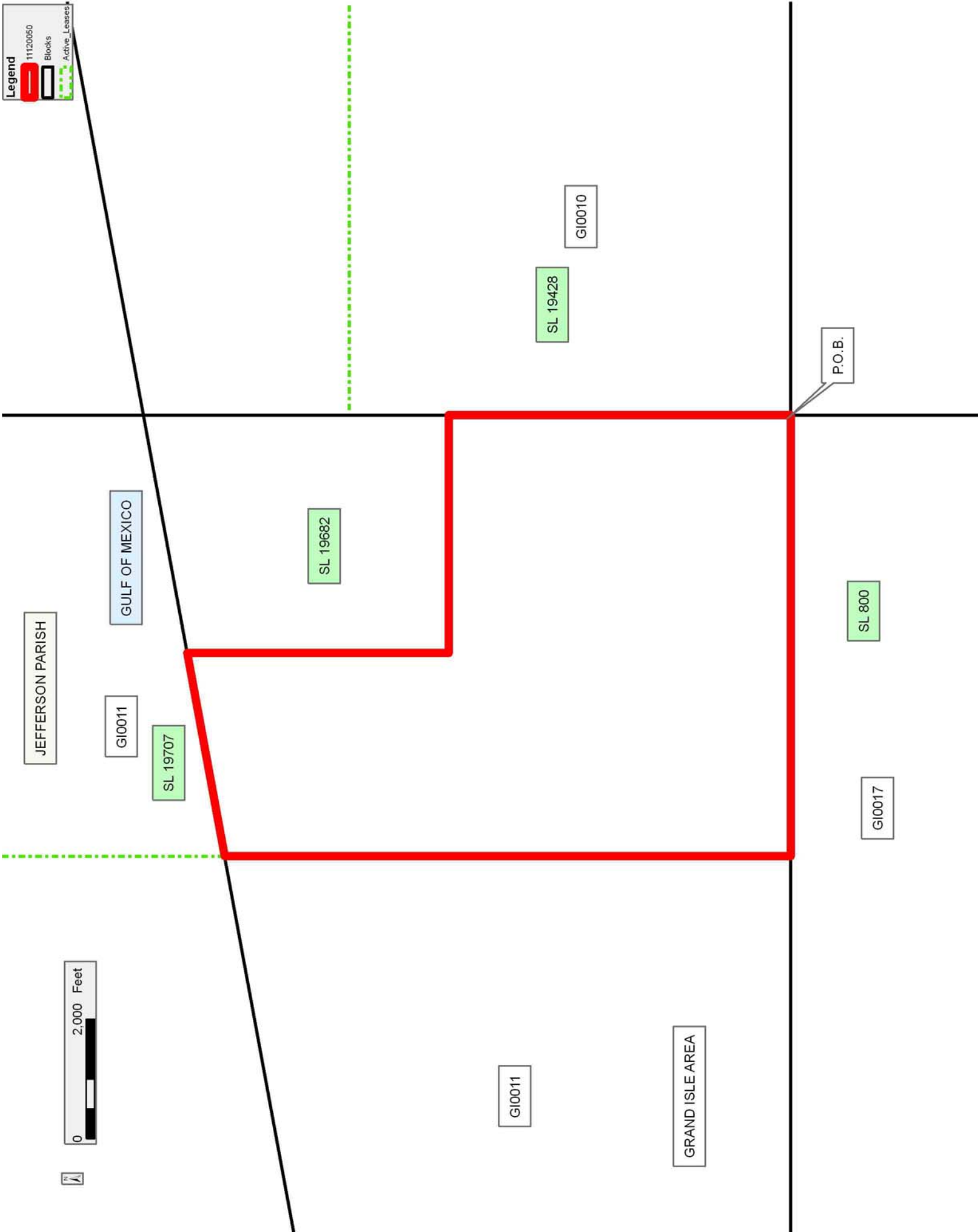

TRACT 42379 - Portion of Blocks 11, and 12, Grand Isle Area, Jefferson Parish, Louisiana

The beds and bottoms of all water bodies belonging to the State of Louisiana located in Blocks 11, and 12, Grand Isle Area, together with any present lands formed by accretion to the shoreline or islands formed therein, located in Jefferson Parish, Louisiana, owned by and not presently under mineral lease as of December 14, 2011, from the State of Louisiana, the geographical area of which is more fully described as follows: Beginning at the Southwest corner of Block 11, Grand Isle Area, having Coordinates of X = 2,428,143.81 and Y = 185,535.39, said point also being the Southeast corner of State Lease No. 14031, as amended; thence along the Eastern and Northern boundaries of said State Lease No. 14031, as amended, the following courses: North 2,038.12 feet to a point having Coordinates of X = 2,428,143.81 and Y = 187,573.51, and West 2,031.91 feet to a point having Coordinates of X = 2,426,111.90 and Y = 187,573.51, said point being a Southeast corner of State Lease No. 18737; thence North 4,100.00 feet along the Eastern boundary of said State Lease No. 18727 to its Northeast corner having Coordinates of X = 2,426,111.90 and Y = 191,673.51, said point also being on the Southern boundary of State Lease No. 19684; thence East 2,031.91 feet along the Southern boundary of said State Lease No. 19684 to its Southeast corner having Coordinates of X = 2,428,143.81 and Y = 191,673.51, said point also being the Southwest corner of State Lease No. 19683; thence along the Southern and Eastern boundaries of said State Lease No. 19683 the following courses: East 3,468.09 feet to a point having Coordinates of X = 2,431,611.90 and Y = 191,673.51 and, North 2,611.55 feet to a point being the Northeast corner of said State Lease No. 19683 having Coordinates of X = 2,431,611.90 and Y = 194,285.06, said point also being on the Louisiana Coastline, as decreed by the Supreme Court of the United States, as determined by a Special Master appointed therein, in litigation styled *United States v. State of Louisiana et al No. 9 Original*, in 1975; thence Northeasterly along a straight line to a point being the Southwest corner of State Lease No. 19707 having Coordinates of X = 2,435,522.83 and Y = 195,005.19; thence South 9,469.80 feet to a point being on the South line of said Block 11, Grand Isle Area having Coordinates of X = 2,435,522.83 and Y = 185,535.39; thence West 7,379.02 feet along said South line of said Block 11, Grand Isle Area, to the point of beginning, containing approximately **1,497.84 acres**, all as more particularly outlined on a plat on file in the Office of Mineral Resources, Department of Natural Resources. All bearings, distances and coordinates are based on Louisiana Coordinate System of 1927, (North or South Zone).

NOTE: The above description of the Tract nominated for lease has been provided and corrected, where required, exclusively by the nomination party. Any mineral lease selected from this Tract and awarded by the Louisiana State Mineral and Energy Board shall be without warranty of any kind, either express, implied, or statutory, including, but not limited to, the implied warranties of merchantability and fitness for a particular purpose. Should the mineral lease awarded by the Louisiana State Mineral

and Energy Board be subsequently modified, cancelled or abrogated due to the existence of conflicting leases, operating agreements, private claims or other future obligations or conditions which may affect all or any portion of the leased Tract, it shall not relieve the Lessee of the obligation to pay any bonus due thereon to the Louisiana State Mineral and Energy Board, nor shall the Louisiana State Mineral and Energy Board be obligated to refund any consideration paid by the Lessor prior to such modification, cancellation, or abrogation, including, but not limited to, bonuses, rentals and royalties.

NOTE: The State of Louisiana does hereby reserve, and this lease shall be subject to, the imprescriptible right of surface use in the nature of a servitude in favor of the Department of Natural Resources, including its Offices and Commissions, for the sole purpose of implementing, constructing, servicing and maintaining approved coastal zone management and/or restoration projects. Utilization of any and all rights derived under this lease by the mineral lessee, its agents, successors or assigns, shall not interfere with nor hinder the reasonable surface use by the Department of Natural Resources, its Offices or Commissions, as herein above reserved.

Applicant: ROBERT A. SCHROEDER, INC.

Bidder	Cash Payment	Price/ Acre	Rental	Oil	Gas	Other

Legend

11120049

Blocks

Active_Leases

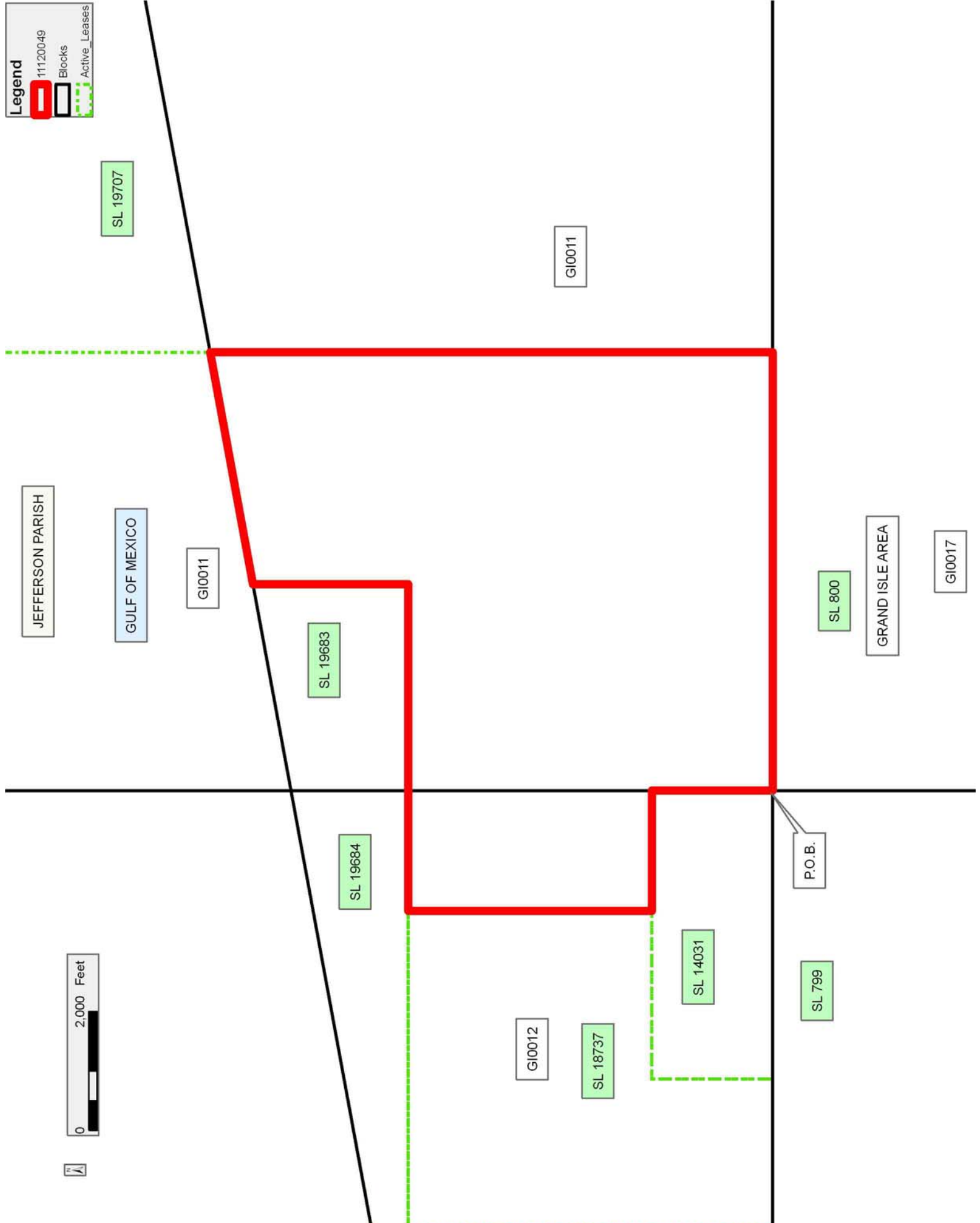

TRACT 42380 - Portion of Blocks 15, and 36, West Delta Area, Plaquemines Parish, Louisiana

The beds and bottoms of all water bodies belonging to the State of Louisiana located in Blocks 15, and 36, West Delta Area, together with any present lands formed by accretion to the shoreline or islands formed therein, located in Plaquemines Parish, Louisiana, owned by and not presently under mineral lease as of December 14, 2011, from the State of Louisiana, the geographical area of which is more fully described as follows: Beginning at the Southwest corner of Block 15, West Delta Area, having Coordinates of X = 2,476,172.00 and Y = 186,360.50; thence North 7,506.55 feet along the West line of said Block 15, West Delta Area, to a point having Coordinates of X = 2,476,172.00 and Y = 193,867.05; thence East 10,450.00 feet to a point having Coordinates of X = 2,486,622.00 and Y = 193,867.05, said point being on the East line of said Block 15, West Delta Area; thence South 7,506.55 feet along said East line of said Block 15, West Delta Area, to a point being its Southeast corner having Coordinates of X = 2,486,622.00 and Y = 186,360.50, said point also being the Northeast corner of Block 36, West Delta Area; thence South 493.45 feet along the East line of said Block 36, West Delta Area, to a point on the Three Mile Line, as decreed by the Supreme Court of the United States, as determined by a Special Master appointed therein, in litigation styled *United States v. State of Louisiana et al No. 9 Original*, in 1975, having Coordinates of X = 2,486,622.00 and Y = 185,867.05; thence Southwesterly along a straight line on said Three Mile Line to a point having Coordinates of X = 2,476,172.00 and Y = 183,942.86, said point being on said West line of Block 36, West Delta Area; thence North 2,417.64 feet along said West line of Block 36, West Delta Area, to the point of beginning, containing approximately **2,150 acres, LESS AND EXCEPT** that portion thereof, if any, lying seaward of the line three nautical miles from the coast line of Louisiana, as said three mile line has been decreed by the Supreme Court of the United States, as determined by a Special Master appointed therein, in litigation styled **United States v. State of Louisiana et al No. 9 Original**, in 1975, all as more particularly outlined on a plat in the Office of Mineral Resources, Department of Natural Resources. All bearings, distances and coordinates are based on the Louisiana Coordinate System of 1927, (South Zone).

NOTE: The above description of the Tract nominated for lease has been provided and corrected, where required, exclusively by the nomination party. Any mineral lease selected from this Tract and awarded by the Louisiana State Mineral and Energy Board shall be without warranty of any kind, either express, implied, or statutory, including, but not limited to, the implied warranties of merchantability and fitness for a particular purpose. Should the mineral lease awarded by the Louisiana State Mineral and Energy Board be subsequently modified, cancelled or abrogated due to the existence of conflicting leases, operating agreements, private claims or other future obligations or conditions which may affect all or any portion of the leased Tract, it shall not relieve the Lessee of the obligation to pay any bonus due thereon to the Louisiana State Mineral and

Energy Board, nor shall the Louisiana State Mineral and Energy Board be obligated to refund any consideration paid by the Lessor prior to such modification, cancellation, or abrogation, including, but not limited to, bonuses, rentals and royalties.

NOTE: The State of Louisiana does hereby reserve, and this lease shall be subject to, the imprescriptible right of surface use in the nature of a servitude in favor of the Department of Natural Resources, including its Offices and Commissions, for the sole purpose of implementing, constructing, servicing and maintaining approved coastal zone management and/or restoration projects. Utilization of any and all rights derived under this lease by the mineral lessee, its agents, successors or assigns, shall not interfere with nor hinder the reasonable surface use by the Department of Natural Resources, its Offices or Commissions, as herein above reserved.

Applicant: ROBERT A. SCHROEDER, INC.

Bidder	Cash Payment	Price/ Acre	Rental	Oil	Gas	Other

Legend

11120059

Blocks

