

TRACT 42381 - Portion of Blocks 14, and 37, West Delta Area, Plaquemines Parish, Louisiana

The beds and bottoms of all water bodies belonging to the State of Louisiana located in Blocks 14, and 37, West Delta Area, together with any present lands formed by accretion to the shoreline or islands formed therein, located in Plaquemines Parish, Louisiana, owned by and not presently under mineral lease as of December 14, 2011, from the State of Louisiana, the geographical area of which is more fully described as follows: Beginning at the Southwest corner of Block 14, West Delta Area, having Coordinates of X = 2,472,417.93 and Y = 186,360.50; thence North 7,506.55 feet along the West line of said Block 14, West Delta Area, to a point having Coordinates of X = 2,472,417.93 and Y = 193,867.05; thence East 3,754.07 feet to a point having Coordinates of X = 2,476,172.00 and Y = 193,867.05, said point being on the East line of said Block 14, West Delta Area; thence South 7,506.55 feet along said East line of said Block 14, West Delta Area, to a point having Coordinates of X = 2,476,172.00 and Y = 186,360.50, being the Northeast corner of Block 37, West Delta Area; thence South 2,417.64 feet along the East line of said Block 37, West Delta Area, to a point on the Three Mile Line, as decreed by the Supreme Court of the United States, as determined by a Special Master appointed therein, in litigation styled *United States v. State of Louisiana et al No. 9 Original*, in 1975, having Coordinates of X = 2,476,172.00 and Y = 183,942.86; thence Southwesterly along a straight line to a point having Coordinates of X = 2,472,417.93 and Y = 183,251.61, said point being on said West line of Block 37, West Delta Area; thence North 3,108.89 feet along said West line of said Block 14, West Delta Area, to the point of beginning, containing approximately **885.07 acres, LESS AND EXCEPT** that portion thereof, if any, lying seaward of the line three nautical miles from the coast line of Louisiana, as said three mile line has been decreed by the Supreme Court of the United States, as determined by a Special Master appointed therein, in litigation styled **United States v. State of Louisiana et al No. 9 Original**, in 1975, all as more particularly outlined on a plat in the Office of Mineral Resources, Department of Natural Resources. All bearings, distances and coordinates are based on the Louisiana Coordinate System of 1927, (South Zone).

NOTE: The above description of the Tract nominated for lease has been provided and corrected, where required, exclusively by the nomination party. Any mineral lease selected from this Tract and awarded by the Louisiana State Mineral and Energy Board shall be without warranty of any kind, either express, implied, or statutory, including, but not limited to, the implied warranties of merchantability and fitness for a particular purpose. Should the mineral lease awarded by the Louisiana State Mineral and Energy Board be subsequently modified, cancelled or abrogated due to the existence of conflicting leases, operating agreements, private claims or other future obligations or conditions which may affect all or any portion of the leased Tract, it shall not relieve the Lessee of the obligation to pay any bonus due thereon to the Louisiana State Mineral and Energy Board, nor shall the Louisiana State Mineral and Energy Board be

obligated to refund any consideration paid by the Lessor prior to such modification, cancellation, or abrogation, including, but not limited to, bonuses, rentals and royalties.

NOTE: The State of Louisiana does hereby reserve, and this lease shall be subject to, the imprescriptible right of surface use in the nature of a servitude in favor of the Department of Natural Resources, including its Offices and Commissions, for the sole purpose of implementing, constructing, servicing and maintaining approved coastal zone management and/or restoration projects. Utilization of any and all rights derived under this lease by the mineral lessee, its agents, successors or assigns, shall not interfere with nor hinder the reasonable surface use by the Department of Natural Resources, its Offices or Commissions, as herein above reserved.

Applicant: ROBERT A. SCHROEDER, INC.

Bidder	Cash Payment	Price/Acre	Rental	Oil	Gas	Other

Legend

11120058

Blocks

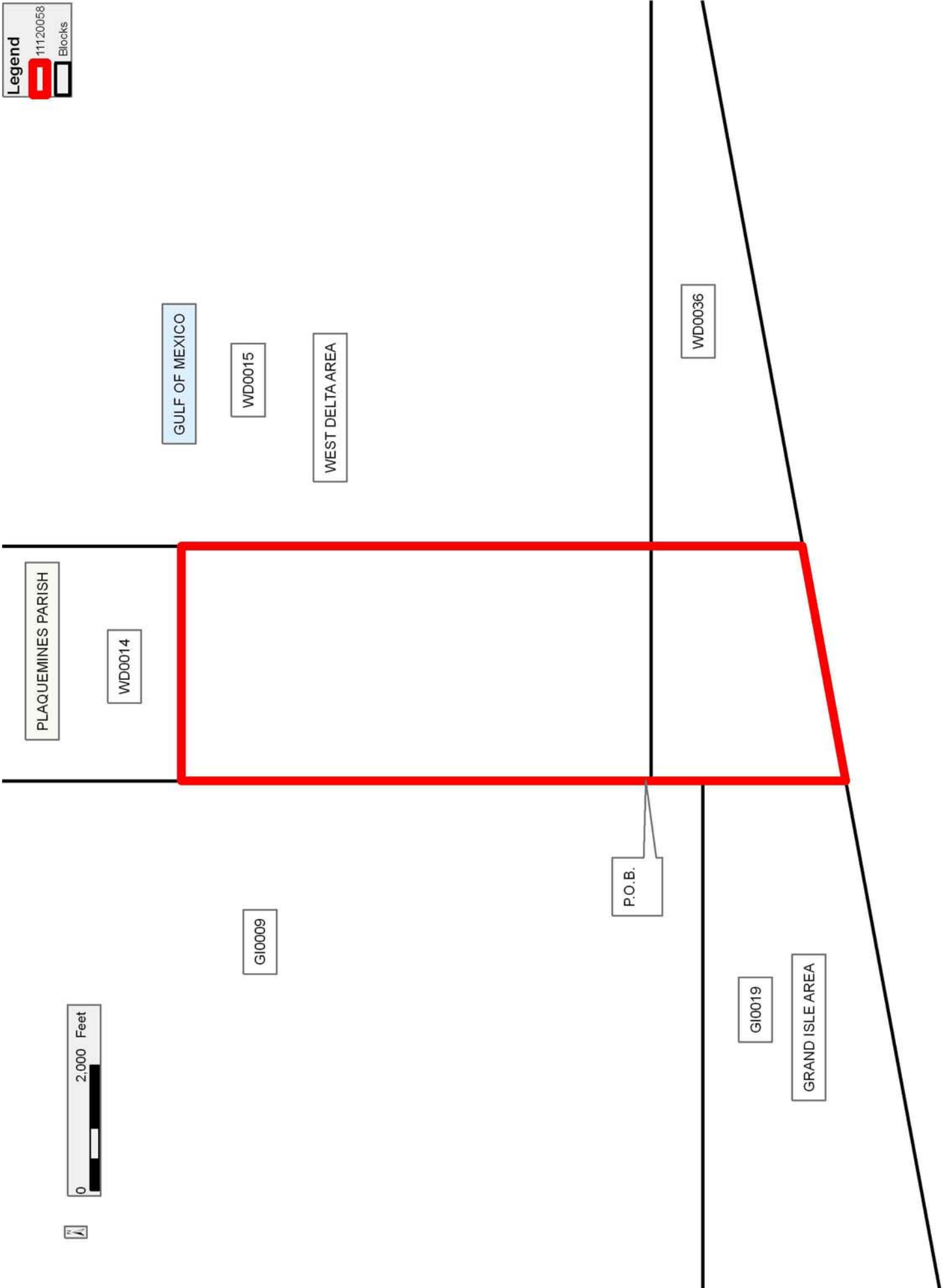

TRACT 42382 - Portion of Block 19, Grand Isle Area, Plaquemines Parish, Louisiana

The beds and bottoms of all water bodies belonging to the State of Louisiana located in Block 19, Grand Isle Area, together with any present lands formed by accretion to the shoreline or islands formed therein, located in Plaquemines Parish, Louisiana, owned by and not presently under mineral lease as of December 14, 2011, from the State of Louisiana, the geographical area of which is more fully described as follows: Beginning at the Northeast corner of Block 19, Grand Isle Area, having Coordinates of X = 2,472,417.93 and Y = 185,535.39; thence South 2,283.78 feet along the East line of said of Block 19, Grand Isle Area, to a point on the Three Mile Line, as decreed by the Supreme Court of the United States, as determined by a Special Master appointed therein, in litigation styled *United States v. State of Louisiana et al No. 9 Original*, in 1975, having Coordinates of X = 2,472,417.93 and Y = 183,251.61; thence Southwesterly along a straight line, along said Three Mile Line to a point being the southernmost point of said State Lease No. 20581 having Coordinates of X = 2,460,384.86 and Y = 181,035.92; thence along the Eastern boundary of said State Lease No. 20581 the following courses: North 39 degrees 07 minutes 43 seconds East 2,186.51 feet to a point having Coordinates of X = 2,461,764.69 and Y = 182,732.06; and North 47 degrees 00 minutes 00 seconds East 4,110.46 feet to a point having Coordinates of X = 2,464,770.89 and Y = 185,535.39, said point being on the North line of said Block 19, Grand Isle Area; thence East 7,647.04 feet along the North line of said of Block 19, Grand Isle Area, to the point of beginning, containing approximately **724.51 acres, LESS AND EXCEPT** that portion thereof, if any, lying seaward of the line three nautical miles from the coast line of Louisiana, as said three mile line has been decreed by the Supreme Court of the United States, as determined by a Special Master appointed therein, in litigation styled **United States v. State of Louisiana et al No. 9 Original**, in 1975, all as more particularly outlined on a plat in the Office of Mineral Resources, Department of Natural Resources. All bearings, distances and coordinates are based on the Louisiana Coordinate System of 1927, (South Zone).

NOTE: The above description of the Tract nominated for lease has been provided and corrected, where required, exclusively by the nomination party. Any mineral lease selected from this Tract and awarded by the Louisiana State Mineral and Energy Board shall be without warranty of any kind, either express, implied, or statutory, including, but not limited to, the implied warranties of merchantability and fitness for a particular purpose. Should the mineral lease awarded by the Louisiana State Mineral and Energy Board be subsequently modified, cancelled or abrogated due to the existence of conflicting leases, operating agreements, private claims or other future obligations or conditions which may affect all or any portion of the leased Tract, it shall not relieve the Lessee of the obligation to pay any bonus due thereon to the Louisiana State Mineral and Energy Board, nor shall the Louisiana State Mineral and Energy Board be obligated to refund any consideration paid by the Lessor prior to such

modification, cancellation, or abrogation, including, but not limited to, bonuses, rentals and royalties.

NOTE: The State of Louisiana does hereby reserve, and this lease shall be subject to, the imprescriptible right of surface use in the nature of a servitude in favor of the Department of Natural Resources, including its Offices and Commissions, for the sole purpose of implementing, constructing, servicing and maintaining approved coastal zone management and/or restoration projects. Utilization of any and all rights derived under this lease by the mineral lessee, its agents, successors or assigns, shall not interfere with nor hinder the reasonable surface use by the Department of Natural Resources, its Offices or Commissions, as herein above reserved.

Applicant: ROBERT A. SCHROEDER, INC.

Bidder	Cash Payment	Price/Acre	Rental	Oil	Gas	Other

Legend

- 11120057
- Blocks
- Active_Leases

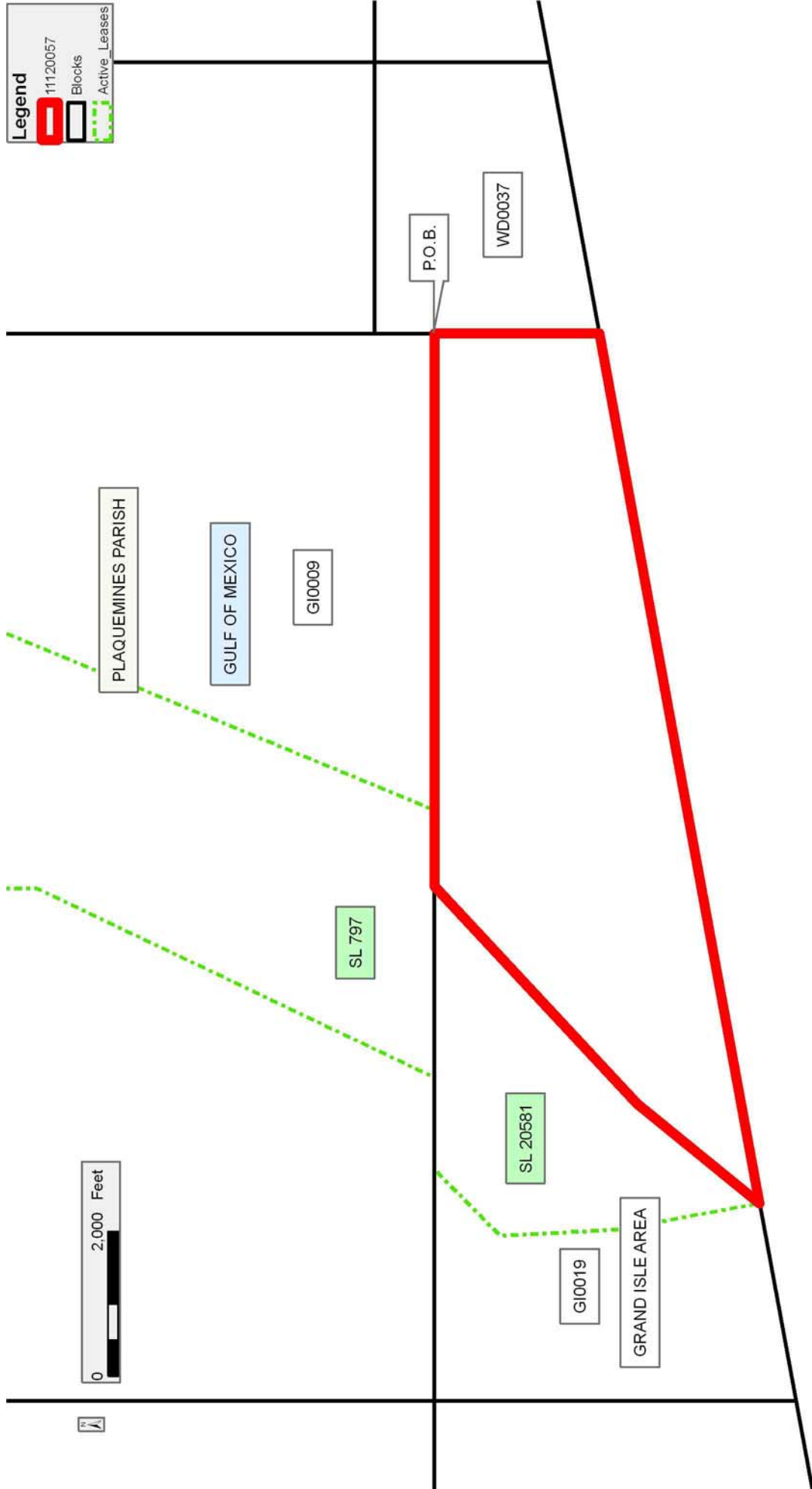

TRACT 42383 - Portion of Block 19, Grand Isle Area, Plaquemines Parish, Louisiana

The beds and bottoms of all water bodies belonging to the State of Louisiana located in Block 19, Grand Isle Area, together with any present lands formed by accretion to the shoreline or islands formed therein, located in Plaquemines Parish, Louisiana, owned by and not presently under mineral lease as of December 14, 2011, from the State of Louisiana, the geographical area of which is more fully described as follows: Beginning at the Northwest corner of Block 19, Grand Isle Area, having Coordinates of X = 2,457,659.89 and Y = 185,535.39; thence East 3,198.00 feet along the North line of said of Block 19, Grand Isle Area, to a point being the Northwest corner of State Lease No. 20581 having Coordinates of X = 2,460,857.89 and Y = 185,535.39; thence along the Western boundary of said State Lease No. 20581 the following courses: South 45 degrees 15 minutes 00 seconds West 1,295.17 feet to a point having Coordinates of X = 2,459,938.08 and Y = 184,623.57; South 02 degrees 58 minutes 07 seconds East 1,618.65 feet to a point having Coordinates of X = 2,460,021.91 and Y = 183,007.09, and South 10 degrees 25 minutes 59 seconds East 2,004.31 feet to a point being the Southernmost point of said State Lease No. 20581 having Coordinates of X = 2,460,384.86 and Y = 181,035.92, said point also being on the Three Mile Line, as decreed by the Supreme Court of the United States, as determined by a Special Master appointed therein, in litigation styled *United States v. State of Louisiana et al No. 9 Original*, in 1975; thence Southwesterly along a straight line, along said Three Mile Line to a point having Coordinates of X = 2,457,659.89 and Y = 180,534.17, said point being on the West line of said Block 19, Grand Isle Area; thence North 5,001.22 feet along said West line of said Block 19, Grand Isle Area, to the point of beginning, containing approximately **274.20 acres, LESS AND EXCEPT** that portion thereof, if any, lying seaward of the line three nautical miles from the coast line of Louisiana, as said three mile line has been decreed by the Supreme Court of the United States, as determined by a Special Master appointed therein, in litigation styled **United States v. State of Louisiana et al No. 9 Original**, in 1975, all as more particularly outlined on a plat in the Office of Mineral Resources, Department of Natural Resources. All bearings, distances and coordinates are based on the Louisiana Coordinate System of 1927, (South Zone).

NOTE: The above description of the Tract nominated for lease has been provided and corrected, where required, exclusively by the nomination party. Any mineral lease selected from this Tract and awarded by the Louisiana State Mineral and Energy Board shall be without warranty of any kind, either express, implied, or statutory, including, but not limited to, the implied warranties of merchantability and fitness for a particular purpose. Should the mineral lease awarded by the Louisiana State Mineral and Energy Board be subsequently modified, cancelled or abrogated due to the existence of conflicting leases, operating agreements, private claims or other future obligations or conditions which may affect all or any portion of the leased Tract, it shall not relieve the Lessee of the

obligation to pay any bonus due thereon to the Louisiana State Mineral and Energy Board, nor shall the Louisiana State Mineral and Energy Board be obligated to refund any consideration paid by the Lessor prior to such modification, cancellation, or abrogation, including, but not limited to, bonuses, rentals and royalties.

NOTE: The State of Louisiana does hereby reserve, and this lease shall be subject to, the imprescriptible right of surface use in the nature of a servitude in favor of the Department of Natural Resources, including its Offices and Commissions, for the sole purpose of implementing, constructing, servicing and maintaining approved coastal zone management and/or restoration projects. Utilization of any and all rights derived under this lease by the mineral lessee, its agents, successors or assigns, shall not interfere with nor hinder the reasonable surface use by the Department of Natural Resources, its Offices or Commissions, as herein above reserved.

Applicant: ROBERT A. SCHROEDER, INC.

Bidder	Cash Payment	Price/Acre	Rental	Oil	Gas	Other

Legend

- 11120055
- Blocks
- Active_Leases

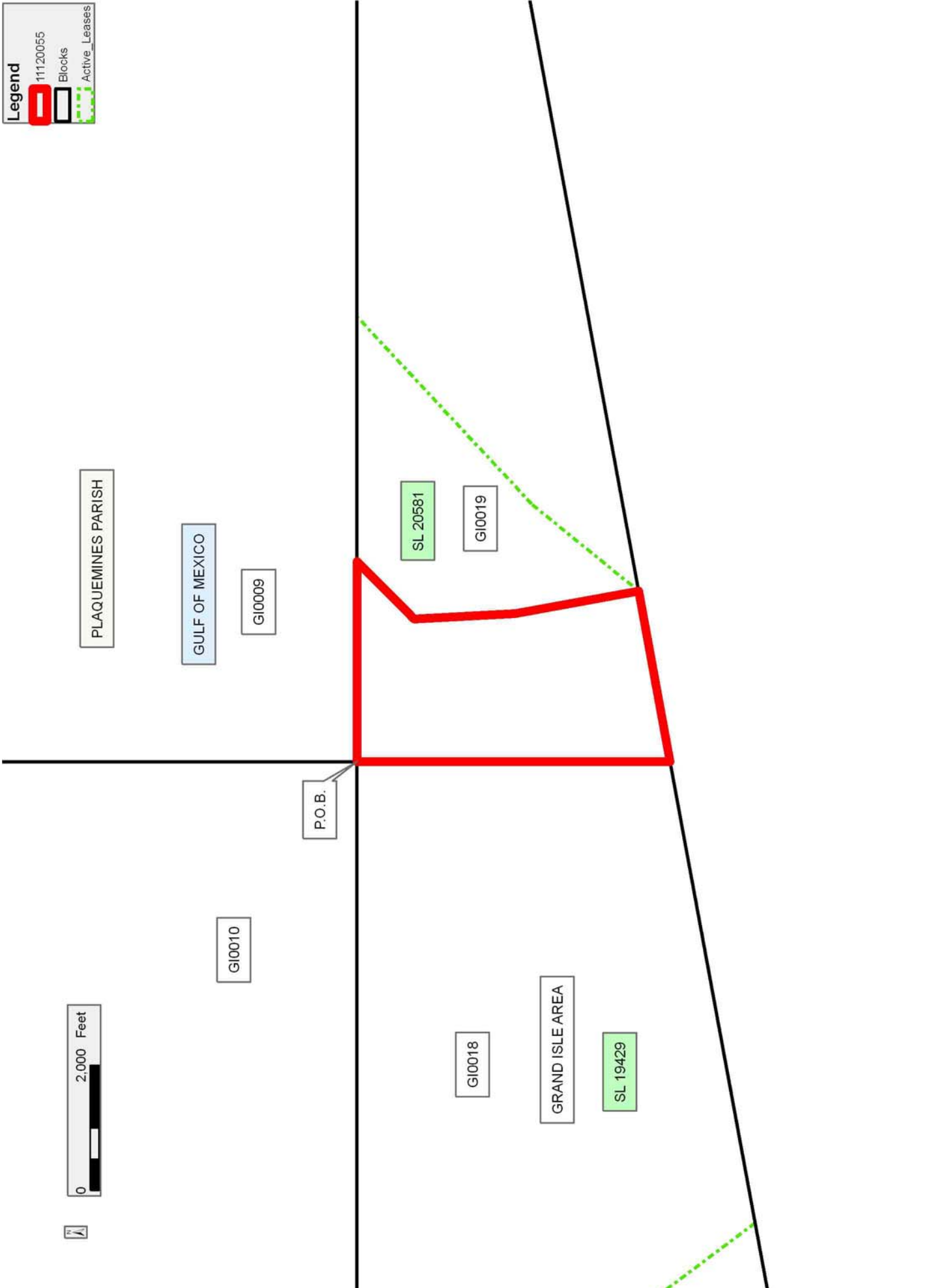

TRACT 42384 - Portion of Block 18, Grand Isle Area, Jefferson Parish, Louisiana

The beds and bottoms of all water bodies belonging to the State of Louisiana located in Block 18, Grand Isle Area, together with any present lands formed by accretion to the shoreline or islands formed therein, located in Jefferson Parish, Louisiana, owned by and not presently under mineral lease as of December 14, 2011, from the State of Louisiana, the geographical area of which is more fully described as follows: Beginning at a the Northwest corner of Block 18, Grand Isle Area, having Coordinates of X = 2,442,901.85 and Y = 185,535.39; thence East 2,600.00 feet along the North line of said Block 18, Grand Isle Area, to a point being the Northwest corner of State Lease No. 19429 having Coordinates of X = 2,445,501.85 and Y = 185,535.39; thence South 36 degrees 55 minutes 20 seconds East 7,955.38 feet along the Western boundary of said State Lease No. 19429 to a point on the Three Mile Line, as decreed by the Supreme Court of the United States, as determined by a Special Master appointed therein, in litigation styled *United States v. State of Louisiana et al No. 9 Original*, in 1975, having Coordinates of X = 2,450,280.87 and Y = 179,175.44; thence Southwesterly along a straight line, along said Three Mile Line to a point having Coordinates of X = 2,442,901.85 and Y = 177,816.73, said point being on the West line of said Block 18, Grand Isle Area; thence North 7,718.66 feet along said West line of said Block 18, Grand Isle Area, to the point of beginning, containing approximately **843.57 acres, LESS AND EXCEPT** that portion thereof, if any, lying seaward of the line three nautical miles from the coast line of Louisiana, as said three mile line has been decreed by the Supreme Court of the United States, as determined by a Special Master appointed therein, in litigation styled **United States v. State of Louisiana et al No. 9 Original**, in 1975, all as more particularly outlined on a plat in the Office of Mineral Resources, Department of Natural Resources. All bearings, distances and coordinates are based on the Louisiana Coordinate System of 1927, (South Zone).

NOTE: The above description of the Tract nominated for lease has been provided and corrected, where required, exclusively by the nomination party. Any mineral lease selected from this Tract and awarded by the Louisiana State Mineral and Energy Board shall be without warranty of any kind, either express, implied, or statutory, including, but not limited to, the implied warranties of merchantability and fitness for a particular purpose. Should the mineral lease awarded by the Louisiana State Mineral and Energy Board be subsequently modified, cancelled or abrogated due to the existence of conflicting leases, operating agreements, private claims or other future obligations or conditions which may affect all or any portion of the leased Tract, it shall not relieve the Lessee of the obligation to pay any bonus due thereon to the Louisiana State Mineral and Energy Board, nor shall the Louisiana State Mineral and Energy Board be obligated to refund any consideration paid by the Lessor prior to such modification, cancellation, or abrogation, including, but not limited to, bonuses, rentals and royalties.

NOTE: The State of Louisiana does hereby reserve, and this lease shall be subject to, the imprescriptible right of surface use in the nature of a servitude in favor of the Department of Natural Resources, including its Offices and Commissions, for the sole purpose of implementing, constructing, servicing and maintaining approved coastal zone management and/or restoration projects. Utilization of any and all rights derived under this lease by the mineral lessee, its agents, successors or assigns, shall not interfere with nor hinder the reasonable surface use by the Department of Natural Resources, its Offices or Commissions, as herein above reserved.

Applicant: ROBERT A. SCHROEDER, INC.

Bidder	Cash Payment	Price/Acre	Rental	Oil	Gas	Other

Legend

- 11120052
- Blocks
- Active_Leases

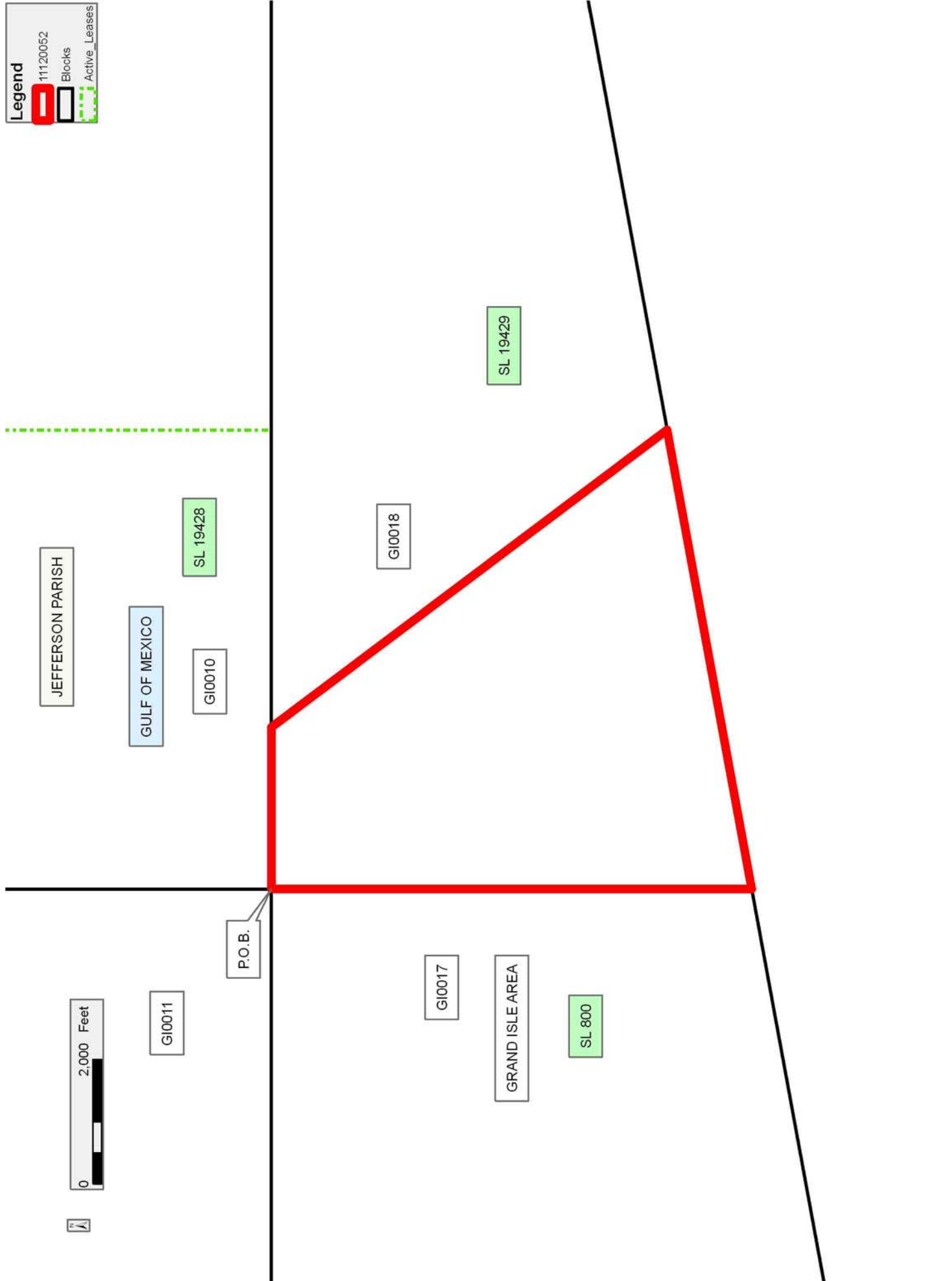

TRACT 42385 - Portion of Blocks 15, and 16, Grand Isle Area, Jefferson Parish, Louisiana

The beds and bottoms of all water bodies belonging to the State of Louisiana located in Blocks 15, and 16, Grand Isle Area, together with any present lands formed by accretion to the shoreline or islands formed therein, located in Jefferson Parish, Louisiana, owned by and not presently under mineral lease as of December 14, 2011, from the State of Louisiana, the geographical area of which is more fully described as follows: Beginning at a the Southwest corner of Block 15, Grand Isle Area, having Coordinates of X = 2,398,627.73 and Y = 170,777.35; thence North 6,853.47 feet along the West line of said Block 15, Grand Isle Area, to a point having Coordinates of X = 2,398,627.73 and Y = 177,630.82; thence East 16,064.84 feet to a point having Coordinates of X = 2,414,692.57 and Y = 177,630.82, said point being on the Western Boundary of State Lease No. 799, as amended; thence South 5,190.01 feet along the Western Boundary of said State Lease No. 799, as amended, to a point on the Three Mile Line, as decreed by the Supreme Court of the United States, as determined by a Special Master appointed therein, in litigation styled *United States v. State of Louisiana et al No. 9 Original*, in 1975, having Coordinates of X = 2,414,692.57 and Y = 172,440.81; thence along said Three Mile Line the following courses: Southwesterly along a straight line to a point having Coordinates of X = 2,413,385.77 and Y = 171,335.19; and Southwesterly along a straight line to a point having Coordinates of X = 2,412,726.47 and Y = 170,777.35, said point being on the South line of said Block 15, Grand Isle Area; thence West 14,098.74 feet along said South line of said Block 15, Grand Isle Area, to the point of beginning, containing approximately **2,490 acres, LESS AND EXCEPT** that portion thereof, if any, lying seaward of the line three nautical miles from the coast line of Louisiana, as said three mile line has been decreed by the Supreme Court of the United States, as determined by a Special Master appointed therein, in litigation styled **United States v. State of Louisiana et al No. 9 Original**, in 1975, all as more particularly outlined on a plat in the Office of Mineral Resources, Department of Natural Resources. All bearings, distances and coordinates are based on the Louisiana Coordinate System of 1927, (South Zone).

NOTE: The above description of the Tract nominated for lease has been provided and corrected, where required, exclusively by the nomination party. Any mineral lease selected from this Tract and awarded by the Louisiana State Mineral and Energy Board shall be without warranty of any kind, either express, implied, or statutory, including, but not limited to, the implied warranties of merchantability and fitness for a particular purpose. Should the mineral lease awarded by the Louisiana State Mineral and Energy Board be subsequently modified, cancelled or abrogated due to the existence of conflicting leases, operating agreements, private claims or other future obligations or conditions which may affect all or any portion of the leased Tract, it shall not relieve the Lessee of the obligation to pay any bonus due thereon to the Louisiana State Mineral and Energy Board, nor shall the Louisiana State Mineral and Energy Board be

obligated to refund any consideration paid by the Lessor prior to such modification, cancellation, or abrogation, including, but not limited to, bonuses, rentals and royalties.

NOTE: The State of Louisiana does hereby reserve, and this lease shall be subject to, the imprescriptible right of surface use in the nature of a servitude in favor of the Department of Natural Resources, including its Offices and Commissions, for the sole purpose of implementing, constructing, servicing and maintaining approved coastal zone management and/or restoration projects. Utilization of any and all rights derived under this lease by the mineral lessee, its agents, successors or assigns, shall not interfere with nor hinder the reasonable surface use by the Department of Natural Resources, its Offices or Commissions, as herein above reserved.

Applicant: ROBERT A. SCHROEDER, INC.

Bidder	Cash Payment	Price/Acre	Rental	Oil	Gas	Other

Legend

- 11120047
- Blocks
- Active_Leases



TRACT 42386 - Portion of Block 24, Grand Isle Area, Jefferson Parish, Louisiana

The beds and bottoms of all water bodies belonging to the State of Louisiana located in Block 24, Grand Isle Area, together with any present lands formed by accretion to the shoreline or islands formed therein, located in Jefferson Parish, Louisiana, owned by and not presently under mineral lease as of December 14, 2011, from the State of Louisiana, the geographical area of which is more fully described as follows: Beginning at a the Northwest corner of Block 24, Grand Isle Area, having Coordinates of X = 2,398,627.73 and Y = 170,777.35; thence East 14,098.74 feet on and along the North line of said Block 24, Grand Isle Area, to a point on the Three Mile Line, as decreed by the Supreme Court of the United States, as determined by a Special Master appointed therein, in litigation styled *United States v. State of Louisiana et al No. 9 Original*, in 1975, having Coordinates of X = 2,412,726.47 and Y = 170,777.35; thence along said Three Mile Line the following courses: Southwesterly along a straight line to a point having Coordinates of X = 2,410,270 and Y = 168,699; Southwesterly along a straight line to a point having Coordinates of X = 2,406,006 and Y = 164,749; Southwesterly along an arc to the right having a radius of 18,240.60 feet and centered at X = 2,393,610 and Y = 178,130 to a point having Coordinates of X = 2,404,972 and Y = 163,860; and Southwesterly along a straight line to a point having Coordinates of X = 2,398,627.73 and Y = 158,808.72, said point being on the West line of said Block 24, Grand Isle Area; thence North 11,968.63 feet on and along said West line of said Block 24, Grand Isle Area, to the point of beginning, containing approximately **1,984.61 acres, LESS AND EXCEPT** that portion thereof, if any, lying seaward of the line three nautical miles from the coast line of Louisiana, as said three mile line has been decreed by the Supreme Court of the United States, as determined by a Special Master appointed therein, in litigation styled **United States v. State of Louisiana et al No. 9 Original**, in 1975, all as more particularly outlined on a plat in the Office of Mineral Resources, Department of Natural Resources. All bearings, distances and coordinates are based on the Louisiana Coordinate System of 1927, (South Zone).

NOTE: The above description of the Tract nominated for lease has been provided and corrected, where required, exclusively by the nomination party. Any mineral lease selected from this Tract and awarded by the Louisiana State Mineral and Energy Board shall be without warranty of any kind, either express, implied, or statutory, including, but not limited to, the implied warranties of merchantability and fitness for a particular purpose. Should the mineral lease awarded by the Louisiana State Mineral and Energy Board be subsequently modified, cancelled or abrogated due to the existence of conflicting leases, operating agreements, private claims or other future obligations or conditions which may affect all or any portion of the leased Tract, it shall not relieve the Lessee of the obligation to pay any bonus due thereon to the Louisiana State Mineral and Energy Board, nor shall the Louisiana State Mineral and Energy Board be obligated to refund any consideration paid by the Lessor prior to such

modification, cancellation, or abrogation, including, but not limited to, bonuses, rentals and royalties.

NOTE: The State of Louisiana does hereby reserve, and this lease shall be subject to, the imprescriptible right of surface use in the nature of a servitude in favor of the Department of Natural Resources, including its Offices and Commissions, for the sole purpose of implementing, constructing, servicing and maintaining approved coastal zone management and/or restoration projects. Utilization of any and all rights derived under this lease by the mineral lessee, its agents, successors or assigns, shall not interfere with nor hinder the reasonable surface use by the Department of Natural Resources, its Offices or Commissions, as herein above reserved.

Applicant: ROBERT A. SCHROEDER, INC.

Bidder	Cash Payment	Price/Acre	Rental	Oil	Gas	Other

Legend
11120046
Blocks

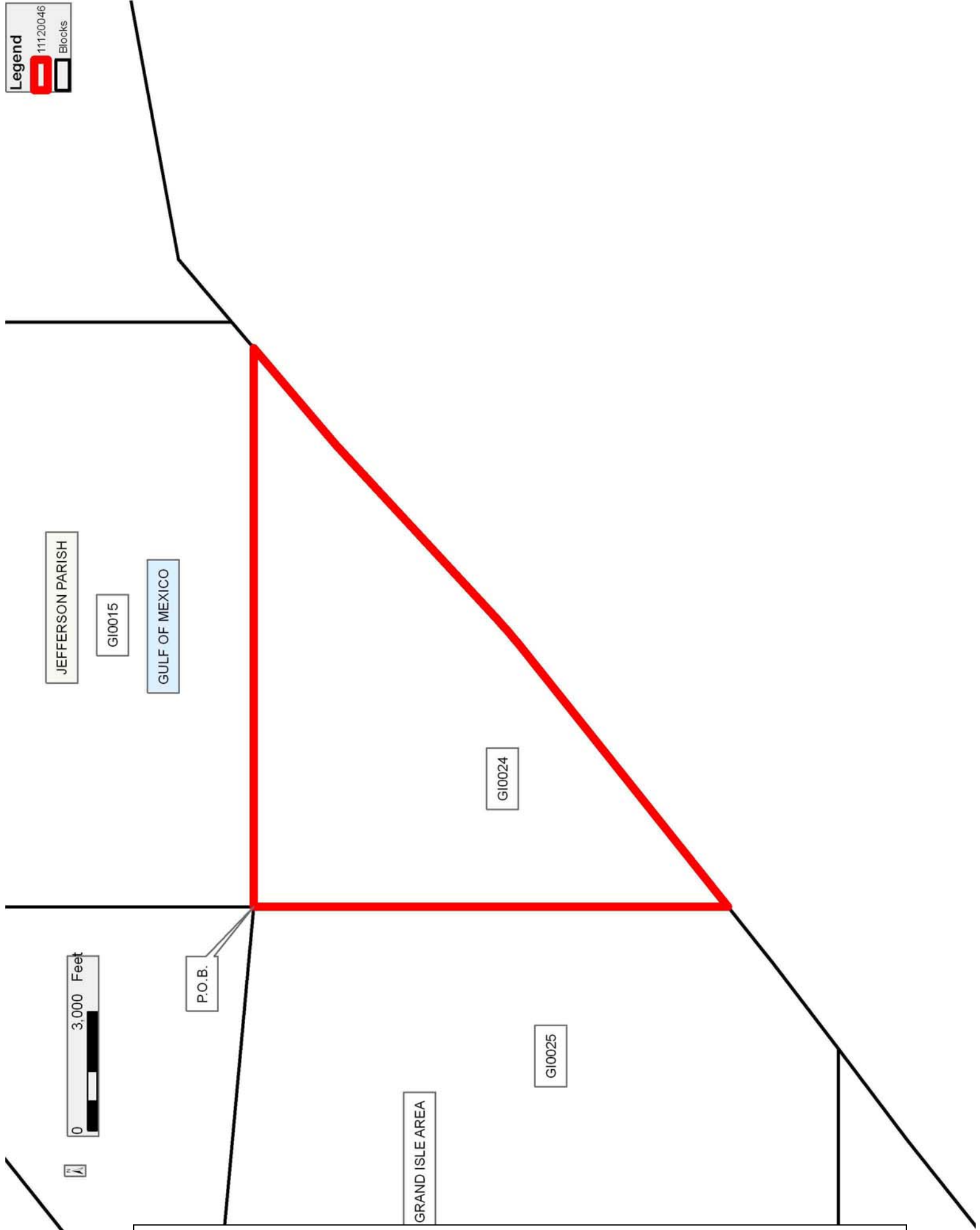

TRACT 42387 - Portion of Block 25, Grand Isle Area, Jefferson and Lafourche Parishes, Louisiana

The beds and bottoms of all water bodies belonging to the State of Louisiana located in Block 25, Grand Isle Area, together with any present lands formed by accretion to the shoreline or islands formed therein, located in Jefferson and Lafourche Parishes, Louisiana, owned by and not presently under mineral lease as of December 14, 2011, from the State of Louisiana, the geographical area of which is more fully described as follows: Beginning at the Northeast corner of Block 25, Grand Isle Area, having Coordinates of X = 2,398,627.73 and Y = 170,777.35; thence South 11,968.62 feet along the East line of said Block 25, Grand Isle Area, to a point on the Three Mile Line, as decreed by the Supreme Court of the United States, as determined by a Special Master appointed therein, in litigation styled *United States v. State of Louisiana et al No. 9 Original*, in 1975, having Coordinates of X = 2,398,627.73 and Y = 158,808.73; thence along said Three Mile Line the following courses: Southwesterly along a straight line to a point having Coordinates of X = 2,397,195 and Y = 157,668; Southeasterly along an arc to the right having a radius of 18,240.60 feet and a center at X = 2,385,833 and Y = 171,938 to a point having Coordinates of X = 2,396,858 and Y = 157,406; and Southwesterly along a straight line to a point having Coordinates of X = 2,395,029.95 and Y = 156,019.31, said point being on the South line of said Block 25, Grand Isle Area; thence West 650.74 feet along said South line of said Block 25, Grand Isle Area, to a point having Coordinates of X = 2,394,379.21 and Y = 156,019.31; thence North 3,268.66 feet to a point having Coordinates of X = 2,394,379.21 and Y = 159,287.97, said point being the Southeast corner of State Lease No. 1486, as amended; thence North 5,612.03 feet along the Eastern boundary of said State Lease No. 1486, as amended, to its Northeast corner having Coordinates of X = 2,394,379.21 and Y = 164,900.00; thence North 5,877.35 feet to a point having Coordinates of X = 2,394,379.21 and Y = 170,777.35, said point being on the North line of said Block 25, Grand Isle Area; thence East 4,248.52 feet along said North line of said Block 25, Grand Isle Area, to the point of beginning, containing approximately **1,325.57 acres, LESS AND EXCEPT** that portion thereof, if any, lying seaward of the line three nautical miles from the coast line of Louisiana, as said three mile line has been decreed by the Supreme Court of the United States, as determined by a Special Master appointed therein, in litigation styled **United States v. State of Louisiana et al No. 9 Original**, in 1975, all as more particularly outlined on a plat in the Office of Mineral Resources, Department of Natural Resources. All bearings, distances and coordinates are based on the Louisiana Coordinate System of 1927, (South Zone).

NOTE: The above description of the Tract nominated for lease has been provided and corrected, where required, exclusively by the nomination party. Any mineral lease selected from this Tract and awarded by the Louisiana State Mineral and Energy Board shall be without warranty of any kind, either express, implied, or statutory, including, but not limited to, the implied warranties of merchantability and fitness for a particular

purpose. Should the mineral lease awarded by the Louisiana State Mineral and Energy Board be subsequently modified, cancelled or abrogated due to the existence of conflicting leases, operating agreements, private claims or other future obligations or conditions which may affect all or any portion of the leased Tract, it shall not relieve the Lessee of the obligation to pay any bonus due thereon to the Louisiana State Mineral and Energy Board, nor shall the Louisiana State Mineral and Energy Board be obligated to refund any consideration paid by the Lessor prior to such modification, cancellation, or abrogation, including, but not limited to, bonuses, rentals and royalties.

NOTE: The State of Louisiana does hereby reserve, and this lease shall be subject to, the imprescriptible right of surface use in the nature of a servitude in favor of the Department of Natural Resources, including its Offices and Commissions, for the sole purpose of implementing, constructing, servicing and maintaining approved coastal zone management and/or restoration projects. Utilization of any and all rights derived under this lease by the mineral lessee, its agents, successors or assigns, shall not interfere with nor hinder the reasonable surface use by the Department of Natural Resources, its Offices or Commissions, as herein above reserved.

Applicant: ROBERT A. SCHROEDER, INC.

Bidder	Cash Payment	Price/Acre	Rental	Oil	Gas	Other

Legend

- 11120045
- Blocks
- Active_Leases
- Counties

