

TRACT 42575 - Portion of Block 70, Main Pass Area, Revised, Plaquemines Parish, Louisiana

The beds and bottoms of all water bodies belonging to the State of Louisiana located in Block 70, Main Pass Area, Revised, together with any present lands formed by accretion to the shoreline or islands formed therein, located in Plaquemines Parish, Louisiana, owned by and not presently under mineral lease as of April 11, 2012, from the State of Louisiana, the geographical area of which is more fully described as follows: Beginning at a point being the Southeast corner of Block 70, Main Pass Area, Revised, having Coordinates of X = 2,751,245.00 and Y = 214,972.00; thence West 10,535.00 feet along the Southern boundary of said Block 70 to its Southwest corner having Coordinates of X = 2,740,710.00 and Y = 214,972.00; thence North 9,770.00 feet along the Western boundary of said Block 70 to a point having Coordinates of X = 2,740,710.00 and Y = 224,742.00; thence East 8,936.00 feet to a point on the Three Mile Line, as decreed by the Supreme Court of the United States, as determined by a Special Master appointed therein, in litigation styled *United States v. State of Louisiana et al No. 9 Original*, in 1975, having Coordinates of X = 2,749,646 and Y = 224,742; thence along said Three Mile Line Southeasterly along an arc to the right having a radius of 18,240.60 feet and a center at X = 2,750,755 and Y = 206,535 to a point having Coordinates of X = 2,751,245.00 and Y = 224,769.02; thence South 9,797.02 feet to the point of beginning, containing approximately **2,363.80 acres, LESS AND EXCEPT** that portion thereof, if any, lying seaward of the line three nautical miles from the coast line of Louisiana, as said three mile line has been decreed by the Supreme Court of the United States, as determined by a Special Master appointed therein, in litigation styled **United States v. State of Louisiana et al No. 9 Original**, in 1975, all as more particularly outlined on a plat in the Office of Mineral Resources, Department of Natural Resources. All bearings, distances and coordinates are based on the Louisiana Coordinate System of 1927, (South Zone).

NOTE: The above description of the Tract nominated for lease has been provided and corrected, where required, exclusively by the nomination party. Any mineral lease selected from this Tract and awarded by the Louisiana State Mineral and Energy Board shall be without warranty of any kind, either express, implied, or statutory, including, but not limited to, the implied warranties of merchantability and fitness for a particular purpose. Should the mineral lease awarded by the Louisiana State Mineral and Energy Board be subsequently modified, cancelled or abrogated due to the existence of conflicting leases, operating agreements, private claims or other future obligations or conditions which may affect all or any portion of the leased Tract, it shall not relieve the Lessee of the obligation to pay any bonus due thereon to the Louisiana State Mineral and Energy Board, nor shall the Louisiana State Mineral and Energy Board be obligated to refund any consideration paid by the Lessor prior to such modification, cancellation, or abrogation, including, but not limited to, bonuses, rentals and royalties.

NOTE: The State of Louisiana does hereby reserve, and this lease shall be subject to, the imprescriptible right of surface use in the nature of a servitude in favor of the Department of Natural Resources, including its Offices and Commissions, for the sole purpose of implementing, constructing, servicing and maintaining approved coastal zone management and/or restoration projects. Utilization of any and all rights derived under this lease by the mineral lessee, its agents, successors or assigns, shall not interfere with nor hinder the reasonable surface use by the Department of Natural Resources, its Offices or Commissions, as herein above reserved.

Applicant: OIL & GAS SPECIALISTS, INC.

Bidder	Cash Payment	Price/Acre	Rental	Oil	Gas	Other

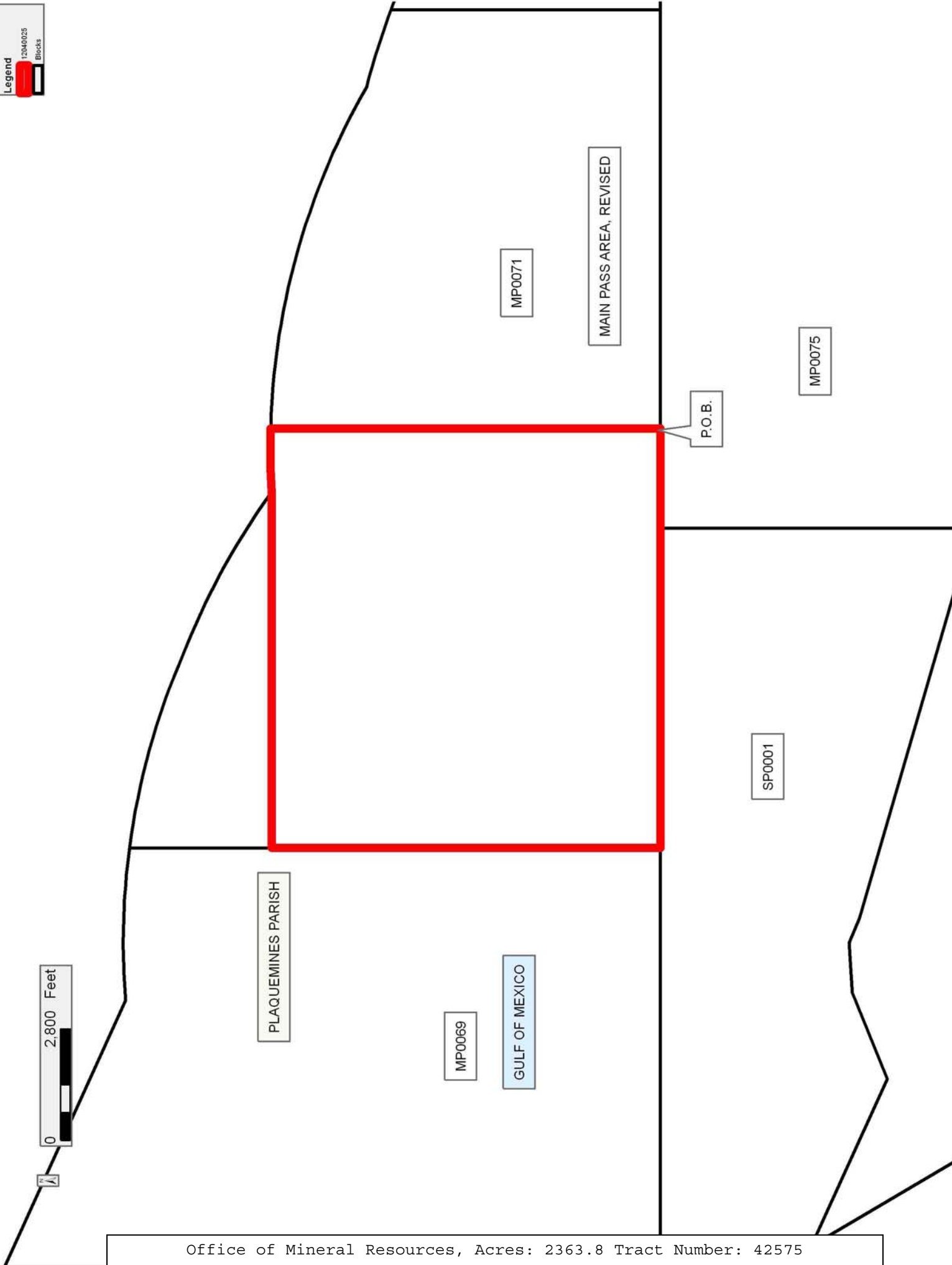

TRACT 42576 - Portion of Block 71, Main Pass Area, Revised, Plaquemines Parish, Louisiana

The beds and bottoms of all water bodies belonging to the State of Louisiana located in Block 71, Main Pass Area, Revised, together with any present lands formed by accretion to the shoreline or islands formed therein, located in Plaquemines Parish, Louisiana, owned by and not presently under mineral lease as of April 11, 2012, from the State of Louisiana, the geographical area of which is more fully described as follows: Beginning at a point being the Southwest corner of Block 71, Main Pass Area, Revised having Coordinates of X = 2,751,245.00 and Y = 214,972.00; thence North 9,797.02 feet along the Western boundary of said Block 71 to a point on the Three Mile Line, as decreed by the Supreme Court of the United States, as determined by a Special Master appointed therein, in litigation styled *United States v. State of Louisiana et al No. 9 Original*, in 1975, having Coordinates of X = 2,751,245.00 and Y = 224,769.02; thence along said Three Mile line the following: Southwesterly along an arc to the right having a radius of 18,240.60 feet and a center located at X = 2,750,755 and Y = 206,535 to a point having Coordinates of X = 2,759,837 and Y = 222,354; and Southwesterly along an arc to the right having a radius of 18,240.60 feet and a center at X = 2,755,325 and Y = 204,680 to a point having Coordinates of X = 2,761,780.00 and Y = 221,740.26; thence South 6,768.26 feet along the Eastern boundary of said Block 71 to a point having Coordinates of X = 2,761,780.00 and Y = 214,972.00; thence West 10,535.00 feet along the Southern boundary of said Block 71 to the point of beginning, containing approximately **2,086.66 acres, LESS AND EXCEPT** that portion thereof, if any, lying seaward of the line three nautical miles from the coast line of Louisiana, as said three mile line has been decreed by the Supreme Court of the United States, as determined by a Special Master appointed therein, in litigation styled **United States v. State of Louisiana et al No. 9 Original**, in 1975, all as more particularly outlined on a plat in the Office of Mineral Resources, Department of Natural Resources. All bearings, distances and coordinates are based on the Louisiana Coordinate System of 1927, (South Zone).

NOTE: The above description of the Tract nominated for lease has been provided and corrected, where required, exclusively by the nomination party. Any mineral lease selected from this Tract and awarded by the Louisiana State Mineral and Energy Board shall be without warranty of any kind, either express, implied, or statutory, including, but not limited to, the implied warranties of merchantability and fitness for a particular purpose. Should the mineral lease awarded by the Louisiana State Mineral and Energy Board be subsequently modified, cancelled or abrogated due to the existence of conflicting leases, operating agreements, private claims or other future obligations or conditions which may affect all or any portion of the leased Tract, it shall not relieve the Lessee of the obligation to pay any bonus due thereon to the Louisiana State Mineral and Energy Board, nor shall the Louisiana State Mineral and Energy Board be obligated to refund any consideration paid by the Lessor prior to such

modification, cancellation, or abrogation, including, but not limited to, bonuses, rentals and royalties.

NOTE: The State of Louisiana does hereby reserve, and this lease shall be subject to, the imprescriptible right of surface use in the nature of a servitude in favor of the Department of Natural Resources, including its Offices and Commissions, for the sole purpose of implementing, constructing, servicing and maintaining approved coastal zone management and/or restoration projects. Utilization of any and all rights derived under this lease by the mineral lessee, its agents, successors or assigns, shall not interfere with nor hinder the reasonable surface use by the Department of Natural Resources, its Offices or Commissions, as herein above reserved.

Applicant: OIL & GAS SPECIALISTS, INC.

Bidder	Cash Payment	Price/Acre	Rental	Oil	Gas	Other

Legend

- 12040027
- Blocks
- Active_Leases

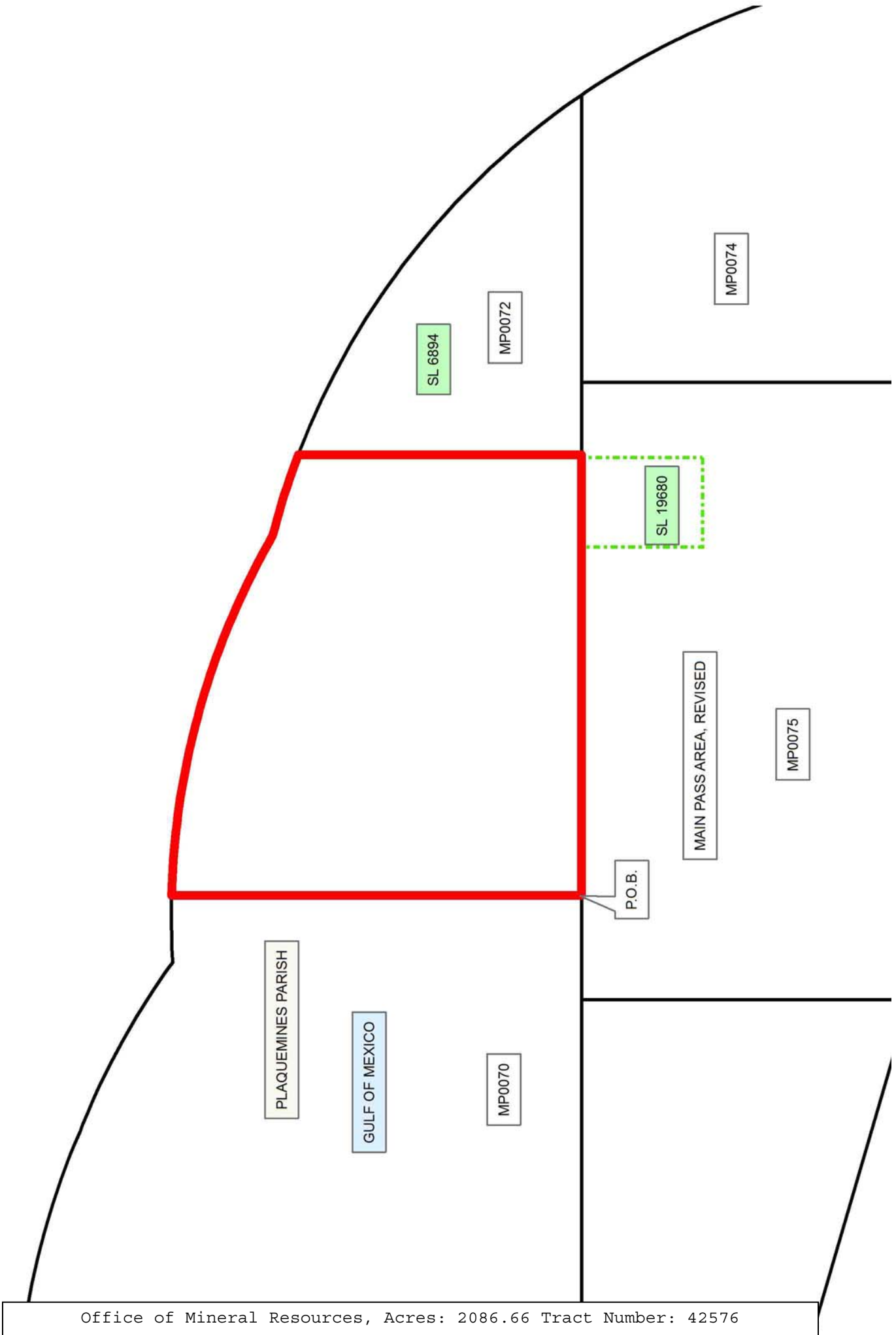

TRACT 42577 - Portion of Block 75, Main Pass Area, Revised, Plaquemines Parish, Louisiana

The beds and bottoms of all water bodies belonging to the State of Louisiana located in Block 75, Main Pass Area, Revised, together with any present lands formed by accretion to the shoreline or islands formed therein, located in Plaquemines Parish, Louisiana, owned by and not presently under mineral lease as of April 11, 2012, from the State of Louisiana, the geographical area of which is more fully described as follows: Beginning at a point being the Northwest corner of Block 75, Main Pass Area, Revised, having Coordinates of X = 2,748,750.00 and Y = 214,972.00; thence East 10820.50 feet along the Northern boundary of said Block 75 to a point being the Northwest corner of State Lease No. 19680 having Coordinates of X = 2,759,570.50 and Y = 214,972.00; thence South 2893.81 feet along the Western boundary of said State Lease No. 19680 to its Southwest corner having Coordinates of X = 2,759,570.50 and Y = 212,078.19, said point also being a point on the Northern boundary of State Lease No. 20646; thence along the Western boundary of said State Lease No. 20646 the following: South 89 degrees 59 minutes 18 seconds West 33.25 feet to a point having Coordinates of X = 2,759,537.25 and Y = 212,078.18; South 6109.17 feet to a point having Coordinates of X = 2,759,537.25 and Y = 205,969.02; and South 43 degrees 31 minutes 18 seconds East 1423.59 to a point having Coordinates of X = 2,760,517.58 and Y = 204,936.75; thence West 5,825.12 feet to a point on the Louisiana Coastline, as decreed by the Supreme Court of the United States, as determined by a Special Master appointed therein, in litigation styled *United States v. State of Louisiana et al No. 9 Original*, in 1975, having Coordinates of X = 2,754,692.46 and Y = 204,936.75; thence along said Coastline the following: Northwesterly to a point having Coordinates of X = 2,750,755 and Y = 206,535, and Northwesterly to a point having Coordinates of X = 2,748,750.00 and Y = 207,118.67, said point being on the Eastern boundary of said Block 75; thence North 7,853.33 feet along the Eastern boundary of said Block 75 to the point of beginning, containing approximately **2,339.73 acres**, all as more particularly outlined on a plat on file in the Office of Mineral Resources, Department of Natural Resources. All bearings, distances and coordinates are based on Louisiana Coordinate System of 1927, (North or South Zone).

NOTE: The above description of the Tract nominated for lease has been provided and corrected, where required, exclusively by the nomination party. Any mineral lease selected from this Tract and awarded by the Louisiana State Mineral and Energy Board shall be without warranty of any kind, either express, implied, or statutory, including, but not limited to, the implied warranties of merchantability and fitness for a particular purpose. Should the mineral lease awarded by the Louisiana State Mineral and Energy Board be subsequently modified, cancelled or abrogated due to the existence of conflicting leases, operating agreements, private claims or other future obligations or conditions which may affect all or any portion of the leased Tract, it shall not relieve the Lessee of the obligation to pay any bonus due thereon to the Louisiana State Mineral and

Energy Board, nor shall the Louisiana State Mineral and Energy Board be obligated to refund any consideration paid by the Lessor prior to such modification, cancellation, or abrogation, including, but not limited to, bonuses, rentals and royalties.

NOTE: The State of Louisiana does hereby reserve, and this lease shall be subject to, the imprescriptible right of surface use in the nature of a servitude in favor of the Department of Natural Resources, including its Offices and Commissions, for the sole purpose of implementing, constructing, servicing and maintaining approved coastal zone management and/or restoration projects. Utilization of any and all rights derived under this lease by the mineral lessee, its agents, successors or assigns, shall not interfere with nor hinder the reasonable surface use by the Department of Natural Resources, its Offices or Commissions, as herein above reserved.

Applicant: OIL & GAS SPECIALISTS, INC.

Bidder	Cash Payment	Price/Acre	Rental	Oil	Gas	Other

Legend

12040024

Blocks

Active Leases

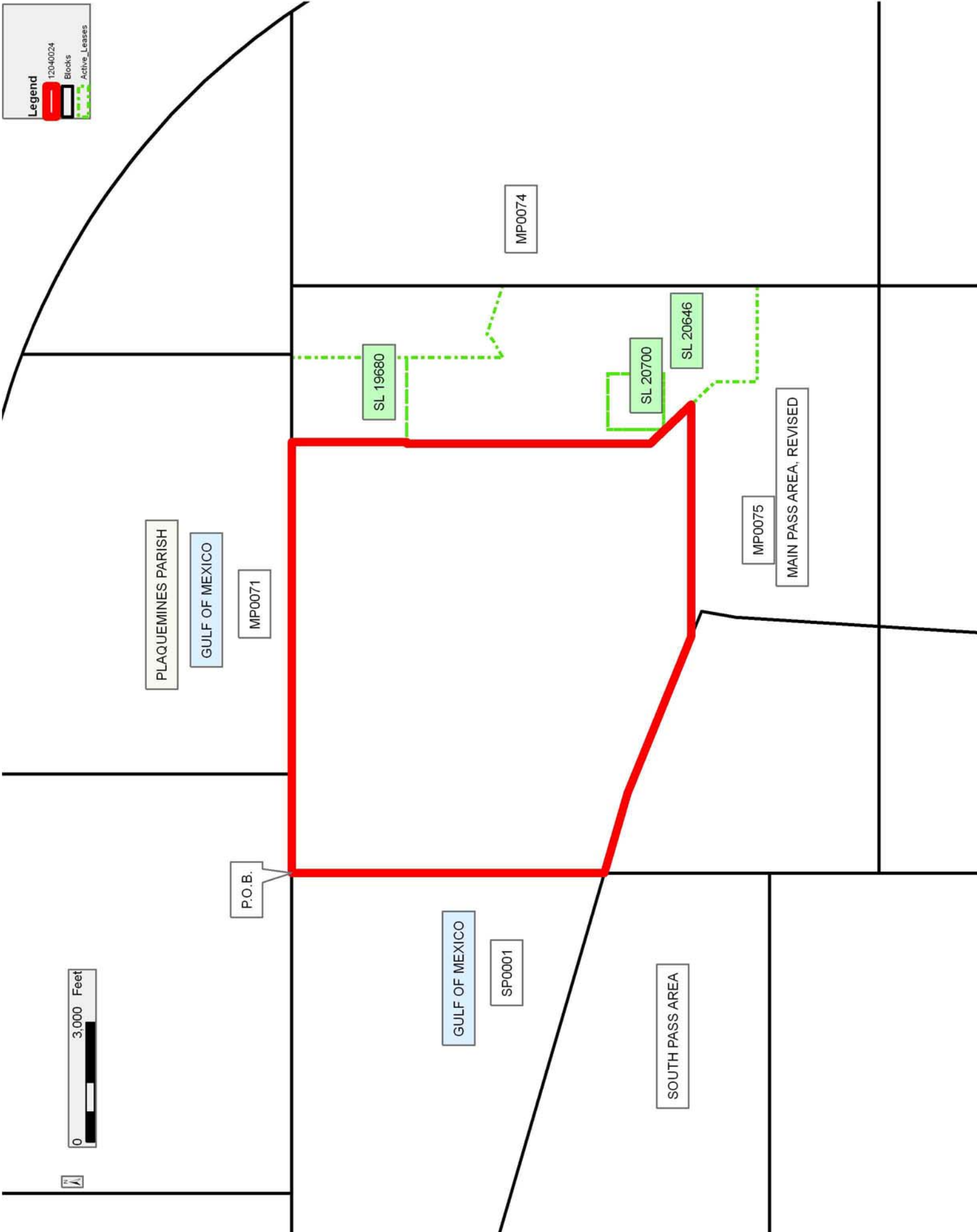

TRACT 42578 - Portion of Block 75, Main Pass Area, Revised, Plaquemines Parish, Louisiana

The beds and bottoms of all water bodies belonging to the State of Louisiana located in Block 75, Main Pass Area, Revised, together with any present lands formed by accretion to the shoreline or islands formed therein, located in Plaquemines Parish, Louisiana, owned by and not presently under mineral lease as of April 11, 2012, from the State of Louisiana, the geographical area of which is more fully described as follows: Beginning at a point being the Northeast corner of Block 75, Main Pass Area, Revised having Coordinates of X = 2,763,508.00 and Y = 214,972.00; thence South 5,302.29 feet along the Eastern boundary of said Block 75, to a point being the Easternmost Northeast corner of State Lease No. 20646 having Coordinates of X = 2,763,508.00 and Y = 209,669.71; thence along the boundary of said State Lease No. 20646 the following courses: North 71 degrees 45 minutes 32 seconds West 1279.88 feet to a point having Coordinates of X = 2,762,292.44 and Y = 210,070.33; South 46 degrees 53 minutes 26 seconds West 252.08 feet to a point having Coordinates of X = 2,762,108.41 and Y = 209,898.06; South 60 degrees 44 minutes 06 seconds West 458.99 feet to a point having Coordinates of X = 2,761,708.00 and Y = 209,673.69; and North 2,404.50 feet to its Northernmost Northeast corner having Coordinates of X = 2,761,708.00 and Y = 212,078.19, said point also being the Southeast corner of said State Lease No. 19680; thence North 2,893.81 feet along the Eastern boundary of said State Lease No. 19680 to its Northeast corner having Coordinates of X = 2,761,708.00 and Y = 214,972.00, said point being on the Northern boundary of said Block 75; thence East 1,800.00 feet along the Northern boundary of said Block 75, to the point of beginning, containing approximately **211.12 acres**, all as more particularly outlined on a plat on file in the Office of Mineral Resources, Department of Natural Resources. All bearings, distances and coordinates are based on Louisiana Coordinate System of 1927, (North or South Zone).

NOTE: The above description of the Tract nominated for lease has been provided and corrected, where required, exclusively by the nomination party. Any mineral lease selected from this Tract and awarded by the Louisiana State Mineral and Energy Board shall be without warranty of any kind, either express, implied, or statutory, including, but not limited to, the implied warranties of merchantability and fitness for a particular purpose. Should the mineral lease awarded by the Louisiana State Mineral and Energy Board be subsequently modified, cancelled or abrogated due to the existence of conflicting leases, operating agreements, private claims or other future obligations or conditions which may affect all or any portion of the leased Tract, it shall not relieve the Lessee of the obligation to pay any bonus due thereon to the Louisiana State Mineral and Energy Board, nor shall the Louisiana State Mineral and Energy Board be obligated to refund any consideration paid by the Lessor prior to such modification, cancellation, or abrogation, including, but not limited to, bonuses, rentals and royalties.

NOTE: The State of Louisiana does hereby reserve, and this lease shall be subject to, the imprescriptible right of surface use in the nature of a servitude in favor of the Department of Natural Resources, including its Offices and Commissions, for the sole purpose of implementing, constructing, servicing and maintaining approved coastal zone management and/or restoration projects. Utilization of any and all rights derived under this lease by the mineral lessee, its agents, successors or assigns, shall not interfere with nor hinder the reasonable surface use by the Department of Natural Resources, its Offices or Commissions, as herein above reserved.

Applicant: OIL & GAS SPECIALISTS, INC.

Bidder	Cash Payment	Price/Acre	Rental	Oil	Gas	Other

Legend

- 12040026
- Blocks
- Active_Leases

