

TRACT 42704 - Assumption Parish, Louisiana

All lands, including lands now or formerly constituting the beds and bottoms of all water bodies of every nature and description, owned by and not presently under mineral lease as of May 9, 2012 from the State of Louisiana, situated in Assumption Parish, Louisiana, and being more fully described as follows: All those portions of lots 9, and 10, Section 14, Township 12 South, Range 12 East, Assumption Parish lying within the following described tract, beginning at a point having Coordinates of X = 2,034,910.00 and Y = 491,560.00; thence East 500.00 feet to a point having Coordinates of X = 2,035,410.00 and Y = 491,560.00; thence South 600.00 feet to a point having Coordinates of X = 2,035,410.00 and Y = 490,960.00; thence West 500.00 feet to a point having Coordinates 2,034,910.00 and Y = 490,960.00; thence North 600.00 feet to the point of beginning, containing approximately **1.08 acres**, all as more particularly outlined on a plat on file in the Office of Mineral Resources, Department of Natural Resources. All bearings, distances and coordinates are based on Louisiana Coordinate System of 1927, (North or South Zone), where applicable.

NOTE: The above description of the Tract nominated for lease has been provided and corrected, where required, exclusively by the nomination party. Any mineral lease selected from this Tract and awarded by the Louisiana State Mineral and Energy Board shall be without warranty of any kind, either express, implied, or statutory, including, but not limited to, the implied warranties of merchantability and fitness for a particular purpose. Should the mineral lease awarded by the Louisiana State Mineral and Energy Board be subsequently modified, cancelled or abrogated due to the existence of conflicting leases, operating agreements, private claims or other future obligations or conditions which may affect all or any portion of the leased Tract, it shall not relieve the Lessee of the obligation to pay any bonus due thereon to the Louisiana State Mineral and Energy Board, nor shall the Louisiana State Mineral and Energy Board be obligated to refund any consideration paid by the Lessor prior to such modification, cancellation, or abrogation, including, but not limited to, bonuses, rentals and royalties.

NOTE: This lease shall be for a primary term of five (5) years.

Applicant: THEOPHILUS OIL, GAS & LAND SERVICES, LLC

Bidder	Cash Payment	Price/Acre	Rental	Oil	Gas	Other

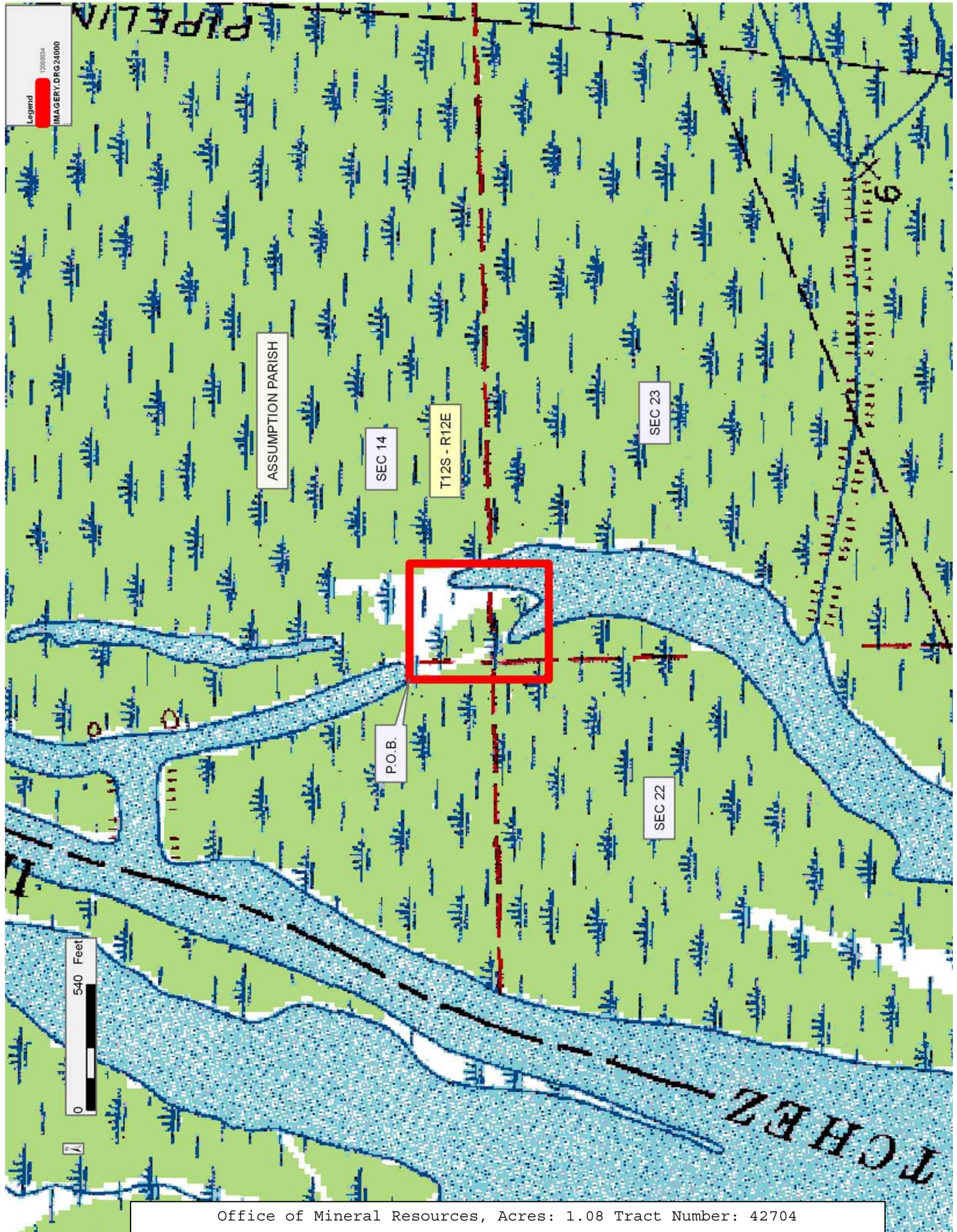

Legend
0250004
IMAGERY.DRG 24000

ASSUMPTION PARISH

SEC 14

T12S - R12E

SEC 23



P.O.B.

SEC 22

0 540 Feet



TRACT 42705 - Assumption and Iberia Parishes, Louisiana

All lands, including lands now or formerly constituting the beds and bottoms of all water bodies of every nature and description, owned by and not presently under mineral lease as of May 9, 2012 from the State of Louisiana, situated in Assumption and Iberia Parishes, Louisiana, and being more fully described as follows: All those portions of lots 1, 2, 3, 4, and 5, Section 22, Township 12 South, Range 12 East, Assumption Parish lying within the following described tract, beginning at a point having Coordinates of X = 2,031,750.00 and Y = 491,210.00; thence East 3,310.00 feet to a point having Coordinates of X = 2,035,060.00 and Y = 491,210.00; thence South 5,000.00 feet to a point having Coordinates of X = 2,035,060.00 and Y = 486,210.00; thence West 3,310.00 feet to a point having Coordinates 2,031,750.00 and Y = 486,210.00; thence North 5,000.00 feet to the point of beginning, containing approximately **97.15 acres**, all as more particularly outlined on a plat on file in the Office of Mineral Resources, Department of Natural Resources. All bearings, distances and coordinates are based on Louisiana Coordinate System of 1927, (North or South Zone), where applicable.

NOTE: The above description of the Tract nominated for lease has been provided and corrected, where required, exclusively by the nomination party. Any mineral lease selected from this Tract and awarded by the Louisiana State Mineral and Energy Board shall be without warranty of any kind, either express, implied, or statutory, including, but not limited to, the implied warranties of merchantability and fitness for a particular purpose. Should the mineral lease awarded by the Louisiana State Mineral and Energy Board be subsequently modified, cancelled or abrogated due to the existence of conflicting leases, operating agreements, private claims or other future obligations or conditions which may affect all or any portion of the leased Tract, it shall not relieve the Lessee of the obligation to pay any bonus due thereon to the Louisiana State Mineral and Energy Board, nor shall the Louisiana State Mineral and Energy Board be obligated to refund any consideration paid by the Lessor prior to such modification, cancellation, or abrogation, including, but not limited to, bonuses, rentals and royalties.

NOTE: This lease shall be for a primary term of five (5) years.

Bidder	Cash Payment	Price/Acre	Rental	Oil	Gas	Other

Applicant: THEOPHILUS OIL, GAS & LAND SERVICES, LLC

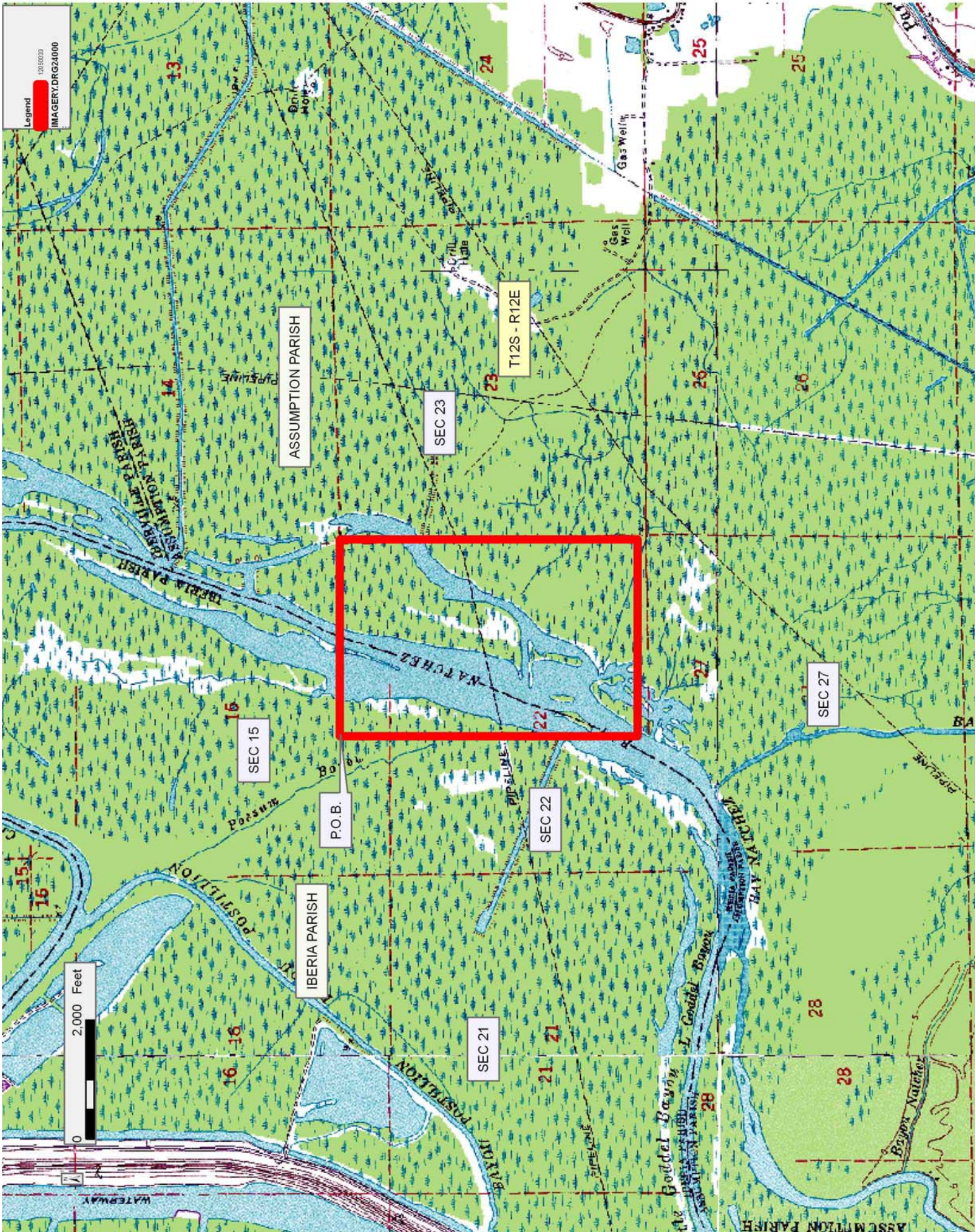

Office of Mineral Resources, Acres: 97.15 Tract Number: 42705

TRACT 42706 - Assumption Parish, Louisiana

All lands, including lands now or formerly constituting the beds and bottoms of all water bodies of every nature and description, owned by and not presently under mineral lease as of May 9, 2012 from the State of Louisiana, situated in Assumption Parish, Louisiana, and being more fully described as follows: All those portions of lots 8 and 9, Section 23, Township 12 South, Range 12 East, Assumption Parish lying within the following described tract, beginning at a point having Coordinates of X = 2,034,910.00 and Y = 491,210.00; thence East 500.00 feet to a point having Coordinates of X = 2,035,410.00 and Y = 491,210.00; thence South 1,000.00 feet to a point having Coordinates of X = 2,035,410.00 and Y = 490,210.00; thence West 500.00 feet to a point having Coordinates 2,034,910.00 and Y = 490,210.00; thence North 1,000.00 feet to the point of beginning, containing approximately **2.08 acres**, all as more particularly outlined on a plat on file in the Office of Mineral Resources, Department of Natural Resources. All bearings, distances and coordinates are based on Louisiana Coordinate System of 1927, (North or South Zone), where applicable.

NOTE: The above description of the Tract nominated for lease has been provided and corrected, where required, exclusively by the nomination party. Any mineral lease selected from this Tract and awarded by the Louisiana State Mineral and Energy Board shall be without warranty of any kind, either express, implied, or statutory, including, but not limited to, the implied warranties of merchantability and fitness for a particular purpose. Should the mineral lease awarded by the Louisiana State Mineral and Energy Board be subsequently modified, cancelled or abrogated due to the existence of conflicting leases, operating agreements, private claims or other future obligations or conditions which may affect all or any portion of the leased Tract, it shall not relieve the Lessee of the obligation to pay any bonus due thereon to the Louisiana State Mineral and Energy Board, nor shall the Louisiana State Mineral and Energy Board be obligated to refund any consideration paid by the Lessor prior to such modification, cancellation, or abrogation, including, but not limited to, bonuses, rentals and royalties.

NOTE: This lease shall be for a primary term of five (5) years.

Bidder	Cash Payment	Price/Acre	Rental	Oil	Gas	Other

Applicant: THEOPHILUS OIL, GAS & LAND SERVICES, LLC

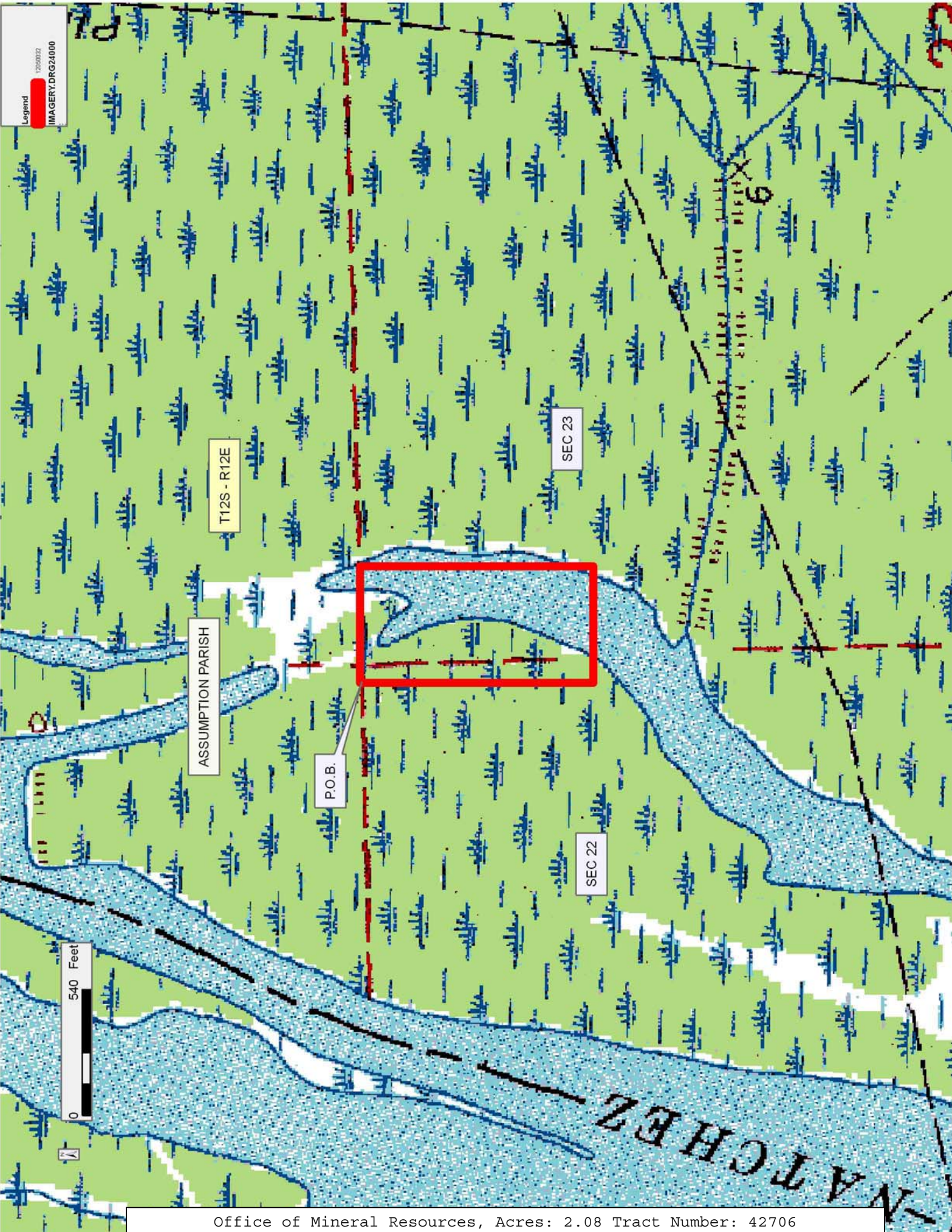

Legend
03/20/2022
IMAGERY.DRG24000

T12S - R12E

SEC 23

ASSUMPTION PARISH

P.O.B.

SEC 22

0 540 Feet

INATCHEE

TRACT 42707 - St. Martin Parish, Louisiana

All lands, including lands now or formerly constituting the beds and bottoms of all water bodies of every nature and description, owned by and not presently under mineral lease as of May 9, 2012 from the State of Louisiana, situated in St. Martin Parish, Louisiana, and being more fully described as follows: Fractional Northeast Quarter (NE/4) of the Northeast Quarter of the (NE/4) of Section 24, Township 13 South, Range 11 East, St. Martin Parish, Louisiana, containing approximately **1.13 acres**, all as more particularly outlined on a plat on file in the Office of Mineral Resources, Department of Natural Resources. All bearings, distances and coordinates are based on Louisiana Coordinate System of 1927, (North or South Zone), where applicable.

NOTE: The above description of the Tract nominated for lease has been provided and corrected, where required, exclusively by the nomination party. Any mineral lease selected from this Tract and awarded by the Louisiana State Mineral and Energy Board shall be without warranty of any kind, either express, implied, or statutory, including, but not limited to, the implied warranties of merchantability and fitness for a particular purpose. Should the mineral lease awarded by the Louisiana State Mineral and Energy Board be subsequently modified, cancelled or abrogated due to the existence of conflicting leases, operating agreements, private claims or other future obligations or conditions which may affect all or any portion of the leased Tract, it shall not relieve the Lessee of the obligation to pay any bonus due thereon to the Louisiana State Mineral and Energy Board, nor shall the Louisiana State Mineral and Energy Board be obligated to refund any consideration paid by the Lessor prior to such modification, cancellation, or abrogation, including, but not limited to, bonuses, rentals and royalties.

NOTE: This acreage is entirely within the boundary of the Atchafalaya Basin Legal area.

NOTE: This lease shall be for a primary term of five (5) years.

Applicant: THEOPHILUS OIL, GAS & LAND SERVICES, LLC

Bidder	Cash Payment	Price/Acre	Rental	Oil	Gas	Other

Legend

12050035

IMAGERY.DRG24000

0 500 Feet

ST MARTIN PARISH

SEC 13

SEC 18

T13S - R12E

SEC 19

SEC 24

CANAL